

# WASH BASIN

## WT600C-7

Single wash basin for wall mounting, stainless steel, surface satin finished, material thickness 1 mm (19 gauge), seamless welded bowl with diameter 550x350x145 mm, rectangular shape, 90 mm tap ledge, front panel with 45° corner edges, prewelded mounting brackets, mounting conform EN 32, incl. screws and dowels.

Wheelchair accessible - Meets ADA (Americans with disabilities act guidelines) and ANSI A117.1 (Accessible and usable buildings and facilities). Check local codes to ensure compliance.

Optional shroud also available (refer to specification page WT-RS)

Custom hole drilling, specify when ordering, no overflow, accepts 1 1/4" (32mm) waste - not included.

### MODEL OPTIONS

WT600C-7, Custom (non returnable), specify hole drilling

WT600C-7/1, 1 hole 1 3/8" (35mm)

### TECHNICAL DATA

Gross weight	5 kg
Type of mounting	wall mounting
Waste size	DN 32
Faucet ledge	yes
Bowl shape	rectangle
Waste hole position	centre back
Waste hole projection	8 1/4" (210 mm)
Rear upstand	no
Overflow	no

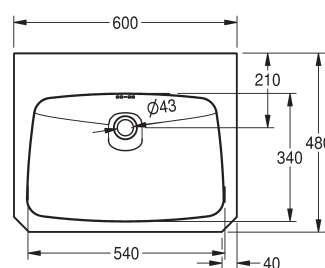
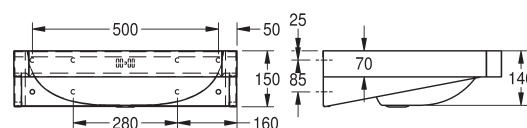

Franke Commercial Systems  
ws-info.ca@franke.com  
www.franke-commercial.com

2014-02-26, Franke CS