



## SHOP DRAWING REVIEW

200 KING ST. W., SUITE 310, TORONTO, ON CANADA M5H 3T4  
E tmp@tmp.toronto.com | P 416-499-8000

BPA			
Reviewed by:		Jeet Sandhu	
In:	5 August 2025	Out:	8 August 2025
Reviewed:		<input type="checkbox"/>	
Reviewed With Comments:		<input checked="" type="checkbox"/>	
Not Acceptable, Resubmit		<input type="checkbox"/>	
Reviewed for General Arrangement only and subject to any revisions shown. Material, workmanship, dimensions, field clearances & design shall be in accordance with the requirements of the Contract Documents.			

PROJECT:	BMO Heartland TC
PROJECT NUMBER:	25-1029-000
SHOP DRAWING NAME:	Split A/C Unit SAC-1/CU-1
SUPPLIER/MANUFACTURER:	Daikin
SUBMITTAL NO:	

### 1.0 Split A/C Unit SAC-1/CU-1 – Reviewed with Comments.

- .1 Mechanical contractor to coordinate installation of evaporator and condenser with electrical, controls, mechanical wiring, roofing and applicable trades as applicable.
- .2 Mechanical contractor to comply withal items as per SAC-1/CU-1 schedule notes BPA drawing M0-001.



# Submittal

Submittal Number: 017

Revision Number: 00

**Due Date:** Aug 6, 2025

## O.N. Site Construction Inc.

2861 Sherwood Heights Drive

Unit 40

Oakville, ON L6J 7K1

## Job Details:

5800 Mavis Road

Mississauga, ON L5V 3B7

17.001

## Submit To:

Kearns Mancini Architects

Kearns Mancini Architects

67 Mowat Avenue

Suite 432

Toronto, ON M6K 3E3

416-538-5666

*Project: E25/0210 - BMO Heartland TC Renovation*

*Vendor: Con-Sult Mechanical Inc.*

Reference #	Item #	Description/Manufacturer	Qty	Item Spec - Drawing Ref
15.003	01	HVAC Shop Drawing - Package 2	1	Mechanical

Comments:

O.N. Site Construction INC. Shop Drawing Review	
<input type="checkbox"/> REVIEWED	<u>July 31, 2025</u>
<input type="checkbox"/> REVIEWED AS NOTED	Date Reviewed:
<input type="checkbox"/> REVISE & RESUBMIT	<u>Marc Gibbons</u>
<input type="checkbox"/> REJECTED.	Reviewed By:
<small>This review is for the sole purpose of ascertaining conformance with the general design concept. It does not imply approval of the detail design inherent in the shop drawings, responsibility for which shall remain with this sub-contractor, nor shall such review relieve this sub-contractor of their responsibility for errors or omissions in the shop drawings or of their responsibility for meeting all requirements of the contract documents.</small>	
<small>Responsibility for confirmation and co-relation of job site dimensions, for information pertaining solely to fabrication procedures or to techniques of construction or installation, shall remain with this contractor.</small>	



54 Audia Court, Unit 2  
Concord, ON L4K 3N5  
(905)-738-1400

## Submittal 25-039-007

PROJECT NAME	PROJECT ADDRESS	DATE SUBMITTED
BMO Heartland Town Centre 25-039	5800 Mavis Rd-Mississauga	Jul 31, 2025
TO	FROM	
Amrutha Mohan	INZAMAN KHAN	
COMPANY	COMPANY	
O.N. SITE CONSTRUCTION INC.	Consult Mechanical Inc.	
EMAIL	EMAIL	
amrutha@onsiteconstruction.ca	inzaman@consultmechanical.com	
ADDRESS	ADDRESS	
2861 Sherwood Heights Dr Unit 40 Oakville, ON L6J 7K1	54 Audia Court, Unit 2 Concord, ON L4K 3N5	

---

### Title

VRV - SAC/CU-1

---

### Description

Daikin : SAC-1/CU-1

---

### Package Items

SPEC	SUBSECTION	ITEM	TYPE
------	------------	------	------

**Submittal # 91115****APPROVAL REQUIRED**

**Project** 22505025-MECH-1- BMO Heartland TC - 5800 Mavis Rd, Mississauga  
**Leader** Rohan Syal  
**Job Site** BMO Heartland TC - 5800 Mavis Rd, Mississauga  
**Submission Date** 2025-07-30  
**Sold To** CONSULT MECH  
**Submitted By** Rohan Syal

**Contacts**

Role	Customer	Our Rep
Project Manager	Con-Sult Mechanical Inc.*	Rohan Syal
Designer	BPA (formerly The Mitchell Partnership)	Wayne Freethy

**Deliverables**

Track #	311405	311404	311406
Tag	BAFFLE-1	LOW-1	PUMP-1
Description	Baffle	Low Ambient Kit	83809 Condensate Pump Mini AQUA 120-240V
Quantity	1	1	1
Manufacturer	Daikin Commercial	Daikin Commercial	RectorSeal Canada
Revision #	0	0	0
Track #	311402	311407	311403
Tag	SAC/CU-1	STAND-1	TSTAT-1
Description	Daikin Split System	QS Mini-Split 18" Dual Fan Std	Controls
Quantity	1	1	1
Manufacturer	Daikin Commercial	All Temp Products Co. Ltd.	Daikin Commercial
Revision #	0	0	0

**Attention:**

- 1) HTS will provide equipment in accordance with the attached shop drawings.
- 2) Upon approved submittal and customer release, HTS will release equipment to fabrication per the published lead times. Any storage fees associated with project schedule changes will be the responsibility of the purchaser.
- 3) HTS can provide freight and logistics to the purchaser as an added benefit of doing business with HTS. When freight is received by the purchaser, any noticeable damage must be recorded. Otherwise, HTS is not responsible for subsequent damage claims.

**Approval Stamps**



SUBMITTAL DATA  
APPROVAL REQUIRED



HTS Toronto  
115 Norfinch Drive  
Toronto, ON M3N 1W8  
T 416.661.3400  
F 416.661.0100  
[ontario.htseng.com](http://ontario.htseng.com)

## APPROVAL STAMPS

### Electrical Details:

Outdoor unit power: 208-230/1/60

Indoor unit power: 208-230/1/60

\*Outdoor and indoor units require separate power feeds\*

### Controls:

Indoor unit c/w wired remote controller (shipped loose for field installation)

### Condensate Pumps:

SAC-1 Indoor unit c/w condensate pumps (shipped loose for field installation)

### Filters:

SAC-1 Indoor unit c/w integral washable filters

### Condensing Unit Elevation:

Condensing units c/w support frames for 18" elevation above roof level

### Low Ambient Kit:

Low ambient wind baffle (shipped loose for field installation)

Low ambient kit for cooling operation down to -40 F

### DX Piping Details:

VRV System c/w REFNET Y Joints for refrigeration piping installation (shipped loose for field install)

Contractor to confirm pipe lengths with DXS prior to installation. Pipe measurements shown in the shop drawings are subject to change based on site conditions.

Upon installation, contractor to provide DXS with as-built piping schematic for proper calculation of field refrigerant charge.

All systems shall display appropriate Ozone Depletion Prevention (ODP) tags prior to commissioning. VRV manufacturer cannot commission any system not displaying proper ODP tag.

**Systems exceeding 5-tons require TSSA registration and inspection.**

NOTE: EQUIPMENT WILL NOT BE RELEASED FOR PRODUCTION UNTIL APPROVED SHOP DRAWINGS ARE RECEIVED BY HTS ENGINEERING. PRODUCTION TIMING AND SHIPPING INFORMATION CAN NOT BE DETERMINED UNTIL APPROVED DRAWINGS ARE RECEIVED. RETURN OF APPROVED DRAWINGS CONSTITUTES ACCEPTANCE OF THE SPECIFIED EQUIPMENT.



SUBMITTAL DATA  
APPROVAL REQUIRED



HTS Toronto  
115 Norfinch Drive  
Toronto, ON M3N 1W8  
T 416.661.3400  
F 416.661.0100  
[ontario.htseng.com](http://ontario.htseng.com)

### VRV Installation Key Points

---

1. Contractor to ensure that air cooled VRV condensing units are elevated a minimum of 18".
2. Contractor to contact DXS with any changes to pipe lengths or locations and receive revised piping & wiring diagrams which will be used for sizing pipe diameters and calculating extra refrigerant charge.
3. Contractor to confirm final location of condensing units.
4. Contractor to use clamps and installation practices which allow the pipes to expand & contract freely. Contractor to determine the use of expansion joints based on regular refrigeration practices to ensure piping does not rupture.
5. Contractor to schedule a site meeting with DXS technician prior to beginning piping installation. DXS may request to schedule a site visit to verify installation methods are in accordance with the Daikin requirements.
6. Control wiring is 18-AWG, 2 wire stranded, non-shielded for the entire system (control wiring between the fan coils & stats). No exception.
7. Contractor to pressure test system with the following procedure. 150 PSI test for 3 minutes, then 325 PSI for 3 minutes, then 550 PSI for 24 hours. Following the pressure test the system is to be vacuumed/dehydrated to 500 microns and held in a vacuum for 1 hour.
8. Contractor to insulate both suction and liquid refrigerant lines with armaflex insulation. 1/2" wall insulation for indoor piping, 3/4" wall diameter insulation for outdoor piping.
9. Refrigerant charge is to be calculated by DXS as per the actual installed pipework.
10. Condensate piping must be 3/4" ID, maximum lift noted in installation manual.



## **Schedule Compliance**

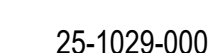

[illegible]

5800 Mavis Rd,  
Mississauga, ON L5V 3B7

## LEGEND, DRAWING LIST AND SCHEDULES

MO-001



# **Split Systems** **Piping & Wiring Diagrams**



## Split Piping Diagrams

### Piping CU-1

**NOTE: PIPING LENGTHS ARE ESTIMATES BASED ON TENDER DRAWINGS, LENGTHS AND DIAMETERS MAY CHANGE DUE TO SITE CONDITIONS**

CU-1  
RZQ18TBVJUA

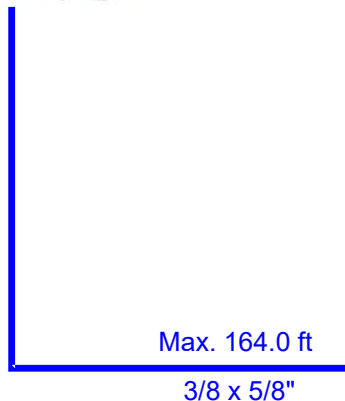

SAC-1  
FAQ18TAVJU

All piping to be as per TSSA. Contractor to provide TSSA refrigerant piping certificate B31.5 prior to commissioning by VRV manufacturer.  
All systems shall display appropriate ODP tags prior to commissioning by VRV manufacturer.  
Exposed outdoor insulation shall be protected by aluminum, sheet metal, painted canvas, plastic cover, or painted with an approved UV coating.  
Isolation valves (if shown below) shall be bi-flow self seating valves rated for R-410A with operating pressures up to 650 PSI. Brass shradar connections shall be located on valve body.  
Contractor to use clamps, expansion joints and installation practices which allows the pipes to expand and contract freely.  
All pipe lengths and sizes below are estimates. Contractor to contact VRV manufacturer prior to purchase and install of refrigerant piping to confirm actual piping lengths and sizes.

#### **Insulation:**

- For indoor piping : 1/2" wall diameter Armaflex
- For outdoor piping : 3/4" wall diameter Armaflex



## Split Wiring Diagrams

### Wiring CU-1

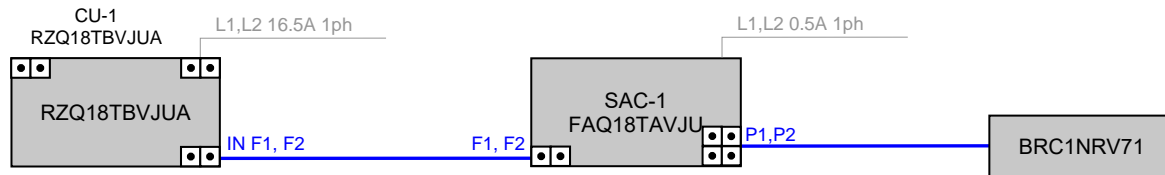

— Div 15 : Low Voltage control wiring 18 AWG 2-conductor stranded non-shielded (unless otherwise noted)

— Div 16 : Electrical power wiring

#### Notes:

- Individual disconnects are required for each piece of equipment
- Disconnect switches not provided by DXS/HTS, to be supplied and installed by others



## **Split System Technical Details**



## Daikin Split System

### Sky Air

SAC/CU-1

FAQ18TAVJU / RZQ18TBVJUA (1)



## Submittal Data Sheet

1.5-Ton Wall Mounted Heat Pump SkyAir System

FAQ18TAVJURZQ18TBVJUA

### FEATURES

- Wide angle louvers distribute comfortable airflow
- Auto-swing function ensures efficient air distribution
- Dependable heat pump operation from -4°F in heating to 122°F in cooling

### BENEFITS

- For rooms with no false ceiling nor free floor space
- Long piping lengths allow layout flexibility
- 10-year parts limited warranty for residential/commercial applications

### INDOOR UNIT



### OUTDOOR UNIT





**Submittal Data Sheet**  
1.5-Ton Wall Mounted Heat Pump SkyAir System  
FAQ18TAVJURZQ18TBVJUA

SYSTEM PERFORMANCE

Indoor Unit Model No.	FAQ18TAVJU	Indoor Unit Name:	Sky-Air Wall Mounted
Outdoor Unit Model No.	RZQ18TBVJUA	Outdoor Unit Name:	1.5-Ton, Heat Pump, SkyAir ODU
Rated Cooling Capacity (Btu/hr):	18,000	Rated Cooling Conditions:	Indoor (°F DB/WB): 80 / 67 Ambient (°F DB/WB): 95 / 75
Sensible Capacity (Btu/hr):	13,700	Rated Piping Length(ft):	25
Max/Min Cooling Capacity (Btu/hr):	/	Rated Height Difference (ft):	0.00
Cooling Input Power (kW):			
SEER2 (Non-Ducted/Ducted):	16.90 /	HSPF2 (Non-Ducted/Ducted):	7.6 /
EER2 (Non-Ducted/Ducted):	11.90 /		
Rated Heating Capacity (Btu/hr):	20,000	Rated Heating Conditions:	Indoor (°F DB/WB): 70 / 60 Ambient (°F DB/WB): 47 / 43

SYSTEM DETAILS

Refrigerant Type:	R-410A	Cooling Operation Range (°F DB):	23 - 122
Holding Refrigerant Charge (lbs):	6.4 Lb	Heating Operation Range (°F WB):	-4 - 60
Additional Charge (oz/ft):	0.04	Max. Pipe Length (Vertical) (ft):	98
Pre-charge Piping (Length) (ft):	25	Cooling Range w/Baffle (°F DB):	0 - 122
Max. Pipe Length (Total) (ft):	164		
Max Height Separation (Ind to Ind ft):	0		



## Submittal Data Sheet

### 1.5-Ton Wall Mounted Heat Pump SkyAir System

FAQ18TAVJURZQ18TBVJUA

## INDOOR UNIT DETAILS

Power Supply (V/Hz/Ph):	208-230 / 60 / 1	Airflow Rate (H/L) (CFM):	500/400
Power Supply Connections:	L1, L2, Ground	Moisture Removal (Gal/hr):	
Min. Circuit Amps MCA (A):	0.5	Gas Pipe Connection (inch):	5/8
Max Overcurrent Protection (MOP) (A):	15	Liquid Pipe Connection (inch):	3/8
Dimensions (HxWxD) (in):	11-3/8 x 41-3/8 x 9-1/4	Condensate Connection (inch):	1/2
Ext. Static Pressure (Rated/Max) (inWg):	/	Sound Pressure (H/L) (dBA):	43/37
Net Weight (lb):	31	Sound Power Level (dBA):	

## DIMENSIONAL DRAWING - INDOOR UNIT

## FAQ18-24TAVJU

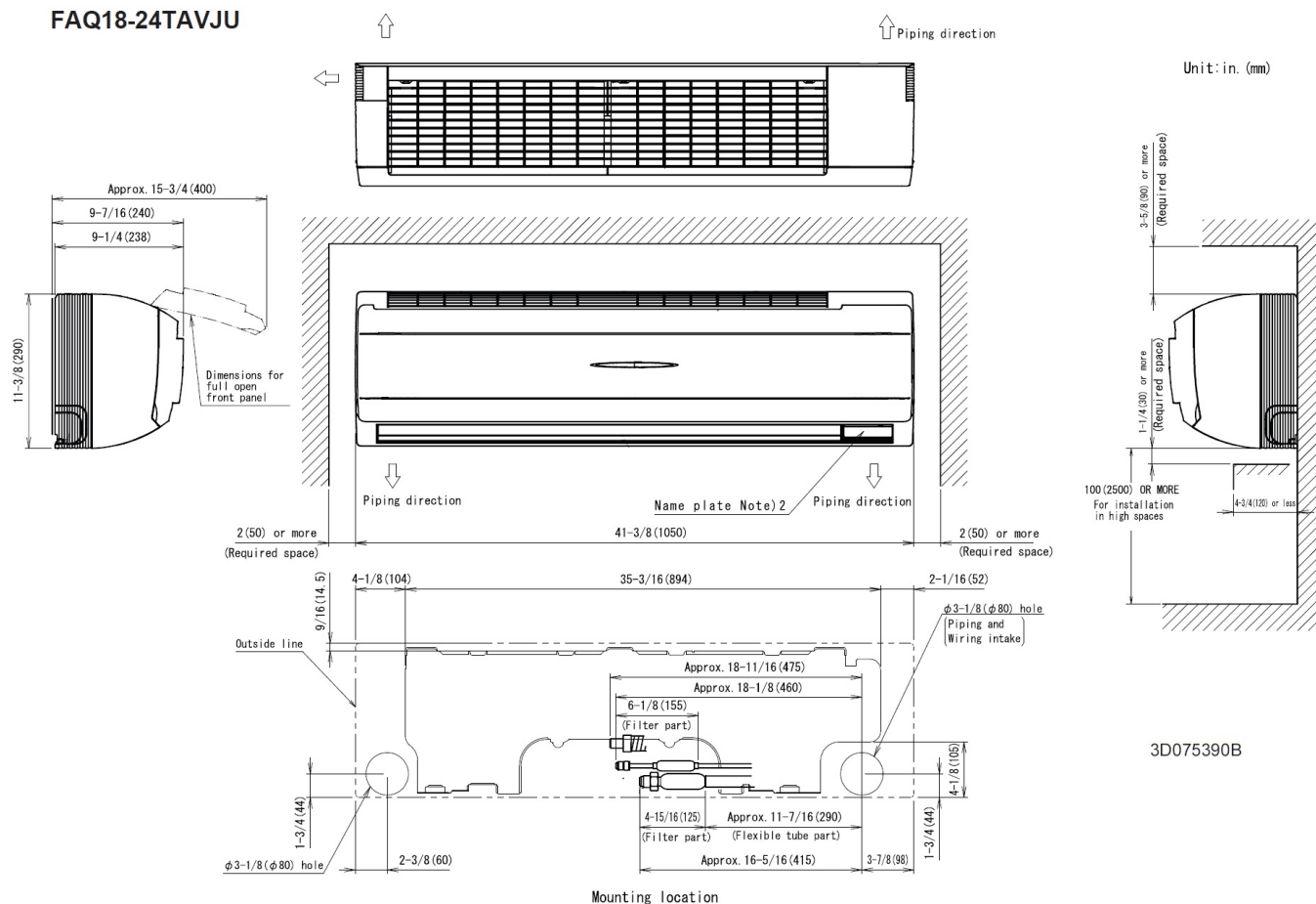



**Submittal Data Sheet**  
1.5-Ton Wall Mounted Heat Pump SkyAir System  
FAQ18TAVJURZQ18TBVJUA

**OUTDOOR UNIT DETAILS**

Power Supply (V/Hz/Ph):	208-230 / 60 / 1	Compressor Stage:	Inverter
Power Supply Connections:	L1, L2, Ground	Capacity Control Range (%):	-
Min. Circuit Amps MCA (A):	16.5	Airflow Rate (H) (CFM):	2682
Max Overcurrent Protection (MOP) (A):	20	Gas Pipe Connection (inch):	5/8
Max Starting Current MSC(A):		Liquid Pipe Connection (inch):	3/8
Rated Load Amps RLA(A):		Sound Pressure (H) (dBA):	58
Dimensions (HxWxD) (in):	39 x 37 x 12-5/8	Sound Power Level (dBA):	
Net Weight (lb):	172		

**DIMENSIONAL DRAWING - OUTDOOR UNIT**

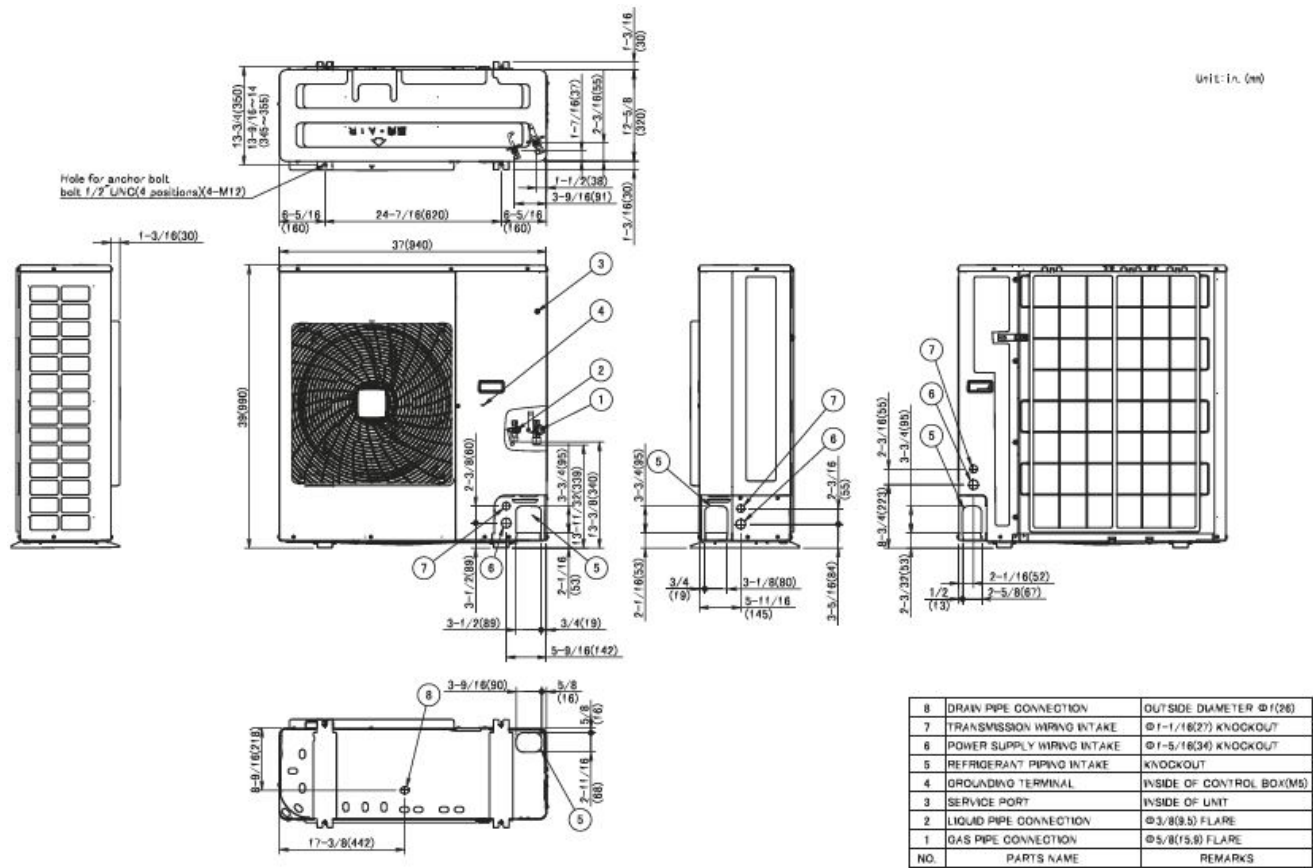



## Submittal Data Sheet

1.5-Ton Wall Mounted Heat Pump SkyAir System

FAQ18TAVJURZQ18TBVJUA

### INDOOR ACCESSORIES

PART NUMBER	DESCRIPTION	INCLUDED
-------------	-------------	----------

AZAI6WSCDKA	DKN Cloud Wi-Fi Adaptor (P1P2)	No
AZAI6WSPDKC	DKN Plus Interface	No
BRC1E73	Navigation Remote Controller III(73)	No
BRC1H71W	Madoka Remote Controller	No
BRC2A71	Simplified Wired Controller	No
BRC7E818	Wireless Remote Control Kit	No
DCS301C71	Unified On/Off Controller	No
DCS302C71	Centralized Controller	No
DCS601C71	i-Touch Controller (iTC)	No
DST301BA61	Schedule Timer	No
DTA109A51	DIII Net Expander PCB	No
DTST-ONE-ADA-A	Daikin One+ Smart Thermostat for VRV, SkyAir, Single- and Multi-Zone System	No
KJB212AA	Electrical Fixing Box	No
KJB311AA	Electrical Fixing Box	No
KRCS01-1B	Remote Sensor Kit, (FAQ, FCQ, FFQ, FHQ, FXAQ, FXDQ, FXHQ, FXLQ, FXMQ, FXNQ, FXZQ)	No
KRCSH2018-01	Button Sensor Kit	No
KRP4A71	Group Control Adaptor PCB	No



**Submittal Data Sheet**  
1.5-Ton Wall Mounted Heat Pump SkyAir System  
FAQ18TAVJURZQ18TBVJUA

OUTDOOR ACCESSORIES

PART NUMBER	DESCRIPTION	INCLUDED
DACA-WB-3	Powder-Coated Wall-Mounted Bracket	No
DGE601A71	HERO Pro Edge	No
KEHJ5A160E	230v single phase pan heater	No
KPS00301	Front Snowhood assy for Single Fan	No
KPS00302	Side Snowhood assy for Single Fan	No
KPS00303	Rear Snowhood assy for Single Fan	No
KPS00344	Snow Visor for Single & Double Fan	No
KPW5G112	Air Adjustment Grille/ Wind Baffle	No
VRVQA-SH-SF	VRV and SkyAir Single Fan Snow Hood Kit	No



## **Accessories Technical Data**



## Split Accessories

NAVIGATION REMOTE CONT(73)

Wind guard

Mini Aqua Condensate Pump

Quicksling Stand

BRC1NRV71 (1)

KPW5G112 (1)

DACA-CP1-1 (1)

QSMS1802 (1)

Project Name: \_\_\_\_\_

Location: \_\_\_\_\_

Engineer: \_\_\_\_\_

Submitted to: \_\_\_\_\_

Submitted by: \_\_\_\_\_

Reference: \_\_\_\_\_

Approval: \_\_\_\_\_

Date: \_\_\_\_\_

Construction: \_\_\_\_\_

Unit #: \_\_\_\_\_

Drawing #: \_\_\_\_\_

### MODEL COMPATIBILITY:

Compatible with R-32 VRV Indoor units: FXTA, FXFA, FXMA, FXSA

Compatible with VRV and VRV LifeTM indoor unit models: FXAQ, FXDQ, FXEQ, FXFQ, FXHQ, FXLQ, FXMQ, FXMQ\_MF, FXNQ,

FXSQ, FXTQ, FXUQ, FXZQ, VAM, CXTQ

Compatible with SkyAir indoor unit models: FAQ, FBQ, FCQ, FHQ, FTQ

Compatible with Single and Multi-zone system indoor unit model: FFQ, FDMQ

### SPECIFICATIONS:

<b>Model</b>	BRC1NRV71
<b>Description</b>	Navigation Remote Controller
<b>Maximum Connections</b>	16 indoor units
<b>Communication Wire</b>	18AWG-2, No polarity Stranded, Non-shielded
<b>Total Wiring Length</b>	1,640 ft. (500 m)
<b>Communication Protocol</b>	Daikin proprietary P1P2 protocol
<b>Power</b>	16VDC supplied by indoor unit (1.58VA maximum)
<b>Comfort Setpoint Range</b>	60 to 90 °F (16 to 32 °C)
<b>Setback Setpoint Range</b>	40 to 95 °F (5 to 35°C)
<b>Operating Temp Range</b>	14 to 122°F (-10 to 50°C)
<b>Operating Humidity Range</b>	75% or less (RH) (without condensation)
<b>Dimensions (WxHxD)</b>	4.72x4.72x0.75 inch (120x120x19 mm)
<b>Weight (Mass)</b>	0.42 lbs. (0.19 kg)

### PRODUCT IMAGE:



Notes:

- (1) 1 of 3 display options – Detailed display shown

### FEATURES:

- Up to 16 indoor units are controllable within one group
- Within one group, up to 2 Navigation Remote Controllers can be used, one as a main and one as a sub
- Backlit LCD displays in English, Spanish or French
- Temperature sensor built-in with configurable offset
- Display of Temperature and Setpoint in 1°F / °C increments
- Three configurable display options: Detailed, Standard and Simple
- Dual setpoints (independent cooling and heating setpoints) with configurable minimum setpoint differential or Single Setpoint (occupied period)

Daikin Comfort Technologies North America LLC, 19001 Kermier Road, Waller TX 77484

[www.daikinac.com](http://www.daikinac.com) [www.daikincity.com](http://www.daikincity.com)

(Daikin's products are subject to continuous improvements. Daikin reserves the right to modify product design, specifications and information in this data sheet without notice and without incurring any obligations)

Project Name: \_\_\_\_\_

Location: \_\_\_\_\_

Engineer: \_\_\_\_\_

Submitted to: \_\_\_\_\_

Submitted by: \_\_\_\_\_

Reference: \_\_\_\_\_

Approval: \_\_\_\_\_

Date: \_\_\_\_\_

Construction: \_\_\_\_\_

Unit #: \_\_\_\_\_

Drawing #: \_\_\_\_\_

8. Setpoint range limit for cooling and heating modes
9. Independent cooling and heating setback setpoints (unoccupied period)
10. Auto changeover control with configurable primary and secondary changeover dead bands and guard timer
11. Airflow – Individual air flow direction, dual airflow and auto draft prevention (prevents air blowing directly on occupants)\*
12. Built-in 7 days, weekdays+weekend, weekdays+Sat+Sun, and Everyday schedules with up to 5 actions per day with independent cooling and heating or setback setpoints
13. Automatic Setback by occupancy sensor\*
14. Automatic Off by occupancy sensor\*
15. Configuration for Self-cleaning filter panel\*
16. Automatic adjustment for Daylight Savings Time (DST)
17. 48 hour clock/calendar battery backup (protects schedule timing in cases of short term power loss from indoor unit)
18. Real-time monitoring of system malfunctions with immediate display of unit in error and error code
19. The buttons on the remote controller are selectable by locking out the unwanted buttons
20. The operation modes can be restricted to provide only the desired mode(s) of operation
21. Display can be configured to show "Off" and room temperature only when indoor unit is turned off
22. To prevent unwanted changes, fan speed selection and display may be hidden
23. Override timer configurable in 10 minute increments (range 30-10 hours)
24. Enhanced error monitoring for R32 VRV Indoor units
25. Supports new addressing scheme of DIV-NET

\*Requires support by indoor unit.

### SYSTEM DIAGRAM:

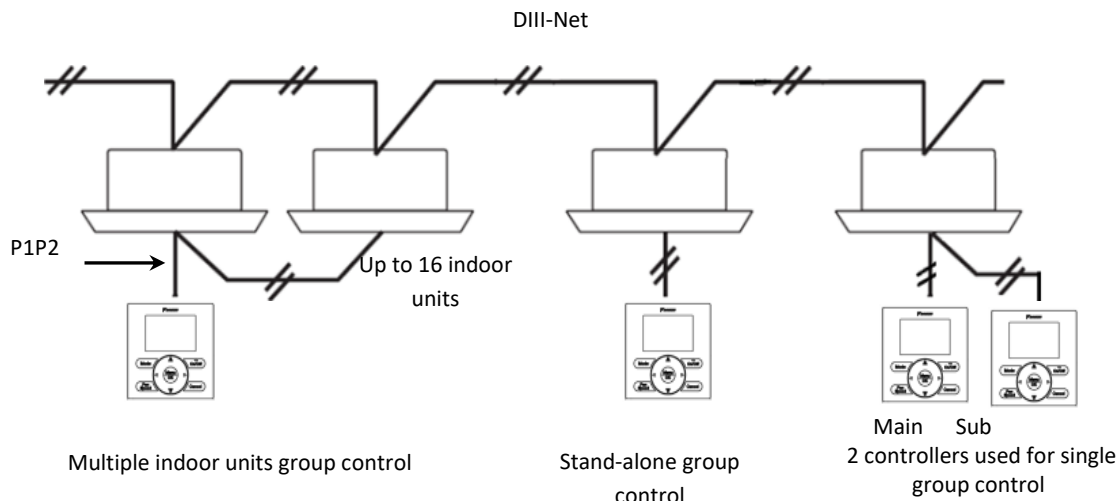

Daikin Comfort Technologies North America LLC, 19001 Kermier Road, Waller TX 77484

[www.daikinac.com](http://www.daikinac.com)   [www.daikincity.com](http://www.daikincity.com)

(Daikin's products are subject to continuous improvements. Daikin reserves the right to modify product design, specifications and information in this data sheet without notice and without incurring any obligations)



Project Name: \_\_\_\_\_

Location: \_\_\_\_\_

Engineer: \_\_\_\_\_

Submitted to: \_\_\_\_\_

Submitted by: \_\_\_\_\_

Reference: \_\_\_\_\_

Approval: \_\_\_\_\_

Date: \_\_\_\_\_

Construction: \_\_\_\_\_

Unit #: \_\_\_\_\_







Drawing #: \_\_\_\_\_

### FACE DECAL OPTIONS:

Face decal options are used to hide unnecessary buttons:

1. The face decal is designed to adhere to the faceplate
2. Hidden buttons can be accessed by service personnel without removing the face decal due to its flexibility



Used with	Single Setpoint mode			Dual Setpoint mode		
	BRC1E72RM	BRC1E72RF	BRC1E72RMF	BRC1E72RM2	BRC1E72RF2	BRC1E72RMF2
Model						
On/Off	X	X	X	X	X	X
Mode	X		X	X		X
Fan		X	X		X	X
Up, Down	X	X	X	X	X	X
Left, Right				X	X	X
Menu/Ok						
Cancel						

### DIMENSIONS:

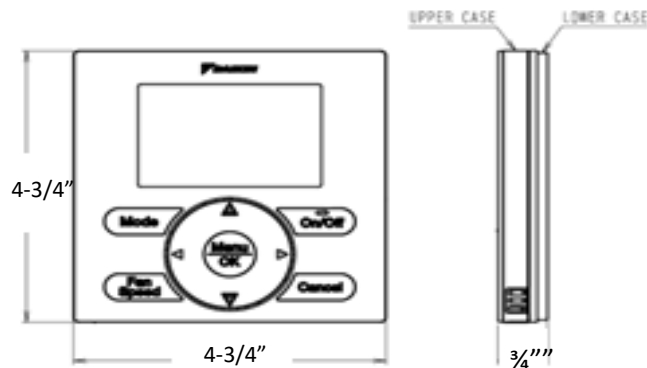

Daikin Comfort Technologies North America LLC, 19001 Kermier Road, Waller TX 77484

[www.daikinac.com](http://www.daikinac.com) [www.daikincity.com](http://www.daikincity.com)

(Daikin's products are subject to continuous improvements. Daikin reserves the right to modify product design, specifications and information in this data sheet without notice and without incurring any obligations)



# Submittal Data Sheet

## BRC1NRV71 – Navigation Remote Controller

Project Name: \_\_\_\_\_

Location: \_\_\_\_\_

Engineer: \_\_\_\_\_

Submitted to: \_\_\_\_\_

Submitted by: \_\_\_\_\_

Reference: \_\_\_\_\_

Approval: \_\_\_\_\_

Date: \_\_\_\_\_

Construction: \_\_\_\_\_

Unit #: \_\_\_\_\_

Drawing #: \_\_\_\_\_

### DOCUMENTATION:

Documentation available on [www.daikincity.com](http://www.daikincity.com) and/or [www.daikinac.com](http://www.daikinac.com):

- Installation Manual
- Operation Manual
- Submittal
- Guide Specifications

Daikin Comfort Technologies North America LLC, 19001 Kermier Road, Waller TX 77484

[www.daikinac.com](http://www.daikinac.com) [www.daikincity.com](http://www.daikincity.com)

(Daikin's products are subject to continuous improvements. Daikin reserves the right to modify product design, specifications and information in this data sheet without notice and without incurring any obligations)



## Submittal Data Sheet

Wind Baffle  
KPW5G112

## DESCRIPTION

Wind Baffle mounts over the standard air grille and allows adjustment in air blow-off direction.

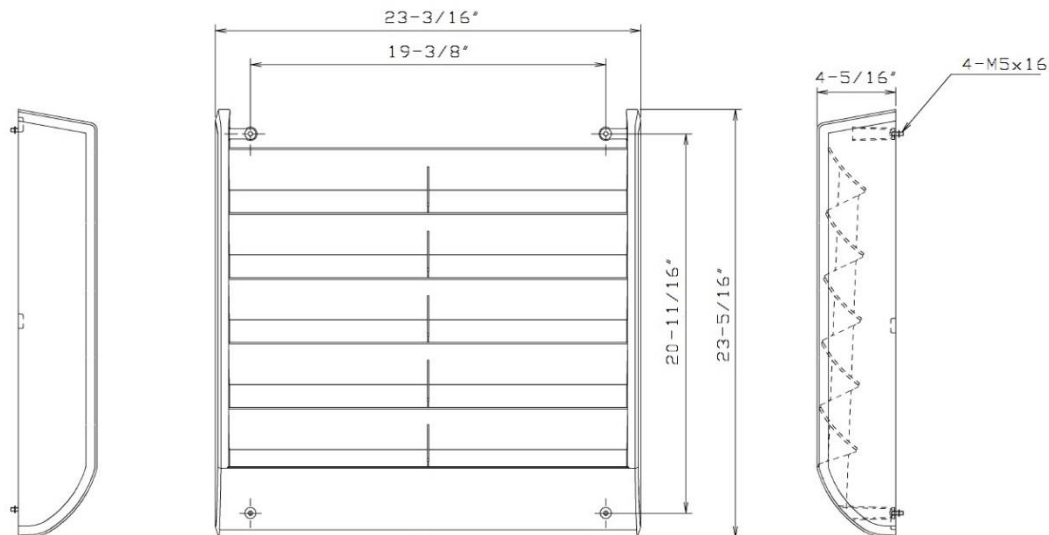

Image for REFERENCE ONLY

## SPECIFICATIONS

Model No:	KPW5G112		
Unit Compatibility:	LV 30/36	RKS30LVJU, RKS36LVJU	Qty (1)
	Sky Air	RZR18TAVJU(A), RZR24TAVJU(A), RZQ18TAVJU(A), RZQ24TAVJU(A)	Qty (1)
	VRV IV S	RXTQ36TAVJU(9)(A), RXTQ48TAVJU(A),	Qty (1)
	VRV Life	RXSQ24TAVJU(A), RXSQ36TAVJU(A), RXSQ48TAVJU(A)	Qty (1)
Unit Names:	Wind Baffle		
Dimensions (WxHxD):	23-3/16" x 23-5/16" x 4-5/16"		
Unit Weight:	3.1 (lb.)		
Material:	Flame Retardant Grade UL94V-HB		

## DIMENSIONAL DRAWINGS



Daikin North America LLC, 5151 San Felipe, Suite 500, Houston TX, 77056  
[www.daikinac.com](http://www.daikinac.com) [www.daikincomfort.com](http://www.daikincomfort.com)

(Daikin's products are subject to continuous improvements. Daikin reserves the right to modify product design, specifications and information in this data sheet without notice and without incurring any obligations).

# Submittal Data Sheet

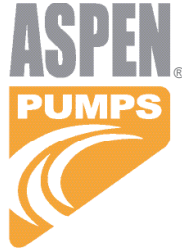

## DACA-CP1-1

Mini Univolt 100-250 Pump Kit  
DACA-CP1-1

### Project Information:

Job Name:

Location:

Engineer:

Submitted to:

For: Reference › Approval › Construction

Submitted by:

Reference:

### Submittal Information:

Approval:

Date:

Construction:

Unit #:

Drawing #:

### (Sec. I) Product Specifications:

Pump Length - 6.5fl  
Pump Width - 1.125fl  
Pump Height - 1.125fl  
Capacity - 3.2 GPH @ 0™ Head  
Max BTUs - 30000  
Max Head in Feet - 33  
Max Temperature - 104F  
Max Suction Lift - 3™.3fl  
Sound Level - 25dB(A)  
Dry Contact Rating - 3A NC  
Voltage - 100-250  
Amperes - .15 MAX  
Watts - 16  
Remote Reservoir - Y  
Plenum Rated - N  
Cable Length - 6™

Pump Selector & Wiring Diagrams Available at  
<http://www.ectorseal.com/index.php/daikin/>

### (Sec. II) Ordering Information:

Product Code - DACA-CP1-1

Model - DACA-CP1-1

Carton Qty - 1

Carton Weight - 1.5

### (Sec. III) Carton Contents:

Pump Assembly

Inline Reservoir

8flx5/8fl i.d. Inlet Tube

5™x1/4fl i.d. Vinyl Discharge Tube

Installation Manual

6flx1/4fl i.d. Vinyl Breather Tube

Drain Hose Adaptor

Inline Fuse

Cable Ties (6)

Self Adhesive Velcro

Strips (2)

Anti-siphon (1)

### (Fig. I) Product Image:



### (Fig. II) Typical Pump Locations:

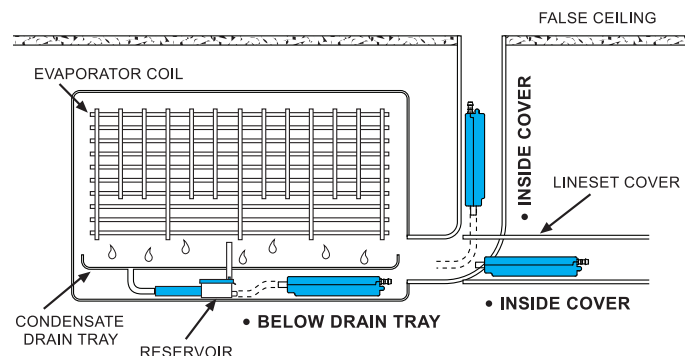

(RectorSeal™s products are subject to continuous improvements; RectorSeal reserves the right to modify product  
GHVLJQ VSHFLZFDWLRQV LQIRUPDWLRQ LQ WKLV GDWD VKHHW ZLWKRX  
ASPEN® is a registered trademark of Aspen Oldco Limited Company UK

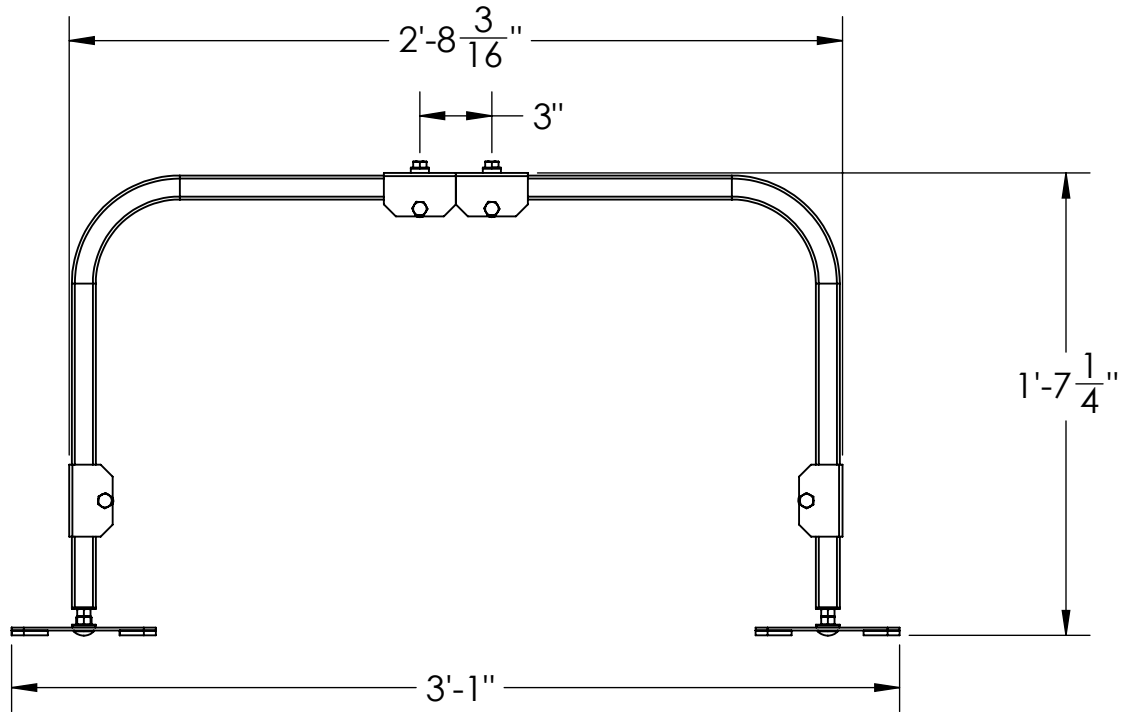

**SIDE VIEW RETRACTED**

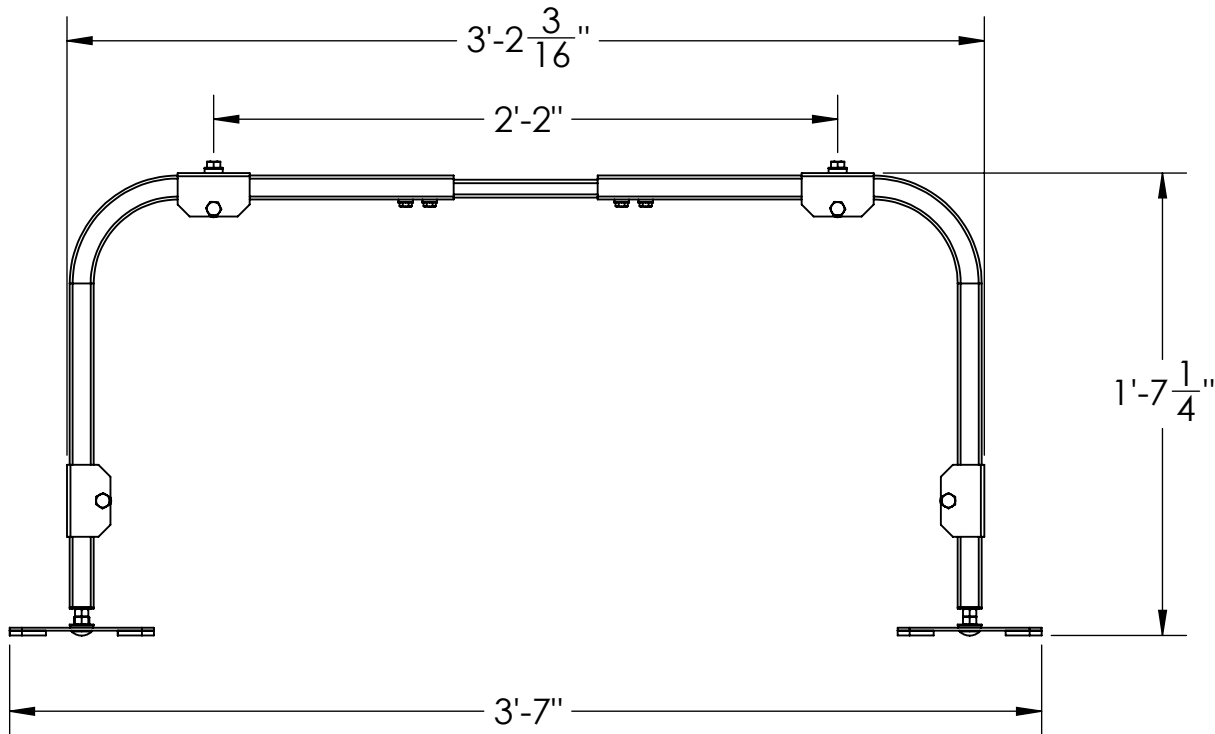

**SIDE VIEW EXPANDED**

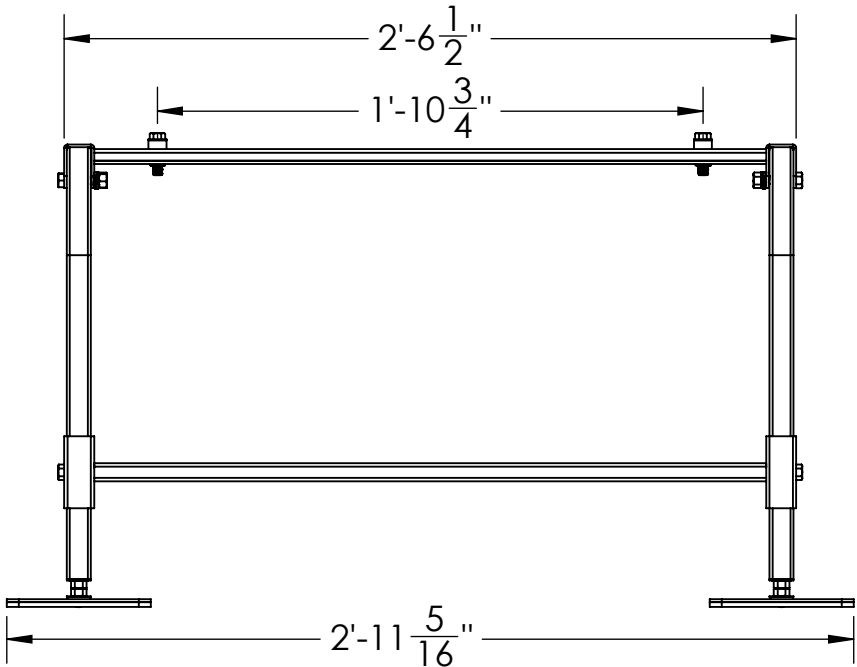

**END VIEW RETRACTED**

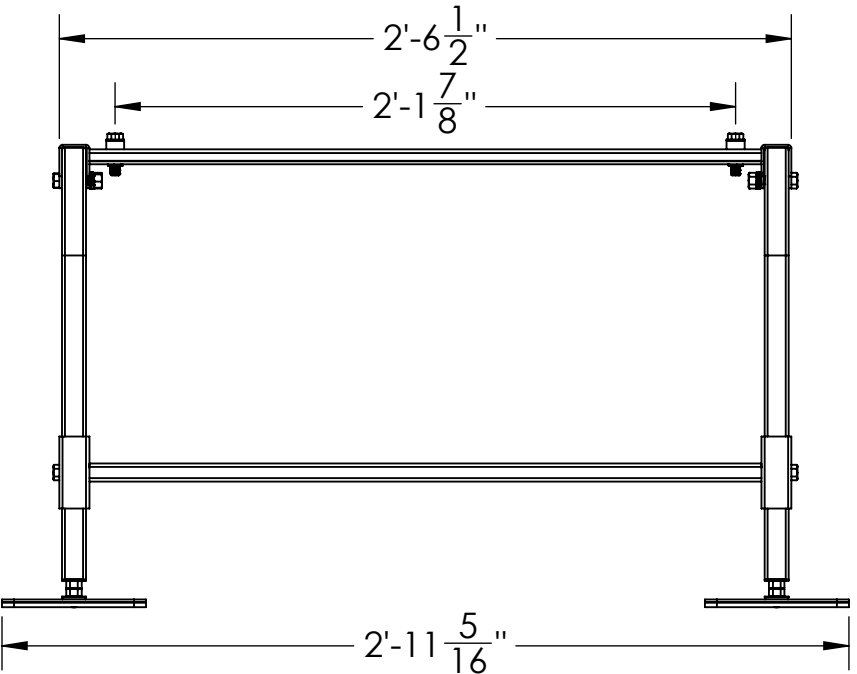

**END VIEW EXPANDED**

(\*) - WIDTH IS ADJUSTABLE IN 1" INCREMENTS

IMPORTANT NOTE: THE INSTALLER IS RESPONSIBLE FOR THETHERING AND BOLTING UNITS TO WITHSTAND WIND AND/OR SEISMIC LOADS.

UNLESS OTHERWISE SPECIFIED: DIMENSIONS ARE IN INCHES [MILLIMETERS] TOLERANCES ARE: ANGLES ±1.0° FRACTIONAL SIZES X/Y ±1/64	
INCHES	[MILLIMETERS]
.X = ±0.1	[X = ± 2.5 ]
.XX = ±0.01	[X = ± 1.3 ]
.XXX = ±0.005	[X = ±0.13 ]

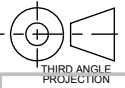

CONFIDENTIAL - PROPRIETARY - DO NOT COPY THE INFORMATION SET FORTH IN THIS DOCUMENT AND RELATED INFORMATION IS THE CONFIDENTIAL PROPERTY OF DIVERSiTECH CORPORATION, AND IS NOT TO BE COPIED OR REPRODUCED OR DISTRIBUTED IN ANY FORM WITHOUT PRIOR WRITTEN PERMISSION FROM DIVERSiTECH CORPORATION. DO NOT SCALE DRAWING DESCRIPTION	MATERIAL: DWG. NO. MINI SPLIT STAND - 1802 MODEL NO. QSMS1802	WEIGHT GMS.
		REV. <b>A</b> SHEET 1 OF 2

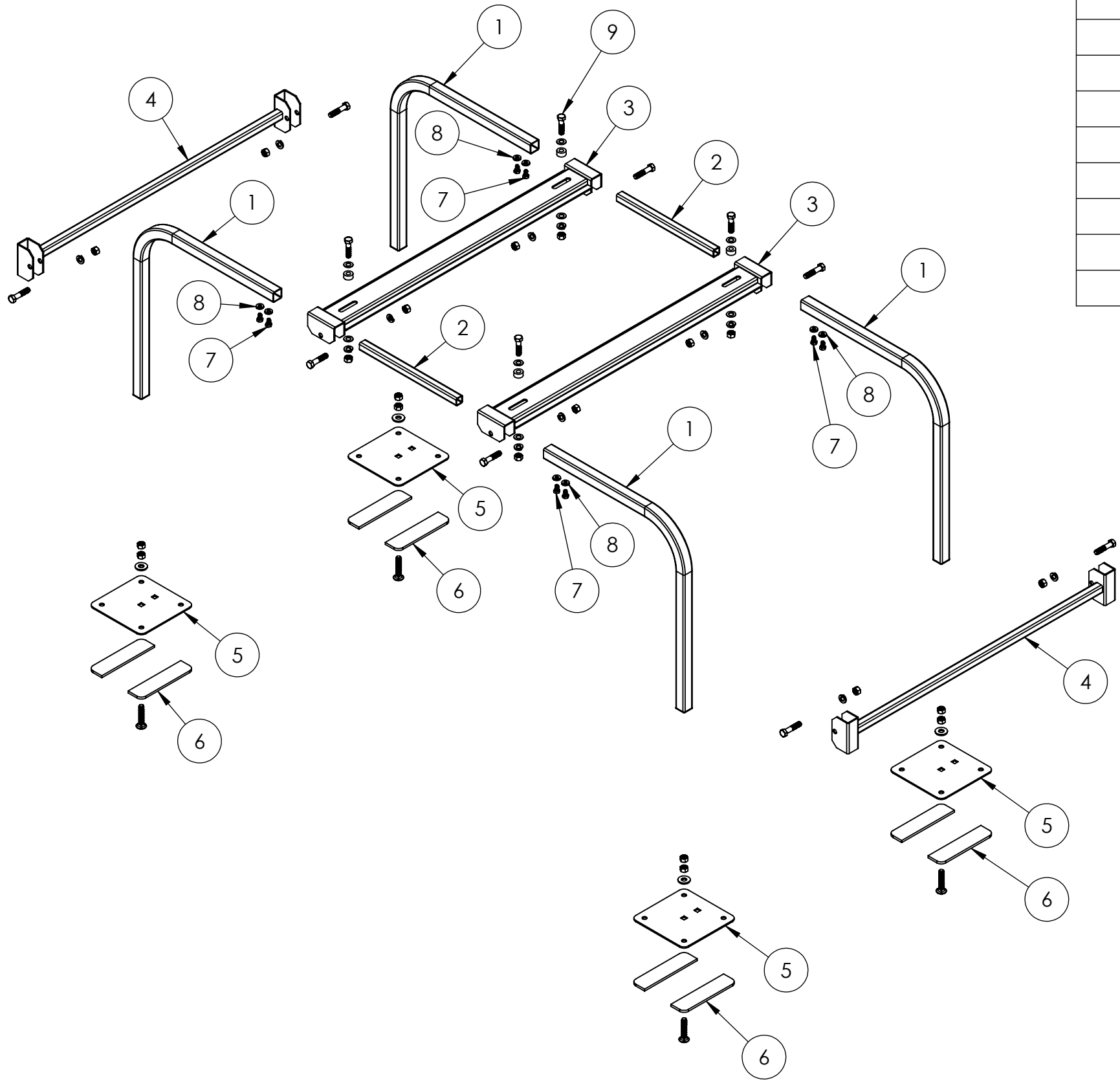

ITEM NO.	PART NUMBER	DESCRIPTION	Default/ QTY.
1	MS110	Mini Split 18in J-Bar	4
2	MS106	Mini Split Extension Bar	2
3	MS111	Long Mini Split Arm	2
4	MS115	MS Double Fan Stability Arm	2
5	MS105	Mini Split 6x6 Feet	4
6	QSR042	Mini Split Rubber Foot	8
7	QSR008	1/4-20x1/2in Zinc Hex Bolt	8
8	QSR015	1/4in Bonded Washers	8
9	HDKMS05	Hardware kit for QSMS1802, 2402	1

NOTE - ALL ASSEMBLY HARDWARE IS INCLUDED

UNLESS OTHERWISE SPECIFIED:	
DIMENSIONS ARE IN INCHES [MILLIMETERS]	
TOLERANCES ARE: ANGLES ±1.0°	
FRACTIONAL SIZES X/Y ±1/64	
INCHES	[MILLIMETERS]
.X = ±0.1	[X = ±2.5 ]
.XX = ±0.01	[X = ±1.3 ]
.XXX = ±0.005	[XX = ±0.13 ]

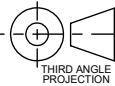

CONFIDENTIAL - PROPRIETARY - DO NOT COPY THE INFORMATION SET FORTH IN THIS DOCUMENT AND RELATED INFORMATION IS THE CONFIDENTIAL PROPERTY OF DIVERSTECH CORPORATION, AND IS NOT TO BE COPIED OR REPRODUCED OR DISTRIBUTED IN ANY FORM WITHOUT PRIOR WRITTEN PERMISSION FROM DIVERSTECH CORPORATION. DO NOT SCALE DRAWING	MATERIAL:	WEIGHT
	DWG. NO. MINI SPLIT STAND - 1802 MODEL NO. QSMS1802	GMS. REV. A
DESCRIPTION		SHEET 2 OF 2