

SHOP DRAWING REVIEW

<input type="checkbox"/>
<input type="checkbox"/>
<input checked="" type="checkbox"/>
<input type="checkbox"/>

NOT REVIEWED
REVIEWED
REVIEWED AS NOTED
REVISE AND RESUBMIT

This review by Hilditch Architect Inc. is for the sole purpose of ascertaining conformance with the general design concept features only, and does not in any way constitute review of the design of engineering elements which form part of the Contract Documents prepared by others. This review shall not mean that Hilditch Architect Inc. approves the design detail inherent in the shop drawings, responsibility for which shall remain with the Contractor submitting same, and such review shall not relieve the Contractor of his responsibility for errors or omissions in the shop drawings or of his responsibility for meeting all requirements of the Contract Documents. The Contractor is responsible for dimensions to be confirmed and correlated at the job site, for information that pertains solely to fabrication processes or to techniques of construction and installation and for co-ordination of the work of all trades.

Hilditch Architect Inc.

By: Sasha Stairs

Project No: 1809

Date Rec'd:

Date Rev'd: 2024.11.20

GC/CM: 2024.11.15

Consultant: 2024.11.19

HAI; reviewed for 45 pages total:

1. Refer to mechanical consultant comments.
2. Locations of interior units to be approved prior to completion of rough-ins on site. Units typically centred above windows or centred horizontally on walls.
3. All plumbing, wiring connections, etc. to be concealed within walls. If impossible in a location and surface mounted rough-in required, installation shall be complete with cover kit / sleeves to conceal.

Submittal No. 06-R1

Split A/C Units

Project Name:
Neshama Hospice

Owner:
Neshama

Prime Consultant:
Hilditch Architect Inc

General Contractor: Renokrew

SHOP DRAWING SUBMITTAL REVIEW	JOB NAME	Neshama Hospice
	JOB #	24-130
	DATE	Nov 15, 2024
REVIEWED	<p>This review is for general conformance of plans and specifications only. Approvals are subject to subcontractors performance within the confines of the contract documents. Review of dimensions will not serve to relieve the subcontractor of contractual responsibility for any deviation from the contract requirements.</p> <p>SPECIFICATION 23 08 10</p> <p>✓ SHOP DRAWING PRODUCT DATA DOCUMENTATION LETTER</p> <p>CHECKED BY: REVIEWED BY: JP</p> <p>TOTAL PAGES: 45</p>	
REJECTED		
REVIEW & RESUBMIT		
REVIEW AS NOTED		

SustainGlobe Ltd.

THIS DRAWING REVIEWED SOLELY FOR GENERAL CONFORMITY WITH DESIGN CONCEPTS. QUANTITIES, DETAILS, DIMENSIONS AND DESIGNS INHERENT IN THE SHOP DRAWINGS ARE THE CONTRACTOR'S RESPONSIBILITY TO VERIFY DATA WITH FIELD DIMENSIONS. CONTRACTOR IS SOLELY RESPONSIBLE FOR DESIGN OF MANUFACTURED ITEMS, FABRICATION PROCESSES AND TECHNIQUES OF CONSTRUCTION AND INSTALLATION OF EQUIPMENT.

DATE RECEIVED:

November 15, 2024

✓ **MECHANICAL**

☐ **ELECTRICAL**

☐ **OTHERS**

THIS DRAWING IS:

☐ **REVIEWED**

✓ **REVIEWED AS NOTED**

☐ **REVIEWED AND
TO BE RESUBMIT**

BY: TL

DATE: November 19, 2024

PROJ. NO.: 18031

SustainGlobe:

1. The refrigerant for all air conditioners shall be R32.



54 Audia Court, Unit 2
Concord, ON L4K 3N5
(905)-738-1400

Submittal 24-256-005

PROJECT NAME	PROJECT ADDRESS	DATE SUBMITTED
NESHAMA HOSPICE	24-256 3 Cadillac Avenue North York, ON M3H 1R9	Nov 6, 2024

TO	FROM
Taranjeet Singh	PAUL LEDDY
COMPANY	COMPANY
1568796 ONTARIO INC. C/A RENOKREW	Consult Mechanical Inc.
EMAIL	EMAIL
taranjeet@renokrew.com	paul.l@consultmechanical.com
ADDRESS	ADDRESS
43 LEPAGE COURT TORONTO, ON M3J 1Z9	54 Audia Court, Unit 2 Concord, ON L4K 3N5

Title

Daikin Split AC Units

Description

AC/CU 3,4 Daikin Model # FTXF24AXVJU / RXF24AXVJU
AC/CU 1,2 Daikin Model # FTKF12AXVJU / RKF12AXVJU
AC/CU 5 Daikin Model # FTX36WVJU9 / RK36WMVJU9 Revised

Package Items

SPEC

SUBSECTION

ITEM

TYPE

**Submittal # 83058****APPROVAL REQUIRED**

Project 22404896-MECH-1- Neshama Hospice - 3 Cadillac
Leader Nevin Wong
Job Site Neshama Hospice
Submission Date 2024-11-11
Sold To CONSULT MECH
Submitted By Rohan Syal

Contacts

Role	Customer	Our Rep
Mechanical Contractor	Con-Sult Mechanical Inc.*	Nevin Wong
Mechanical Contractor	Con-Sult Mechanical Inc.*	Nevin Wong
Designer	Sustainglobe Ltd	John Samson

Deliverables

Track #	281371	282547	281376
Tag	AC/CU-3,4, AC/CU-1,2, AC/CU-5	ADPTR-1	BAFFLE-1, BAFFLE-1
Description	Daikin Split System	BAS Adaptor	Baffle
Quantity	5	1	5
Manufacturer	Daikin Commercial	HMS Industrial Networks Inc.	Daikin Commercial
Revision #	1	0	1
Track #	281375	281373	281374
Tag	LOW-1	PUMP-1	STAND-1, STAND-1, STAND-1
Description	Low Ambient Kit	Condensate Pumps	Quicksling Stand
Quantity	3	5	5
Manufacturer	Daikin Commercial	Daikin Commercial	Daikin Commercial
Revision #	1	1	1
Track #	281372		
Tag	TSAT-2		
Description	Controls		
Quantity	4		
Manufacturer	Daikin Commercial		
Revision #	1		

Attention:

- 1) HTS will provide equipment in accordance with the attached shop drawings.
- 2) Upon approved submittal and customer release, HTS will release equipment to fabrication per the published lead times. Any storage fees associated with project schedule changes will be the responsibility of the purchaser.
- 3) HTS can provide freight and logistics to the purchaser as an added benefit of doing business with HTS. When freight is received by the purchaser, any noticeable damage must be recorded. Otherwise, HTS is not responsible for subsequent damage claims.



Approval Stamps



SUBMITTAL DATA
APPROVAL REQUIRED



HTS Toronto
115 Norfinch Drive
Toronto, ON M3N 1W8
T 416.661.3400
F 416.661.0100
ontario.htseng.com

APPROVAL STAMPS

Electrical Details:

Outdoor unit power: 208-230/1/60

Indoor unit power: 208-230/1/60

Outdoor unit powers indoor unit

Controls:

AC-1 to AC-4 indoor unit c/w wired remote controller (shipped loose for field installation)

AC-5 c/w Intesis card to enable BAS control

- Mounting and wiring by others

Condensate Pumps:

AC-1 to AC-5 Indoor units c/w condensate pumps (shipped loose for field installation)

Filters:

AC-1 to AC-5 Indoor units c/w integral washable filters

Condensing Unit Elevation:

Condensing units c/w support frames for 18" elevation above roof level

Low Ambient Kit:

CU-1/2/3/4/5 c/w low ambient wind baffle (shipped loose for field installation)

CU-1/2/5 c/w low ambient kit for cooling operation down to -40 F

DX Piping Details:

VRV System c/w REFNET Y Joints for refrigeration piping installation (shipped loose for field install)

Contractor to confirm pipe lengths with DXS prior to installation. Pipe measurements shown in the shop drawings are subject to change based on site conditions.

Upon installation, contractor to provide DXS with as-built piping schematic for proper calculation of field refrigerant charge.

All systems shall display appropriate Ozone Depletion Prevention (ODP) tags prior to commissioning. VRV manufacturer cannot commission any system not displaying proper ODP tag.

Systems exceeding 5-tons require TSSA registration and inspection.

NOTE: EQUIPMENT WILL NOT BE RELEASED FOR PRODUCTION UNTIL APPROVED SHOP DRAWINGS ARE RECEIVED BY HTS ENGINEERING. PRODUCTION TIMING AND SHIPPING INFORMATION CAN NOT BE DETERMINED UNTIL APPROVED DRAWINGS ARE RECEIVED. RETURN OF APPROVED DRAWINGS CONSTITUTES ACCEPTANCE OF THE SPECIFIED EQUIPMENT.



SUBMITTAL DATA
APPROVAL REQUIRED



HTS Toronto
115 Norfinch Drive
Toronto, ON M3N 1W8
T 416.661.3400
F 416.661.0100
ontario.htseng.com

VRV Installation Key Points

1. Contractor to ensure that air cooled VRV condensing units are elevated a minimum of 18".
2. Contractor to contact DXS with any changes to pipe lengths or locations and receive revised piping & wiring diagrams which will be used for sizing pipe diameters and calculating extra refrigerant charge.
3. Contractor to confirm final location of condensing units.
4. Contractor to use clamps and installation practices which allow the pipes to expand & contract freely. Contractor to determine the use of expansion joints based on regular refrigeration practices to ensure piping does not rupture.
5. Contractor to schedule a site meeting with DXS technician prior to beginning piping installation. DXS may request to schedule a site visit to verify installation methods are in accordance with the Daikin requirements.
6. Control wiring is 18-AWG, 2 wire stranded, non-shielded for the entire system (control wiring between the fan coils & stats). No exception.
7. Contractor to pressure test system with the following procedure. 150 PSI test for 3 minutes, then 325 PSI for 3 minutes, then 550 PSI for 24 hours. Following the pressure test the system is to be vacuumed/dehydrated to 500 microns and held in a vacuum for 1 hour.
8. Contractor to insulate both suction and liquid refrigerant lines with armaflex insulation. 1/2" wall insulation for indoor piping, 3/4" wall diameter insulation for outdoor piping.
9. Refrigerant charge is to be calculated by DXS as per the actual installed pipework.
10. Condensate piping must be 3/4" ID, maximum lift noted in installation manual.



Schedule Compliance

EQUIPMENT SCHEDULE				
NO.	EQUIPMENT	MAKE AND MODEL	DESCRIPTION	
			Model numbers updated per latest Daikin generation	
AC-1 ¹ AC-GU-1 AC-2 AC-GU-2	SPLIT A/C UNIT FOR ELEVATOR ROOM & CORN ROOM	DAIKIN MODEL FRZB28YV2S RNG2ANWJ... FTKF12AXVJU/ RKXF12AXVVJU	NOMINAL COOLING = 1 TON ✓ EVAPORATOR UNIT ✓ 17400 BTUH COOLING CAPACITY, 18 SEER, 456CFM, C/M MOUNTING BRACKET, WIRED THERMOSTAT, INTERFACE ADAPTOR FOR DPH-INET, 1" COPPER CONDENSATE DRAIN TERMINATE HUB DRAIN AND INTEGRAL CONDENSATE PUMP, DIMENSIONS = 285mm(h) x 195mm(w) x 265mm(d), HEIGHT = 10 KG ✓ CONDENSING UNIT ✓ R-32 REFRIGERANT, 208V/1φ, MAX FUSE = 15 A, M.C.A. = 198 A, DIMENSIONS = 550mm(h) x 610mm(w) x 205mm(d), HEIGHT = 34 KG, 27 COMPLETED WITH REMOTE CONTROLLER-INTERFACE ADAPTOR DPH-INETRAL BAGNET CARD TO BE CONTROLLED BY BAS, HEATERPROOF DISCONNECT FIELD SETTINGS FOR EXTENDED OPERATING RANGE UP TO -4°F, KIND BATTLE, PATIO-STONE AND RIGID-INSULATION POWER TO INDOOR UNIT SUPPLIED BY OUTDOOR UNIT.	Interface adapter not needed if BAS connection not required ✓ Condensate pump shipped loose for field installation ✓
AC-3 ¹ AC-GU-3 AC-4 AC-GU-4	SPLIT A/C UNIT FOR FAMILY/ACTIVITY ROOM	DAIKIN MODEL FRZB28YV2S RNG2MEYVB FTXF24AXVJU/ RKXF24AXVVJU	NOMINAL COOLING = 2 TON, HEATING = 25400 BTUH ✓ EVAPORATOR UNIT ✓ 24000 BTUH COOLING CAPACITY, COP = 8.8PT SEER + 12.5 SEER = 10.6, C/M MOUNTING BRACKET, WIRED THERMOSTAT, INTERFACE ADAPTOR FOR DPH-INET, 1" COPPER CONDENSATE DRAIN TERMINATE HUB DRAIN AND INTEGRAL CONDENSATE PUMP ✓ CONDENSING UNIT ✓ R-32 REFRIGERANT, 208V/1φ, MAX FUSE = 20 A, M.C.A. = 198 A, DIMENSIONS = 590mm(h) x 460mm(w) x 316mm(d), HEIGHT = 32 KG, 690mm x 933mm x 350mm, 46 KG, COMPLETED WITH REMOTE CONTROLLER-INTERFACE ADAPTOR DPH-INETRAL BAGNET CARD TO BE CONTROLLED BY BAS, HEATERPROOF DISCONNECT FIELD SETTINGS FOR EXTENDED OPERATING RANGE UP TO -4°F, KIND BATTLE, PATIO-STONE AND RIGID-INSULATION POWER TO INDOOR UNIT SUPPLIED BY OUTDOOR UNIT.	Interface adapter not needed if BAS connection not required ✓ Condensate pump shipped loose for field installation ✓ C/w Inlets card to enable BAS control. No wired thermostat needed. ✓
AC-5 ¹ AC-GU-5	SPLIT A/C UNIT FOR FAMILY/ACTIVITY ROOM	DAIKIN MODEL FRZB28YV2S RNG2ANWJ... FTX36WVJU9/ RK36WVVJU9	NOMINAL COOLING = 3 TON ✓ EVAPORATOR UNIT ✓ 33400 BTUH COOLING CAPACITY, 18 SEER, 456CFM, C/M MOUNTING BRACKET, WIRED THERMOSTAT, INTERFACE ADAPTOR FOR DPH-INET, 1" COPPER CONDENSATE DRAIN TERMINATE HUB DRAIN AND INTEGRAL CONDENSATE PUMP ✓ CONDENSING UNIT ✓ R-32 REFRIGERANT, 208V/1φ, MAX FUSE = 20 A, M.C.A. = 198 A, DIMENSIONS = 590mm(h) x 460mm(w) x 316mm(d), HEIGHT = 32 KG, 690mm x 933mm x 350mm, 46 KG, COMPLETED WITH REMOTE CONTROLLER-INTERFACE ADAPTOR DPH-INETRAL BAGNET CARD TO BE CONTROLLED BY BAS, HEATERPROOF DISCONNECT FIELD SETTINGS FOR EXTENDED OPERATING RANGE UP TO -4°F, KIND BATTLE, PATIO-STONE AND RIGID-INSULATION POWER TO INDOOR UNIT SUPPLIED BY OUTDOOR UNIT.	Interface adapter not needed if BAS connection not required ✓ Condensate pump shipped loose for field installation ✓ C/w Inlets card to enable BAS control. No wired thermostat needed. ✓



Split Systems **Piping & Wiring Diagrams**



Split Piping Diagrams

Piping CU-1/2

NOTE: PIPING LENGTHS ARE ESTIMATES BASED ON TENDER DRAWINGS, LENGTHS AND DIAMETERS MAY CHANGE DUE TO SITE CONDITIONS

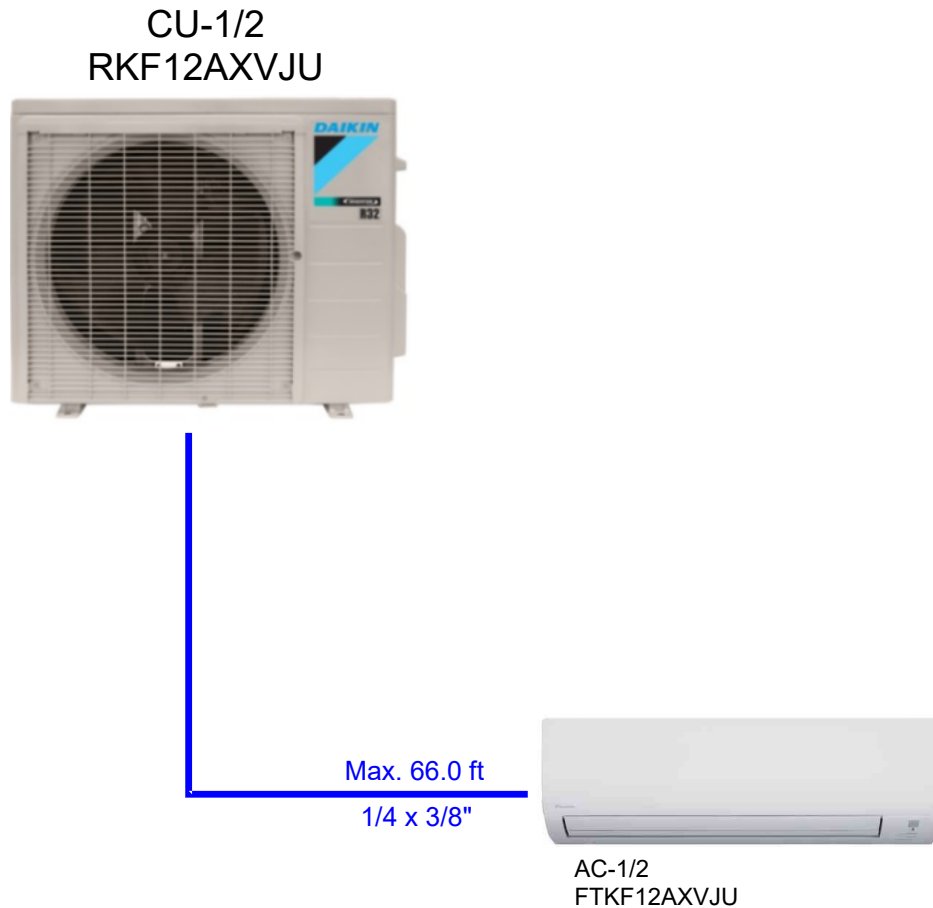

All piping to be as per TSSA. Contractor to provide TSSA refrigerant piping certificate B31.5 prior to commissioning by VRV manufacturer.
All systems shall display appropriate ODP tags prior to commissioning by VRV manufacturer.
Exposed outdoor insulation shall be protected by aluminum, sheet metal, painted canvas, plastic cover, or painted with an approved UV coating.
Isolation valves (if shown below) shall be bi-flow self seating valves rated for R-410A with operating pressures up to 650 PSI. Brass shroud connections shall be located on valve body.
Contractor to use clamps, expansion joints and installation practices which allows the pipes to expand and contract freely.
All pipe lengths and sizes below are estimates. Contractor to contact VRV manufacturer prior to purchase and install of refrigerant piping to confirm actual piping lengths and sizes.

Insulation:

- For indoor piping : 1/2" wall diameter Armaflex
- For outdoor piping : 3/4" wall diameter Armaflex

The VRV Selection application is property of Daikin Europe N.V. Daikin Europe N.V. cannot be held liable for any inaccuracy, reliability of the outcome of the VRV Selection application.



Split Piping Diagrams

Piping CU-3/4

NOTE: PIPING LENGTHS ARE ESTIMATES BASED ON TENDER DRAWINGS, LENGTHS AND DIAMETERS MAY CHANGE DUE TO SITE CONDITIONS

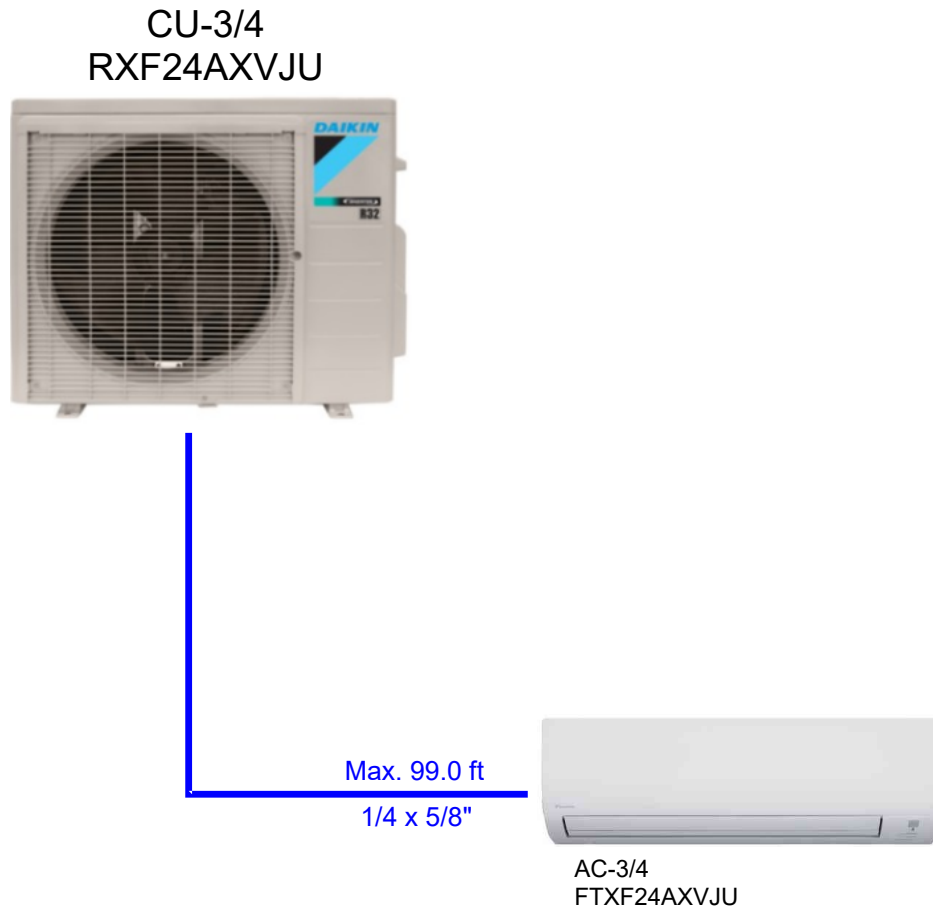

All piping to be as per TSSA. Contractor to provide TSSA refrigerant piping certificate B31.5 prior to commissioning by VRV manufacturer.
All systems shall display appropriate ODP tags prior to commissioning by VRV manufacturer.
Exposed outdoor insulation shall be protected by aluminum, sheet metal, painted canvas, plastic cover, or painted with an approved UV coating.
Isolation valves (if shown below) shall be bi-flow self seating valves rated for R-410A with operating pressures up to 650 PSI. Brass shroud connections shall be located on valve body.
Contractor to use clamps, expansion joints and installation practices which allows the pipes to expand and contract freely.
All pipe lengths and sizes below are estimates. Contractor to contact VRV manufacturer prior to purchase and install of refrigerant piping to confirm actual piping lengths and sizes.

Insulation:

- For indoor piping : 1/2" wall diameter Armaflex
- For outdoor piping : 3/4" wall diameter Armaflex

The VRV Selection application is property of Daikin Europe N.V. Daikin Europe N.V. cannot be held liable for any inaccuracy, reliability of the outcome of the VRV Selection application.



Split Piping Diagrams

Piping CU-5

NOTE: PIPING LENGTHS ARE ESTIMATES BASED ON TENDER DRAWINGS, LENGTHS AND DIAMETERS MAY CHANGE DUE TO SITE CONDITIONS

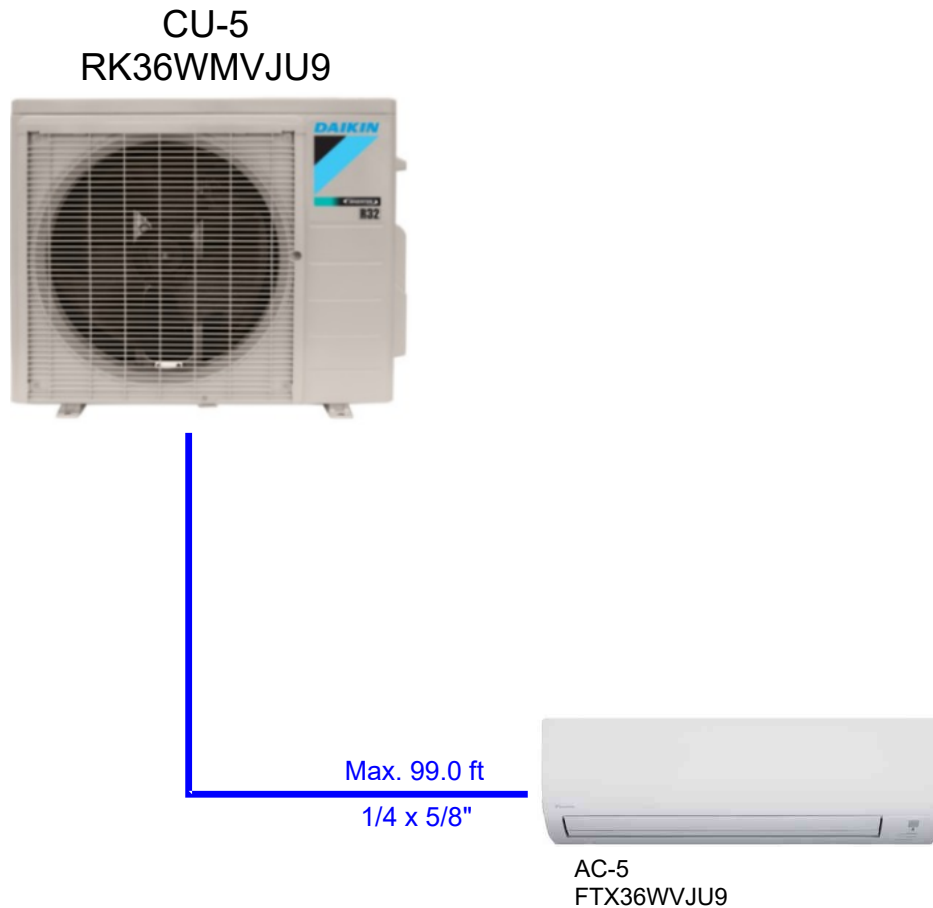

All piping to be as per TSSA. Contractor to provide TSSA refrigerant piping certificate B31.5 prior to commissioning by VRV manufacturer.
All systems shall display appropriate ODP tags prior to commissioning by VRV manufacturer.
Exposed outdoor insulation shall be protected by aluminum, sheet metal, painted canvas, plastic cover, or painted with an approved UV coating.
Isolation valves (if shown below) shall be bi-flow self seating valves rated for R-410A with operating pressures up to 650 PSI. Brass shradder connections shall be located on valve body
Contractor to use clamps, expansion joints and installation practices which allows the pipes to expand and contract freely.
All pipe lengths and sizes below are estimates. Contractor to contact VRV manufacturer prior to purchase and install of refrigerant piping to confirm actual piping lengths and sizes.

Insulation:

- For indoor piping : 1/2" wall diameter Armaflex
- For outdoor piping : 3/4" wall diameter Armaflex



Split Wiring Diagrams

Wiring CU-1/2

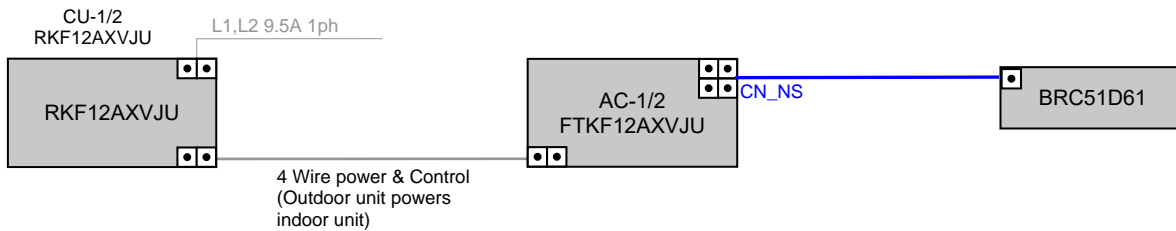

Wiring CU-3/4

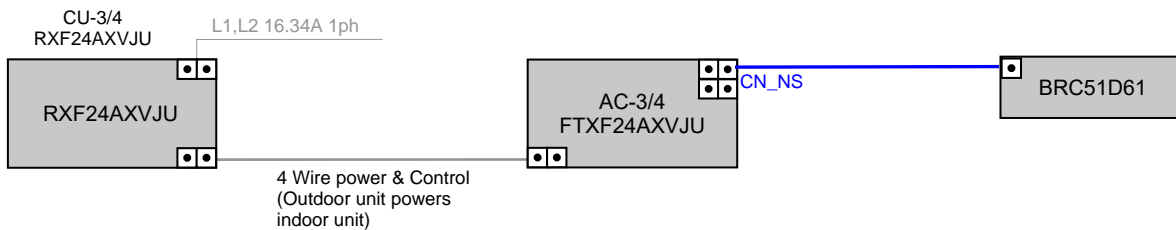

Wiring CU-5

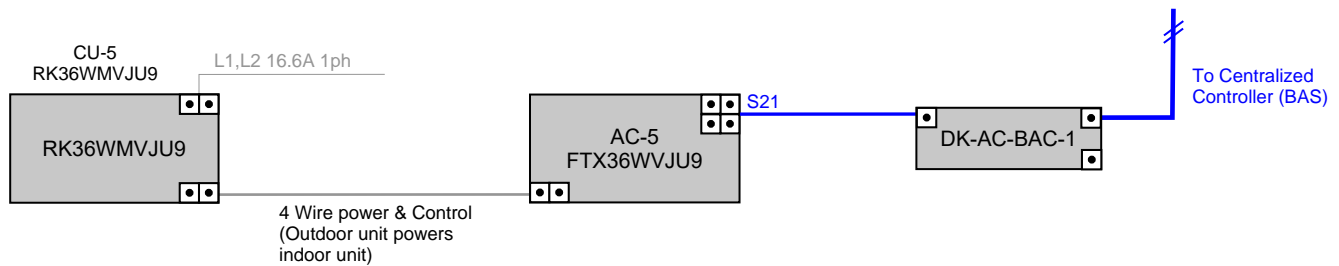

— Div 15 : Low Voltage control wiring 18 AWG 2-conductor stranded non-shielded (unless otherwise noted)

— Div 16 : Electrical power wiring

Notes:

- Individual disconnects are required for each piece of equipment
- Disconnect switches not provided by DXS/HTS, to be supplied and installed by others



Split System Technical Details

Daikin Split System

Mini Splits

AC/CU - 3, 4

AC/CU - 1, 2

AC/CU - 5

FTXF24AXVJU / RXF24AXVJU (2)

FTKF12AXVJU / RKF12AXVJU (2)

FTX36WVJU9 / RK36WMVJU9 (1)



Submittal Data Sheet

R-32 --- 2-Ton Wall Mounted Daikin OTERRA Heat Pump System

FTXF24AXVJU-RXF24AXVJU

Tag: AC/CU-3/4

FEATURES

- Daikin Swing Compressor
- Indoor Quiet Operation
- Included Handheld Remote
- Titanium Apatite Air-Purifying Filter
- Anti-corrosion Treatment of Outdoor Heat Exchanger

BENEFITS

- Precharged Line set - 33 ft
- Cooling Operation Range - 50-115F
- Heating Operation Range - 5-65F
- 12 Year Parts and Compressor Registered Residential Warranty
- 5 year Parts and Compressor Commercial Warranty
- R-32 Easy, Proven, Efficient, Available

INDOOR UNIT



OUTDOOR UNIT





Submittal Data Sheet

R-32 --- 2-Ton Wall Mounted Daikin OTERRA Heat Pump System
FTXF24AXVJU-RXF24AXVJU

SYSTEM PERFORMANCE

Indoor Unit Model No.	FTXF24AXVJU	Indoor Unit Name:	R-32 --- 2- Ton, Heat Pump, Wall Mounted IDU Daikin OTERRA
Outdoor Unit Model No.	RXF24AXVJU	Outdoor Unit Name:	R-32 --- 2 Ton, Heatpump, Ductless, ODU Daikin OTERRA
Rated Cooling Capacity (Btu/hr):	22,400	Rated Cooling Conditions:	Indoor (°F DB/WB): 80 / 67 Ambient (°F DB/WB): 95 / 75
Sensible Capacity (Btu/hr):	16,360	Rated Piping Length(ft):	25
Max/Min Cooling Capacity (Btu/hr):	26,400 / 7,000	Rated Height Difference (ft):	0.00
Cooling Input Power (kW):	6.570	Heating Input Power (kW):	6.92
SEER2 (Non-Ducted/Ducted):	21.00 /	HSPF2 (Non-Ducted/Ducted):	9.1 /
EER2 (Non-Ducted/Ducted):	12.00 /	Heating COP (Non-Ducted/Ducted):	3.3 /
Rated Heating Capacity (Btu/hr):	23,600	Rated Heating Conditions:	Indoor (°F DB/WB): 70 / 60 Ambient (°F DB/WB): 47 / 43
Max/Min Heating Capacity (Btu/hr):	28,600 / 6,200		

SYSTEM DETAILS

Refrigerant Type:	R-32	Cooling Operation Range (°F DB):	50 - 122
Holding Refrigerant Charge (lbs):	3.31	Heating Operation Range (°F WB):	5 - 65
Additional Charge (oz/ft):	0.18	Max. Pipe Length (Vertical) (ft):	66
Pre-charge Piping (Length) (ft):	33	Cooling Range w/Baffle (°F DB):	-4 - 122
Max. Pipe Length (Total) (ft):	99		
Max Height Separation (Ind to Ind ft):	0		



Submittal Data Sheet

R-32 --- 2-Ton Wall Mounted Daikin OTERRA Heat Pump System
FTXF24AXVJU-RXF24AXVJU

INDOOR UNIT DETAILS

Power Supply (V/Hz/Ph):	208-230 / 60 / 1	Airflow Rate (HH/HM/L/SL) (CFM):	754/716/605/467/395
Power Supply Connections:	L1, L2, L3, Ground	Moisture Removal (Gal/hr):	0.9
Min. Circuit Amps MCA (A):		Gas Pipe Connection (inch):	5/8
Max Overcurrent Protection (MOP) (A):		Liquid Pipe Connection (inch):	1/4
Dimensions (HxWxD) (in):	11-11/16 x 39-9/16 x 10-3/4	Condensate Connection (inch):	5/8
Net Weight (lb):	30.5	Sound Pressure (H/M/L/SL) (dBA):	53/45/39/34
Ext. Static Pressure (Rated/Max) (inWg):	/	Sound Power Level (dBA):	

DIMENSIONAL DRAWING - INDOOR UNIT

Model : FTKF18/24A, FTXF18/24A

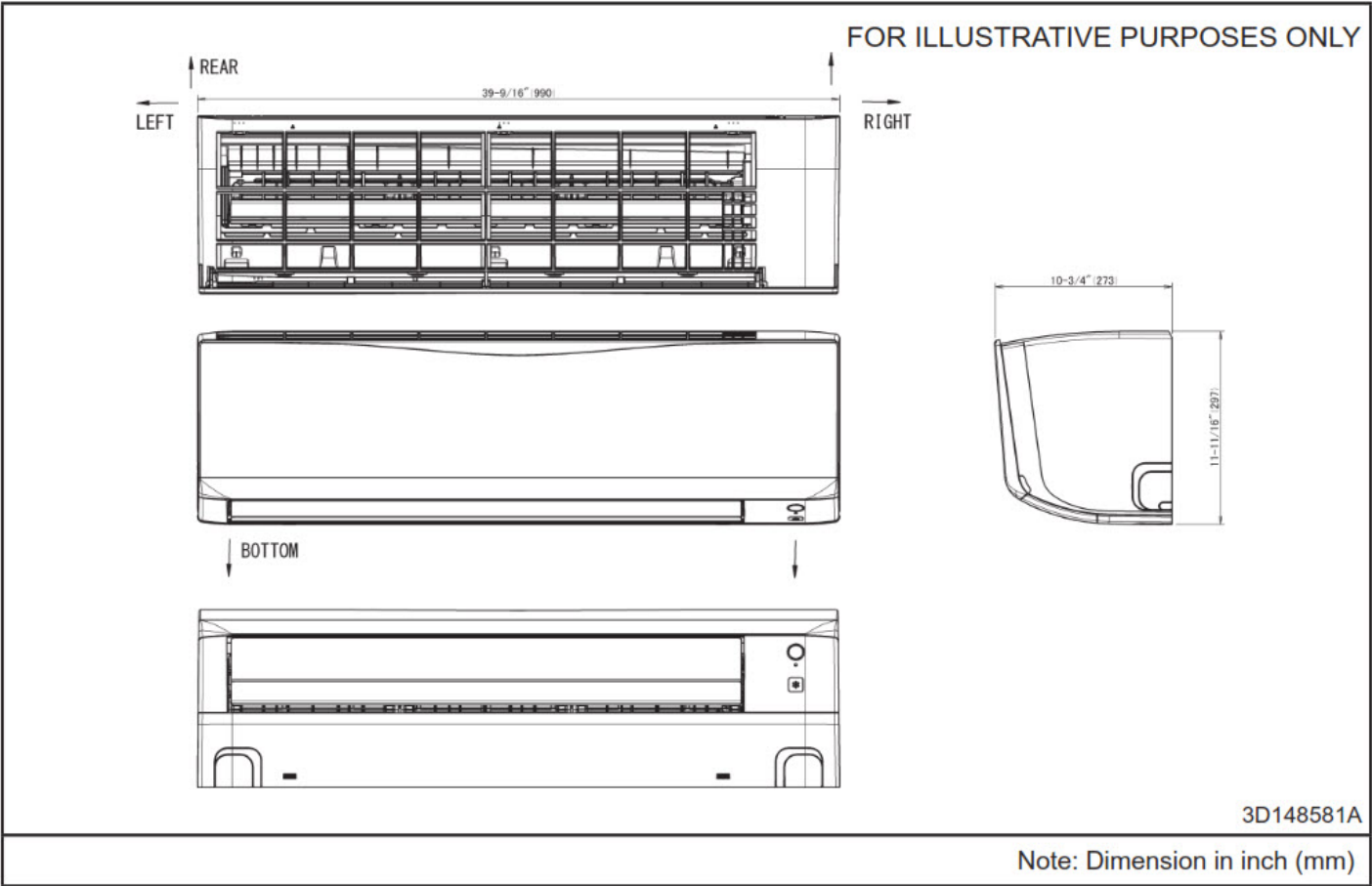

Submittal Data Sheet

R-32 --- 2-Ton Wall Mounted Daikin OTERRA Heat Pump System
FTXF24AXVJU-RXF24AXVJU

OUTDOOR UNIT DETAILS

Power Supply (V/Hz/Ph):	208-230 / 60 / 1	Compressor Stage:	Inverter
Power Supply Connections:	L1, L2, L3, Ground	Capacity Control Range (%):	-
Min. Circuit Amps MCA (A):	16.34	Airflow Rate (H) (CFM):	1879
Max Overcurrent Protection (MOP) (A):	20	Gas Pipe Connection (inch):	5/8
Max Starting Current MSC(A):		Liquid Pipe Connection (inch):	1/4
Rated Load Amps RLA(A):		Sound Pressure (H) (dBA):	55
Dimensions (HxWxD) (in):	27-13/32 x 36-5/8 x 13-13/16	Sound Power Level (dBA):	
Net Weight (lb):	101		

DIMENSIONAL DRAWING - OUTDOOR UNIT

Model : RKF18/24A, RXF18/24A

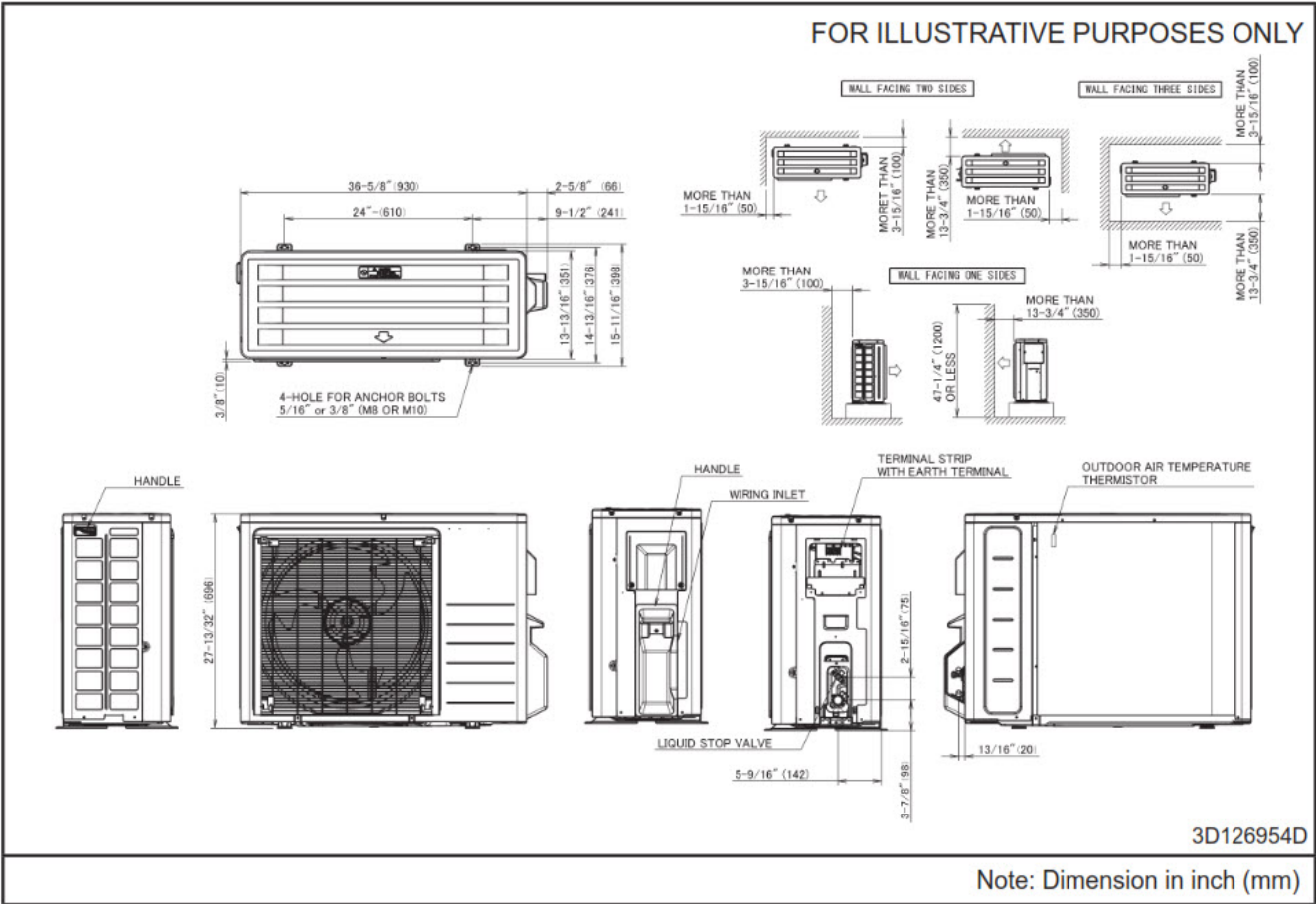



Submittal Data Sheet
R-32 --- 2-Ton Wall Mounted Daikin OTERRA Heat Pump System
FTXF24AXVJU-RXF24AXVJU

INDOOR ACCESSORIES

PART NUMBER	DESCRIPTION	INCLUDED
AZAI6WSCDKB	DKN Residential Cloud Wi-Fi Adaptor for Single- and Multi-Zone System (S21)	No
AZAI6WSPDKC	DKN Plus Interface	No
BRC51D61	Wired Remote Controller Kit	No
DACA-CP1-1	Mini Aqua Condensate Pump	No
DACA-CP4-1	MINI WHITE PUMP KIT 100-250V	No
DTST-LTE-LA-A	Daikin One Lite (with Translation Adaptor for S21 only)	No
DTST-ONE-ADA-A	Daikin One+ Smart Thermostat for VRV, SkyAir, Single- and Multi-Zone System	No
DTST-TOU-ADA-A	Daikin One Touch Smart Thermostat (with Translation Adaptor for S21 and P1P2)	No
KRP928BB2S	RA Interface Adaptor for DIII-Net -	No

OUTDOOR ACCESSORIES

PART NUMBER	DESCRIPTION	INCLUDED
DACA-WB-3	Powder-Coated Wall-Mounted Bracket	No
KEH063A4EA	Bml LRg Drain Pan Heater Rev A	No
KPW063B4E	Air Adjustment Grille	No



Submittal Data Sheet

R-32 --- 1-Ton Wall Mounted Daikin OTERRA Cooling Only System

FTKF12AXVJU-RKF12AXVJU

Tag: AC/CU-1/2

FEATURES

- Daikin Swing Compressor
- Indoor Quiet Operation
- Included Handheld Remote
- Titanium Apatite Air-Purifying Filter
- Anti-corrosion Treatment of Outdoor Heat Exchanger

BENEFITS

- R-32 Easy, Proven, Efficient, Available
- Precharged for up to 33 ft
- Cooling Operation Range - 50-118F for 9K/12K 50-122F for 18/24K
- 12 Year Parts and Compressor Registered Residential Warranty
- 5 year Parts and Compressor Commercial Warranty
- Cooling down to -4F for Facilities

INDOOR UNIT



OUTDOOR UNIT





Submittal Data Sheet

R-32 --- 1-Ton Wall Mounted Daikin OTERRA Cooling Only System
FTKF12AXVJU-RKF12AXVJU

SYSTEM PERFORMANCE

Indoor Unit Model No.	FTKF12AXVJU	Indoor Unit Name:	R-32 Daikin OTERRA 1 Ton AC only mini split indoor unit
Outdoor Unit Model No.	RKF12AXVJU	Outdoor Unit Name:	R-32 1 Ton, Cooling only, Ductless ODU Daikin OTERRA
Rated Cooling Capacity (Btu/hr):	12,000	Rated Cooling Conditions:	Indoor (°F DB/WB): 80 / 67 Ambient (°F DB/WB): 95 / 75
Sensible Capacity (Btu/hr):	9,540	Rated Piping Length(ft):	25
Max/Min Cooling Capacity (Btu/hr):	14,600 / 4,400	Rated Height Difference (ft):	0.00
Cooling Input Power (kW):	3.520		
SEER2 (Non-Ducted/Ducted):	21.00 /		
EER2 (Non-Ducted/Ducted):	12.50 /		

SYSTEM DETAILS

Refrigerant Type:	R-32	Cooling Operation Range (°F DB):	50 - 118
Holding Refrigerant Charge (lbs):	1.65		
Additional Charge (oz/ft):	0.18	Max. Pipe Length (Vertical) (ft):	49
Pre-charge Piping (Length) (ft):	33	Cooling Range w/Baffle (°F DB):	-4 - -4
Max. Pipe Length (Total) (ft):	66		
Max Height Separation (Ind to Ind ft):	0		



Submittal Data Sheet

R-32 --- 1-Ton Wall Mounted Daikin OTERRA Cooling Only System
FTKF12AXVJU-RKF12AXVJU

INDOOR UNIT DETAILS

Power Supply (V/Hz/Ph):	208-230 / 60 / 1	Airflow Rate (HH/HM/L/SL) (CFM):	473/436/316/247/132
Power Supply Connections:	L1, L2, L3, Ground	Moisture Removal (Gal/hr):	0.2
Min. Circuit Amps MCA (A):		Gas Pipe Connection (inch):	3/8
Max Overcurrent Protection (MOP) (A):		Liquid Pipe Connection (inch):	1/4
Dimensions (HxWxD) (in):	11-1/3 x 30-5/16 x 9-3/16	Condensate Connection (inch):	5/8
Net Weight (lb):	20.9	Sound Pressure (H/M/L/SL) (dBA):	46/38/32/19
Ext. Static Pressure (Rated/Max) (inWg):	/	Sound Power Level (dBA):	

DIMENSIONAL DRAWING - INDOOR UNIT

Model : FTKF09/12A, FTXF09/12A

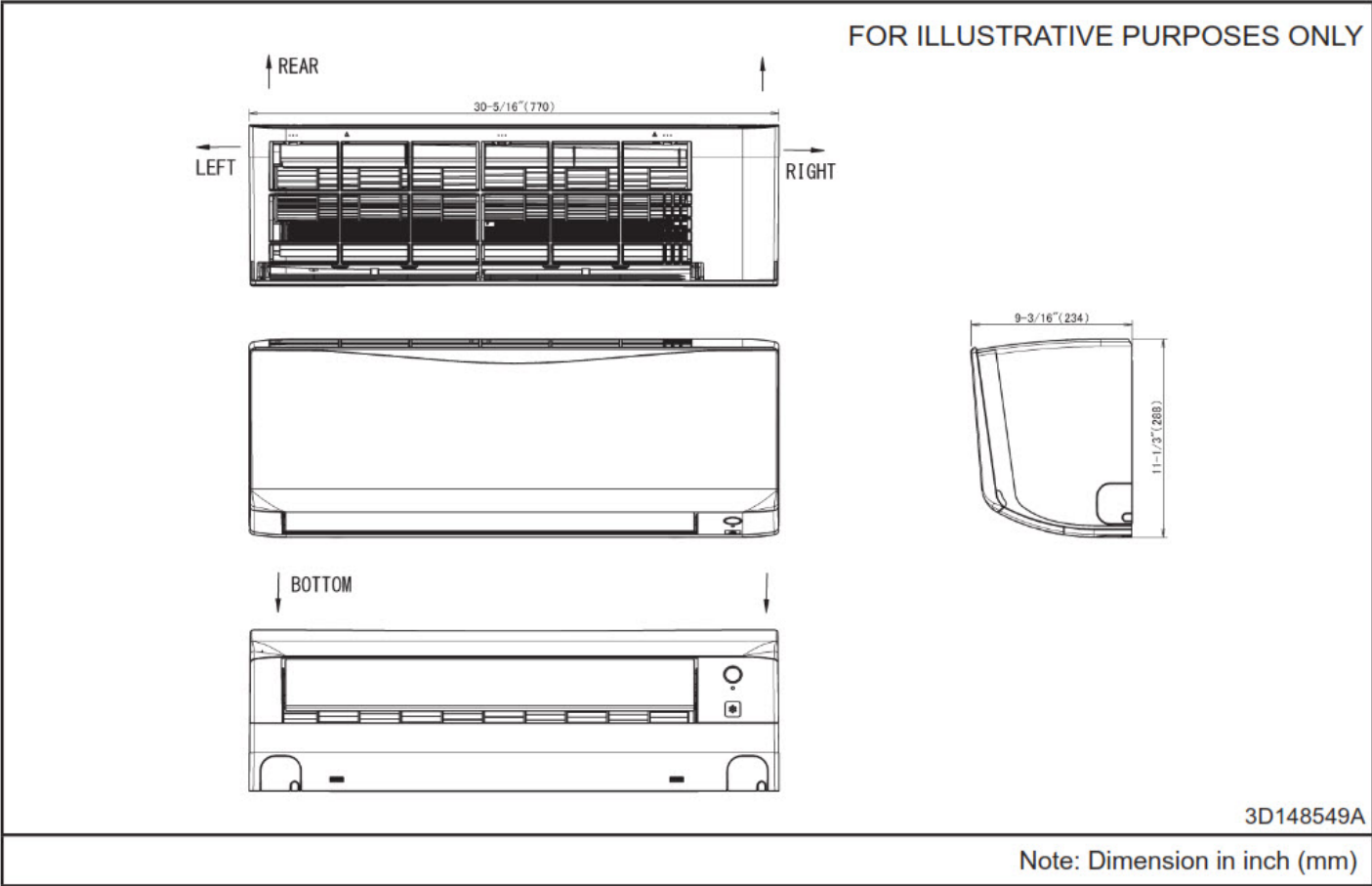

Submittal Data Sheet

R-32 --- 1-Ton Wall Mounted Daikin OTERRA Cooling Only System
FTKF12AXVJU-RKF12AXVJU

OUTDOOR UNIT DETAILS

Power Supply (V/Hz/Ph):	208-230 / 60 / 1	Compressor Stage:	Inverter
Power Supply Connections:	L1, L2, L3, Ground	Capacity Control Range (%):	-
Min. Circuit Amps MCA (A):	9.15	Airflow Rate (H) (CFM):	1051
Max Overcurrent Protection (MOP) (A):	15	Gas Pipe Connection (inch):	3/8
Max Starting Current MSC(A):		Liquid Pipe Connection (inch):	1/4
Rated Load Amps RLA(A):		Sound Pressure (H) (dBA):	49
Dimensions (HxWxD) (in):	21-11/16 x 26-1/2 x 11-3/16	Sound Power Level (dBA):	
Net Weight (lb):	60		

DIMENSIONAL DRAWING - OUTDOOR UNIT

Model : RKF09/12A, RXF09/12A

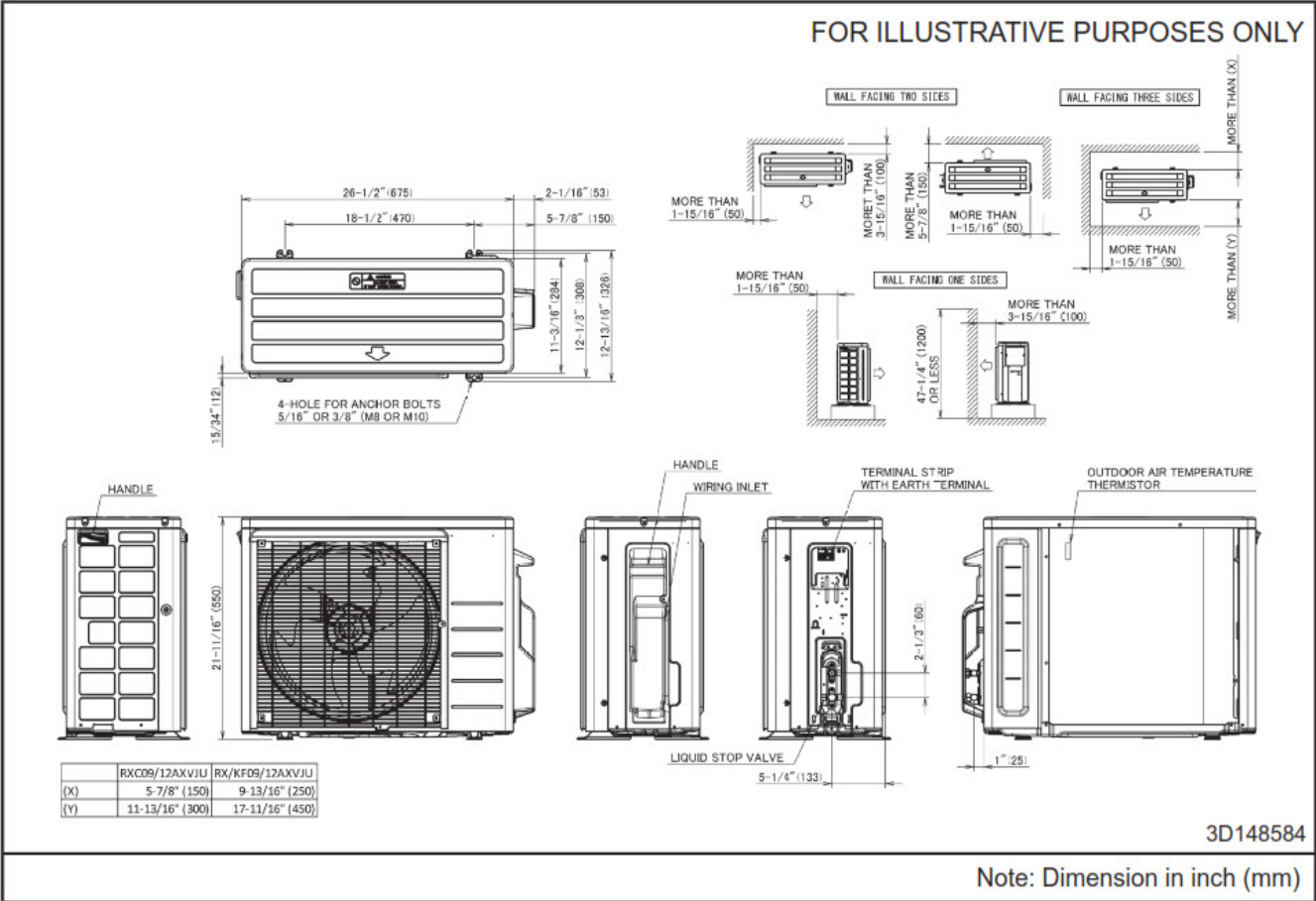



Submittal Data Sheet

R-32 --- 1-Ton Wall Mounted Daikin OTERRA Cooling Only System
FTKF12AXVJU-RKF12AXVJU

INDOOR ACCESSORIES

PART NUMBER	DESCRIPTION	INCLUDED
AZAI6WSCDKB	DKN Residential Cloud Wi-Fi Adaptor for Single- and Multi-Zone System (S21)	No
AZAI6WSPDKC	DKN Plus Interface	No
BRC51D61	Wired Remote Controller Kit	No
DACA-CP1-1	Mini Aqua Condensate Pump	No
DACA-CP4-1	MINI WHITE PUMP KIT 100-250V	No
DTST-LTE-LA-A	Daikin One Lite (with Translation Adaptor for S21 only)	No
DTST-ONE-ADA-A	Daikin One+ Smart Thermostat for VRV, SkyAir, Single- and Multi-Zone System	No
DTST-TOU-ADA-A	Daikin One Touch Smart Thermostat (with Translation Adaptor for S21 and P1P2)	No
KRP928BB2S	RA Interface Adaptor for DIII-Net -	No

OUTDOOR ACCESSORIES

PART NUMBER	DESCRIPTION	INCLUDED
DACA-WB-3	Powder-Coated Wall-Mounted Bracket	No
KEH067A41E	Daikin BMS DrainPan Heater Small RX09,12 and RXN09,12	No
KKG067A41	Back protection wire net (09 & 12)	No
KPW937F4	Air direction adjustment grille (09 & 12)	No



Submittal Data Sheet

Daikin Polara 3.0-Ton Wall Mounted Cooling Only System

FTX36WVJU9RK36WMVJU9

Tag: AC/CU-5

FEATURES

- "Powerful Operation Mode Econo Mode Program Dry Function Intelligent Eye Auto Fan Speed Wide Angle Louvers Dual Flap System Comfort Mode 3-D Airflow Low Ambient Cooling Quiet indoor and outdoor unit operation Auto Changeover and auto restart Self Diagnosis"

BENEFITS

- "For rooms with no false ceiling nor free floor space 10-year parts limited warranty for residential/commercial applications Cooling operation down to -22 F outside temperature Error codes display for fast and easy fault diagnosis Long lasting Titanium Apatite air filter Easy to clean flat panels Econo mode reduces power consumption."

INDOOR UNIT



OUTDOOR UNIT





Submittal Data Sheet

Daikin Polara 3.0-Ton Wall Mounted Cooling Only System
FTX36WVJU9RK36WMVJU9

SYSTEM PERFORMANCE

Indoor Unit Model No.	FTX36WVJU9	Indoor Unit Name:	Daikin POLARA 3.0T Wall Mounted Type IDU
Outdoor Unit Model No.	RK36WMVJU9	Outdoor Unit Name:	Daikin POLARA - 3.0-Ton, Cooling Only, Ductless ODU
Rated Cooling Capacity (Btu/hr):	33,200	Rated Cooling Conditions:	Indoor (°F DB/WB): 80 / 67 Ambient (°F DB/WB): 95 / 75
Sensible Capacity (Btu/hr):		Rated Piping Length(ft):	25
Max/Min Cooling Capacity (Btu/hr):	33,200 / 10,200	Rated Height Difference (ft):	0.00
Cooling Input Power (kW):			
SEER2 (Non-Ducted/Ducted):	15.90 /		
EER2 (Non-Ducted/Ducted):	9.10 /		
Rated Heating Capacity (Btu/hr):	35,200	Rated Heating Conditions:	Indoor (°F DB/WB): 70 / 60 Ambient (°F DB/WB): 47 / 43

SYSTEM DETAILS

Refrigerant Type:	R-410A R32	Cooling Operation Range (°F DB):	50 - 115 -22F
Holding Refrigerant Charge (lbs):	3.64	Heating Operation Range (°F WB):	5 - 64
Additional Charge (oz/ft):	0.32	Max. Pipe Length (Vertical) (ft):	66
Pre-charge Piping (Length) (ft):	33	Cooling Range w/Baffle (°F DB):	-22 - 115
Max. Pipe Length (Total) (ft):	99		
Max Height Separation (Ind to Ind ft):	0		

Submittal Data Sheet

Daikin Polara 3.0-Ton Wall Mounted Cooling Only System

FTX36WVJU9RK36WMVJU9

INDOOR UNIT DETAILS

Power Supply (V/Hz/Ph):	208/230 / 60 / 1	Airflow Rate (H/M/L/SL) (CFM):	915/742/572/512
Power Supply Connections:		Moisture Removal (Gal/hr):	
Min. Circuit Amps MCA (A):		Gas Pipe Connection (inch):	5/8
Max Overcurrent Protection (MOP) (A):		Liquid Pipe Connection (inch):	1/4
Dimensions (HxWxD) (in):	13-3/8 x 47-1/4 x 10-3/16	Condensate Connection (inch):	
Net Weight (lb):	38	Sound Pressure (H/M/L/SL) (dBA):	54/47/40/37
Ext. Static Pressure (Rated/Max) (inWg):	/	Sound Power Level (dBA):	

DIMENSIONAL DRAWING - INDOOR UNIT

FTX30/36WVJU9

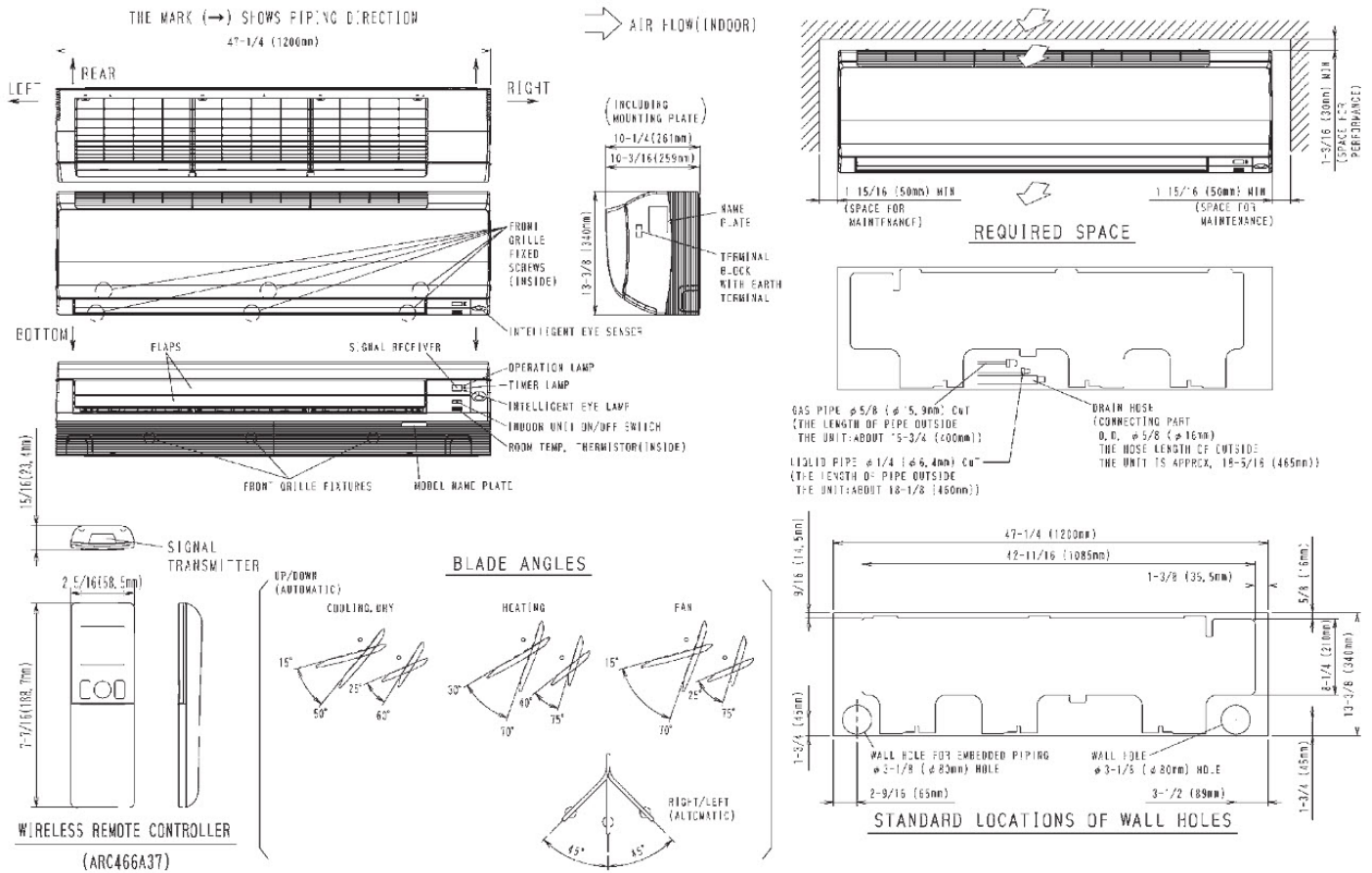

Submittal Data Sheet

Daikin Polara 3.0-Ton Wall Mounted Cooling Only System
FTX36WVJU9RK36WMVJU9

OUTDOOR UNIT DETAILS

Power Supply (V/Hz/Ph):	208/230 / 60 / 1	Compressor Stage:	Inverter
Power Supply Connections:		Capacity Control Range (%):	-
Min. Circuit Amps MCA (A):	16.6	Airflow Rate (H) (CFM):	2811
Max Overcurrent Protection (MOP) (A):	20	Gas Pipe Connection (inch):	5/8
Max Starting Current MSC(A):		Liquid Pipe Connection (inch):	1/4
Rated Load Amps RLA(A):	16.3	Sound Pressure (H) (dBA):	59
Dimensions (HxWxD) (in):	28-15/16 x 34-1/4 x 12-5/8	Sound Power Level (dBA):	
Net Weight (lb):	132		

DIMENSIONAL DRAWING - OUTDOOR UNIT
RK30/36WMVJU9, RX30/36WMVJU9

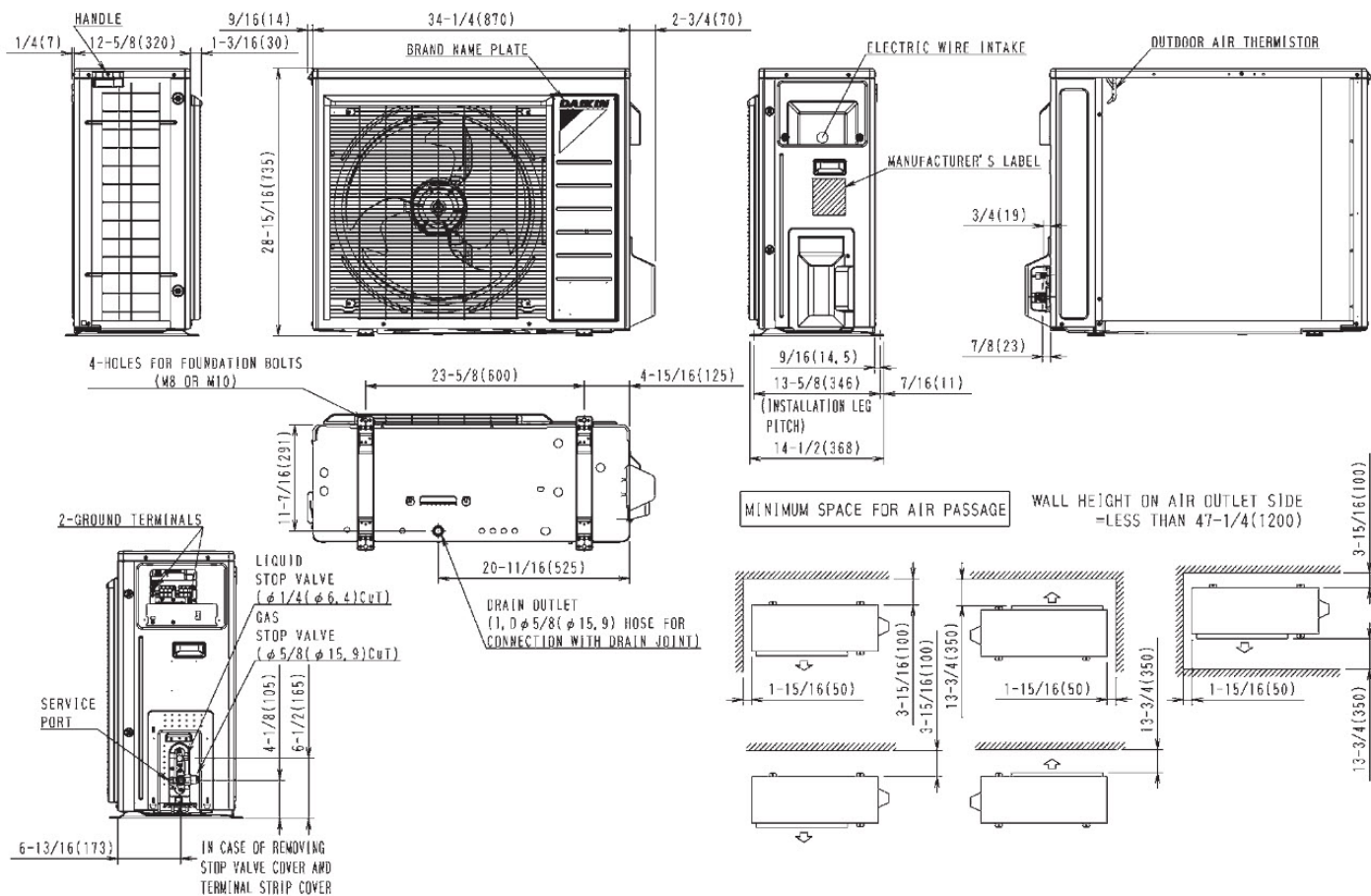



Submittal Data Sheet

Daikin Polara 3.0-Ton Wall Mounted Cooling Only System
FTX36WVJU9RK36WMVJU9

INDOOR ACCESSORIES

PART NUMBER	DESCRIPTION	INCLUDED
AZAI6WSCDKB	DKN Residential Cloud Wi-Fi Adaptor for Single- and Multi-Zone System (S21)	No
AZAI6WSPDKC	DKN Plus Interface	No
BRC944B2-A08	Wired Remote Controller kit	No
BRCW901A03	BRC944B2 CONTROL CABLE, 10FT	No
BRCW901A08	Wired Remote Controller Cord - 8m/26ft	No
BRP072A43	Daikin Comfort Control WiFi Adaptor	No
DACA-CP1-1	Mini Aqua Condensate Pump	No
DACA-CP4-1	MINI WHITE PUMP KIT 100-250V	No
DTST-LTE-LA-A	Daikin One Lite (with Translation Adaptor for S21 only)	No
DTST-ONE-ADA-A	Daikin One+ Smart Thermostat for VRV, SkyAir, Single- and Multi-Zone System	No
KRP928BB2S	RA Interface Adaptor for DIII-Net -	No

OUTDOOR ACCESSORIES

PART NUMBER	DESCRIPTION	INCLUDED
DACA-WB-3	Powder-Coated Wall-Mounted Bracket	No
KEH063A4E	Daikin BML DrainPan Heater Large	No
KKG063A42	Back protection wire net	No
KPW063B4	Air direction adjustment grille	No
RAQAHLGD1	Rear Coil Guard BML	No



Accessories Technical Data



Split Accessories

Wired Remote Controller Kit	BRC51D61 (4)
Mini Aqua Condensate Pump	DACA-CP1-1 (5)
Quicksling Stand	QSMS1801 (2)
Quicksling Stand	QSMS1800 (2)
Quicksling Stand	QSMS1802 (1)
Wind Guard	KPW937F4 (2)
Wind Guard	KPW063B4E (3)
BAS Adaptor	INBACDAI001I000 (1)

Project Name:

Location:

Engineer:

Submitted to:

Submitted by:

Reference:

Approval:

Date:

Construction:

Unit #:

Drawing #:

MODEL COMPATIBILITY:

Compatible with Single-Zone system indoor unit models:

Indoor Unit Models	Interface Adaptor
FTKB09AXVJU, FTKB12AXVJU, FTKB18AXVJU, FTKB24AXVJU, FTXB09AXVJU, FTXB12AXVJU, FTXB18AXVJU, FTXB24AXVJU, FTXB09BXVJU, FTXB12BXVJU, FTXB18BXVJU, FTXB24BXVJU	Not needed
CTX07AXVJU, CTX09AXVJU, CTX12AXVJU, FTK09AXVJU, FTK12AXVJU, FTK18AXVJU, FTK24AXVJU, FTX09AXVJU, FTX12AXVJU, FTX18AXVJU, FTX24AXVJU, FTK09BXVJU, FTK12BXVJU, FTK18BXVJU, FTK24BXVJU, FTX09BXVJU, FTX12BXVJU, FTX18BXVJU, FTX24BXVJU	Not needed

SPECIFICATIONS:

Model	BRC51D61
Description	Wired Remote Controller Kit
Maximum Indoor Units	1
Total Wiring Length	32.8ft (10m)
Dimensions	4.72 in x 4.72 in x 0.78 in (120mm x 120mm x 19.5 mm)
Connection Point	CN_WIRED (FTK/XB_AXVJU) CN_NS (FTK/X_AXVJU, FTK/X_BXVJU, FTXB_BXVJU)
Comfort Setpoint Range	60°F – 86°F
Operation	Start / Stop
	Mode (Auto/Heat/Cool/Dry/Fan)
	Set Temperature Setpoint
	Fan Speed
	Airflow Direction
	Feature Selection (SLEEP, ECO+, POWERFUL, QUIET)
Scheduling	Turn ON/OFF indoor unit LED display
	Weekly ON/OFF Timer

PRODUCT IMAGE:





Submittal Data Sheet

BRC51D61 – Wired Remote Controller Kit

Project Name: _____

Location: _____

Engineer: _____

Submitted to: _____

Submitted by: _____

Reference: _____

Approval: _____

Date: _____

Construction: _____

Unit #: _____

Drawing #: _____

FEATURES:

- The Wired Remote Controller Kit includes a wired remote controller, a 32 ft. connecting cable and mounting screws.
- Selectable auto / cool / heat / dry / fan operation modes with adjustable setpoint and fan speed
- Set temperature setpoint in °F or °C units with 1 degree increments
- Temperature is controlled through indoor unit temperature sensor
- Built in weekly ON/OFF timer functionality with up to 2 ON/OFF cycles per day
- Can be used together with the factory supplied standard wireless remote controller – the system will follow the last command provided by either the handheld remote or BRC51D61.
- Room temperature display available via jumper – readout is return air temp at the indoor unit.
- System maintains a 3° to 5°F temperature correction of the set point, depending on the mode of operation.
- The unit runs based on a 1°C temperature control. The setpoint command will be rounded to °C and sent to the indoor unit. For some setpoints, the indoor unit temperature command may not change as shown in the table below.

User Setpoint on Controller (°F)	Actual Indoor Unit Setpoint (°F)
68	68
69	68
70	70
71	70
72	72
73	73
74	73
75	75
76	75
77	77
78	77
79	79
80	79
81	81
82	82

DAIKIN COMFORT TECHNOLOGIES NORTH AMERICA, INC.

19001 Kermier Road, Waller, TX, 77484

www.daikinac.com www.daikincity.com

Rev.0923

(Daikin's products are subject to continuous improvements. Daikin reserves the right to modify product design, specifications, and information in this data sheet without notice and without incurring any obligations)

Project Name: _____

Location: _____

Engineer: _____

Submitted to: _____

Submitted by: _____

Reference: _____

Approval: _____

Date: _____

Construction: _____

Unit #: _____

Drawing #: _____

DIMENSIONS:

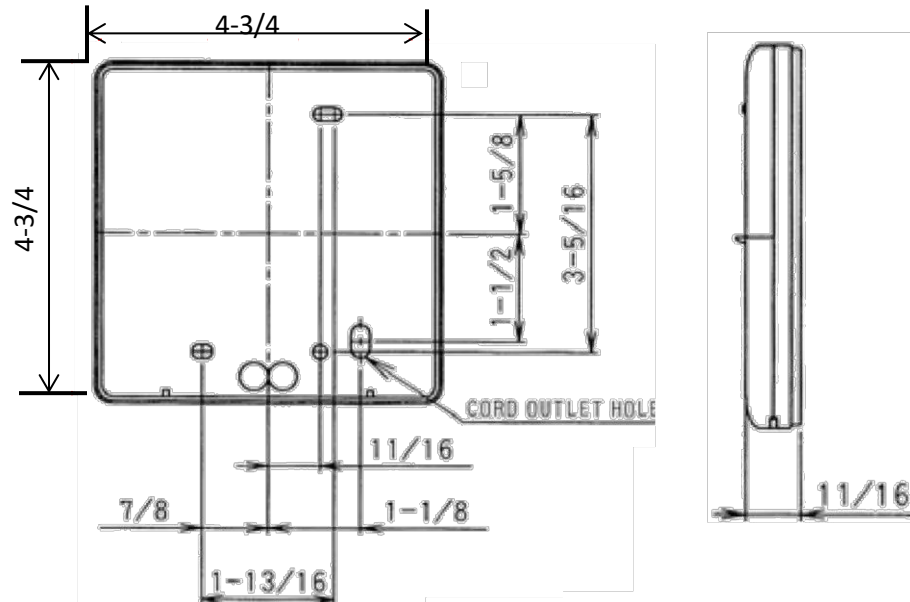

DOCUMENTATION:

Documentation available on www.daikincity.com and/or www.daikinac.com:

- Submittal
- Operation Manual (including installation instructions)

Submittal Data Sheet

DACA-CP1-1

Mini Univolt 100-250 Pump Kit

DACA-CP1-1

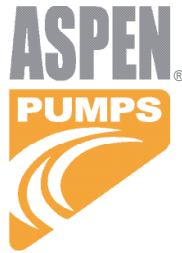

Project Information:

Job Name:

Location:

Engineer:

Submitted to:

For: ☐ Reference ☐ Approval ☐ Construction

Submitted by:

Reference:

Submittal Information:

Approval:

Date:

Construction:

Unit #:

Drawing #:

(Sec. I) Product Specifications:

Pump Length - 6.5"
Pump Width - 1.125"
Pump Height - 1.125"
Capacity - 3.2 GPH @ 0' Head
Max BTUs - 30000
Max Head in Feet - 33
Max Temperature - 104F
Max Suction Lift - 3'3"
Sound Level - 25dB(A)
Dry Contact Rating - 3A NC
Voltage - 100-250
Amperes - .15 MAX
Watts - 16
Remote Reservoir - Y
Plenum Rated - N
Cable Length - 6'

Pump Selector & Wiring Diagrams Available at
<http://www.ectorseal.com/index.php/daikin/>

(Sec. II) Ordering Information:

Product Code - DACA-CP1-1
Model - DACA-CP1-1
Carton Qty - 1
Carton Weight - 1.5

(Sec. III) Carton Contents:

Pump Assembly	Drain Hose Adaptor
Inline Reservoir	Inline Fuse
8"x5/8" i.d. Inlet Tube	Cable Ties (6)
5'x1/4" i.d. Vinyl Discharge Tube	Self Adhesive Velcro Strips (2)
Installation Manual	Anti-siphon (1)
6"x1/4" i.d. Vinyl Breather Tube	

(Fig. I) Product Image:



(Fig. II) Typical Pump Locations:

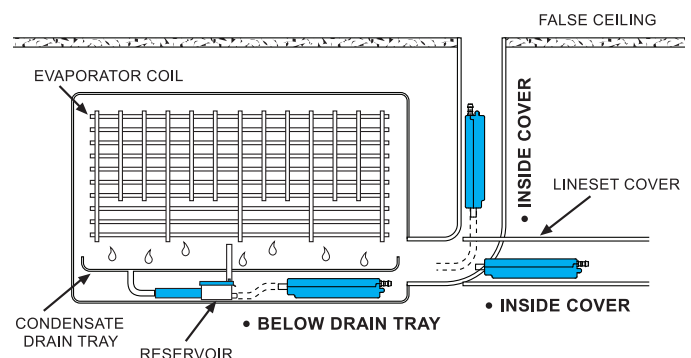

(RectorSeal's products are subject to continuous improvements; RectorSeal reserves the right to modify product design, specifications & information in this data sheet without notice and without incurring any obligations)
ASPEN® is a registered trademark of Aspen Oldco Limited Company UK

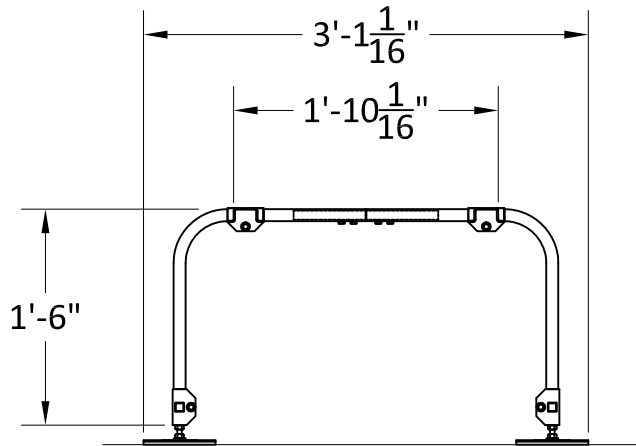

Side View - Retracted

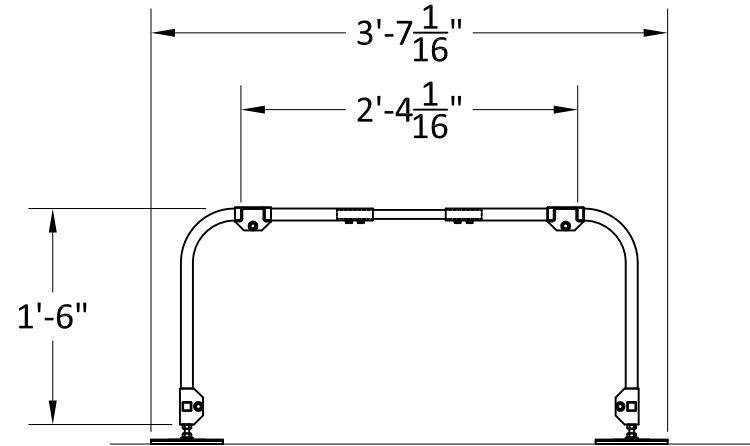

Side View - Expanded

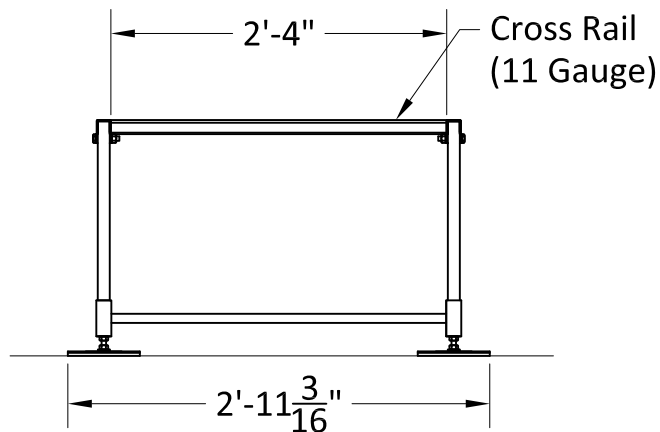

End View - Fixed

Alternate Carriage
Bolt Hole (typ)

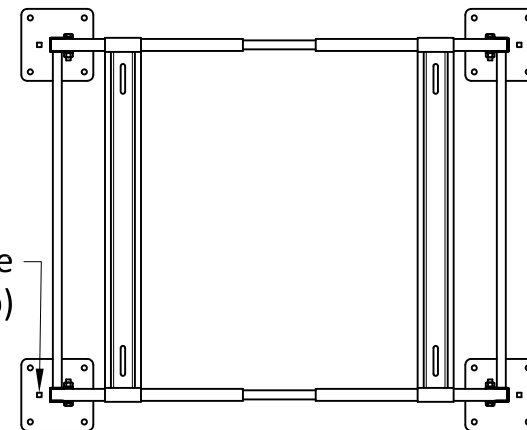

Plan View - Expanded

QUICK-SLING

ASSEMBLY DRAWING
"MINI-SPLIT 18"
ADJUSTABLE STAND - WIDE
MODEL NO. QSMS1802

www.quick-sling.com
email: info@quick-sling.com
fax: 1-(800)-699-0423

Quick Sling, LLC
391 W. Water Street
Taunton, MA 02780
1-(800)-699-0543

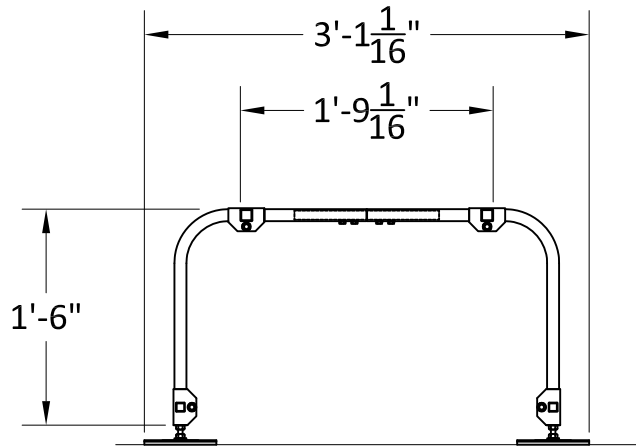

Side View - Retracted

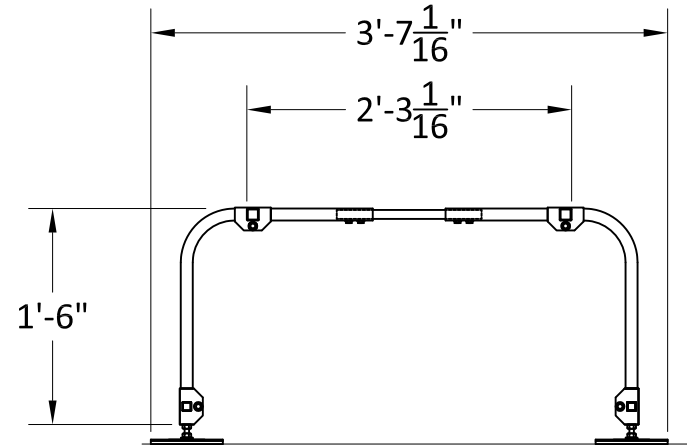

Side View - Expanded

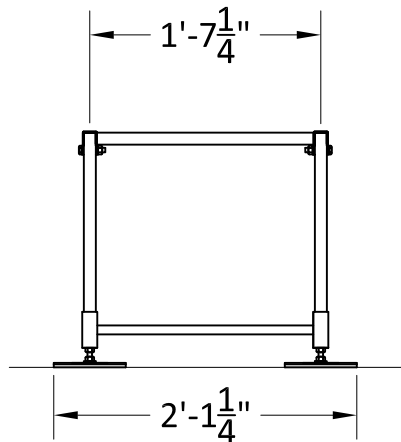

End View - Fixed

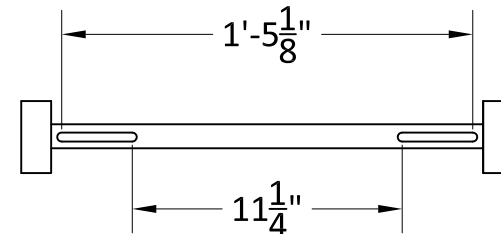

Spacer Bar Detail
(Showing Range of Bolt Spacing)



ASSEMBLY DRAWING
"MINI-SPLIT 18"
ADJUSTABLE STAND - WIDE
MODEL NO. QSMS1801

www.quick-sling.com
email: info@quick-sling.com
fax: 1-(800)-699-0423

Quick Sling, LLC
391 W. Water Street
Taunton, MA 02780
1-(800)-699-0543

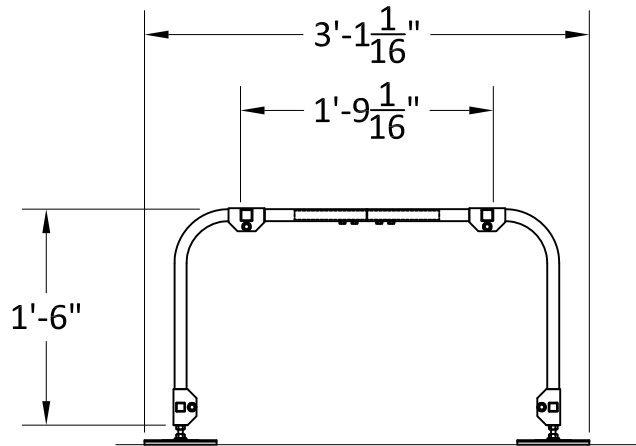

Side View - Retracted

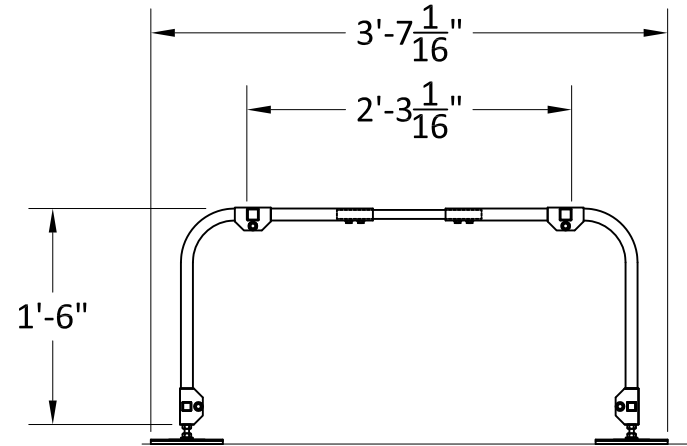

Side View - Expanded

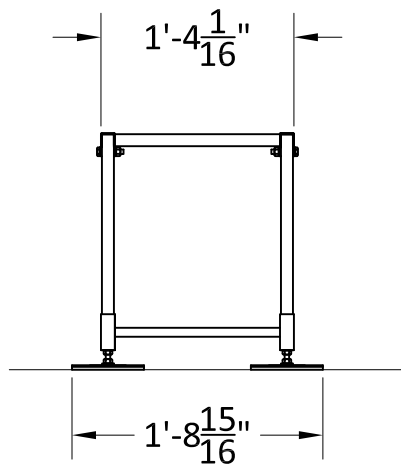

End View - Fixed

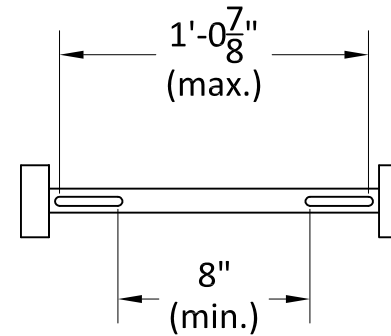

Spacer Bar Detail
(Showing Range of Bolt Spacing)



ASSEMBLY DRAWING
"MINI-SPLIT 18"
ADJUSTABLE STAND - THIN
MODEL NO. QSMS1800

www.quick-sling.com
email: info@quick-sling.com
fax: 1-(800)-699-0423

Quick Sling, LLC
391 W. Water Street
Taunton, MA 02780
1-(800)-699-0543



Submittal Data Sheet

Wind Baffle
KPW937F4

DESCRIPTION

Wind Baffle mounts over the standard air grille and allows adjustment in air blow-off direction.

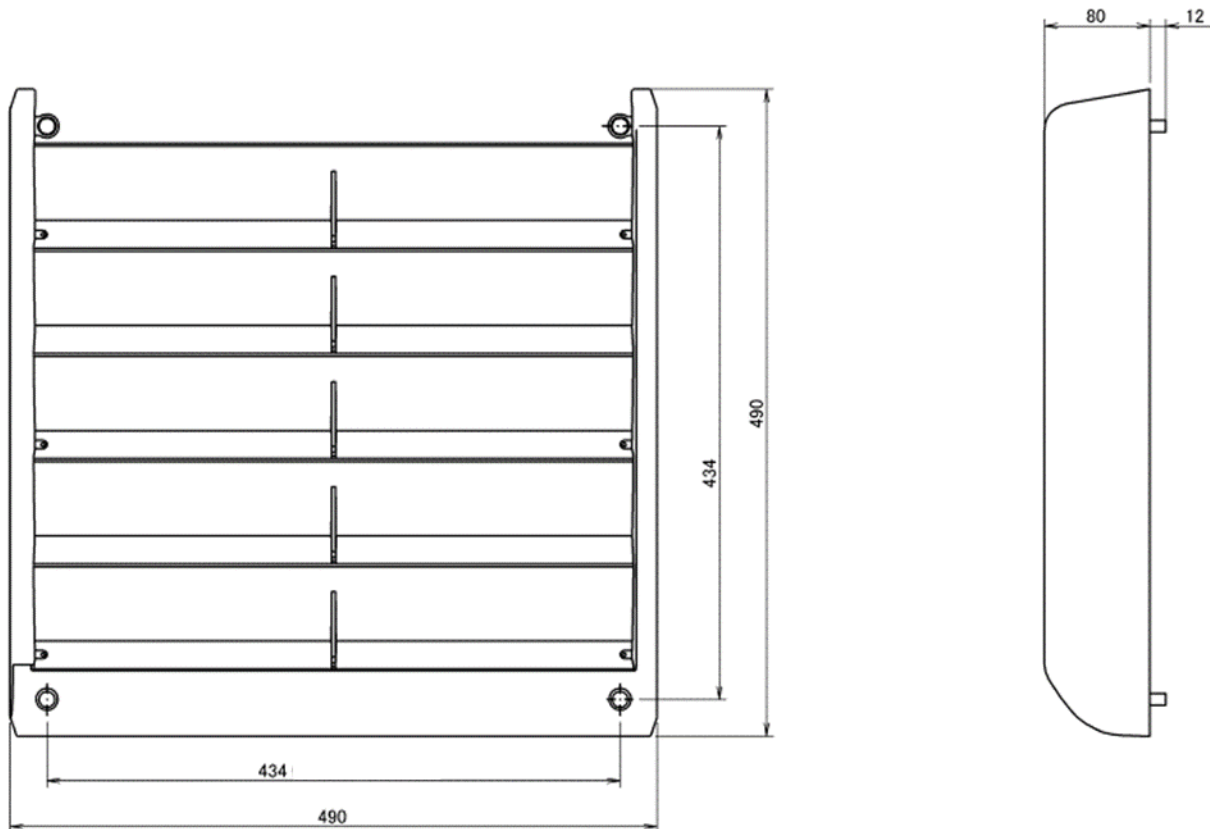

Image for REFERENCE ONLY

SPECIFICATIONS

Model No:	KPW937F4	
Unit Compatibility:	RK09NMVJU, RK12NMVJU, RX09NMVJU, RX12NMVJU, RX09RMVJU(9), RX12RMVJU(9), RXL09QMVJU, RXL12QMVJU(9), RXS09LVJU, RXS12LVJU, RXG09HVJU, RXG12HVJU, RXG15HVJU	Qty (1)
Unit Names:	Wind Baffle	
Dimensions (WxHxD):	19-5/16" x 19-5/16" x 3-5/8" (490mm x 490mm x 92mm)	
Shipping Unit Weight:	6.75 lb.	
Material:	Flame Retardant Grade UL94V-HB	

DIMENSIONAL DRAWING (mm)



Daikin North America LLC, 5151 San Felipe, Suite 500, Houston TX, 77056
www.daikinac.com www.daikincomfort.com

(Daikin's products are subject to continuous improvements. Daikin reserves the right to modify product design, specifications and information in this data sheet without notice and without incurring any obligations).



Submittal Data Sheet

Air Adjustment Grille (Wind Baffle)
KPW063B4E

DESCRIPTION

Air Adjustment Grille (Wind Baffle) mounts over the standard air grille and allows adjustment in air blow-off direction.

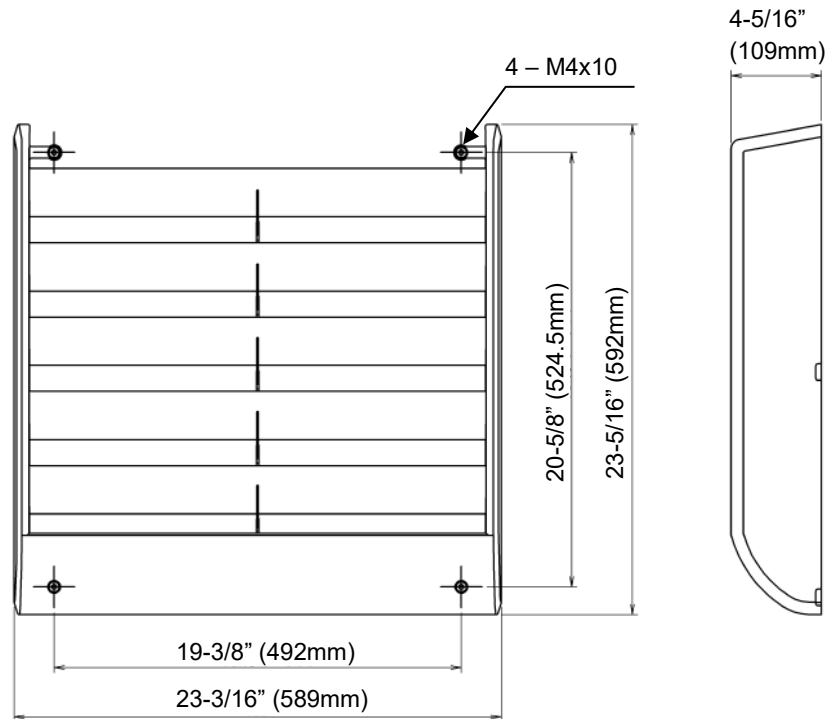

Image for REFERENCE ONLY

SPECIFICATIONS

Model No:	KPW063B4E	
Unit Compatibility:	RK18AXVJU, RK24AXVJU, RX18AXVJU, RX24AXVJU	Qty (1)
Unit Names:	Air Adjustment Grille (Wind Baffle)	
Dimensions (WxHxD):	23-3/16" x 23-5/16" x 4-5/16" (589mm x 592mm x 109mm)	
Shipping Unit Weight:	6 lb. (2.7 kg)	
Material:	Flame Retardant Grade UL94V-HB	

DIMENSIONAL DRAWING



Daikin North America LLC, 5151 San Felipe, Suite 500, Houston TX, 77056
www.daikinac.com www.daikincomfort.com

(Daikin's products are subject to continuous improvements. Daikin reserves the right to modify product design, specifications and information in this data sheet without notice and without incurring any obligations).

Instrucciones de seguridad
⚠ ATENCIÓN

Siga atentamente estas instrucciones de seguridad e instalación. Un manejo inadecuado puede ocasionar daños graves para su salud y daños irreparables en el interfaz y/o en la unidad interna del aire acondicionado.

- Esta interfaz debe ser instalada por personal técnico acreditado (electricista, instalador, o personal técnico cualificado) y siguiendo todas las instrucciones de seguridad.
- Antes de manipular en el interior del aire acondicionado, asegúrese de que está completamente desconectado de la red eléctrica.
- En caso de instalación mural del interfaz junto a la unidad interior del aire acondicionado, fije la interfaz de forma segura siguiendo las instrucciones del diagrama de abajo.
- La interfaz debe ser instalada en una ubicación con acceso restringido.

Instrucciones de instalación

- Desconecte el sistema Daikin de la red eléctrica.
- Fije el interfaz a la pared junto a la unidad interior del aire acondicionado siguiendo las instrucciones del diagrama de abajo (respeta las instrucciones de seguridad anteriores).
- Conecte el extremo largo del cable suministrado al conector S21 de la unidad interior de AA y el otro extremo al conector AC Unit de la pasarela Intesis.
- Conecte el bus EIA485 al conector *EIA485* de la interfaz (para conexión MS/TP) o el cable RJ45 al conector ETH (para conexión IP).
- Tape la unidad interior del aire acondicionado y vuelva a conectarlo a la red eléctrica.
- Siga las instrucciones del manual de usuario para la configuración y puesta en servicio del interfaz.
- Siga las instrucciones de la página siguiente para configurar la interfaz a través de los Micro Interruptores.

Safety instructions
⚠ WARNING

Follow carefully this safety and installation instructions. Improper work may lead to serious harmful for your health and also may damage seriously the interface and/or the AC indoor unit.

- This interface must be installed by accredited technical personnel (electrician, installer, or technical personnel) and following all the safety instructions.
- Before manipulate the AC indoor unit be sure it is completely disconnected from Mains power.
- In case of wall mounting of the interface beside the AC indoor unit, fix the interface safely following the instructions of the diagram below.
- This interface must be installed in an access restricted location.

Installation instructions

- Disconnect the Daikin system from Mains Power.
- Fix the interface beside the AC indoor unit (wall mounting) following the instructions in the diagram below (respect the safety instructions given above).
- Connect the long end of the supplied cable in the S21 connector of the AC indoor unit and the other end into the "AC Unit" connector for our gateway.
- Connect the EIA485 bus to the connector *EIA485* of the interface (for MS/TP connection) or the RJ45 cable to the ETH connector (for IP connection).
- Close the AC indoor unit and reconnect it to Mains Power.
- Follow the instructions on the user manual for configuring and commissioning the interface.
- Follow the instructions of the next page to configure the interface through on-board DIP-switches.

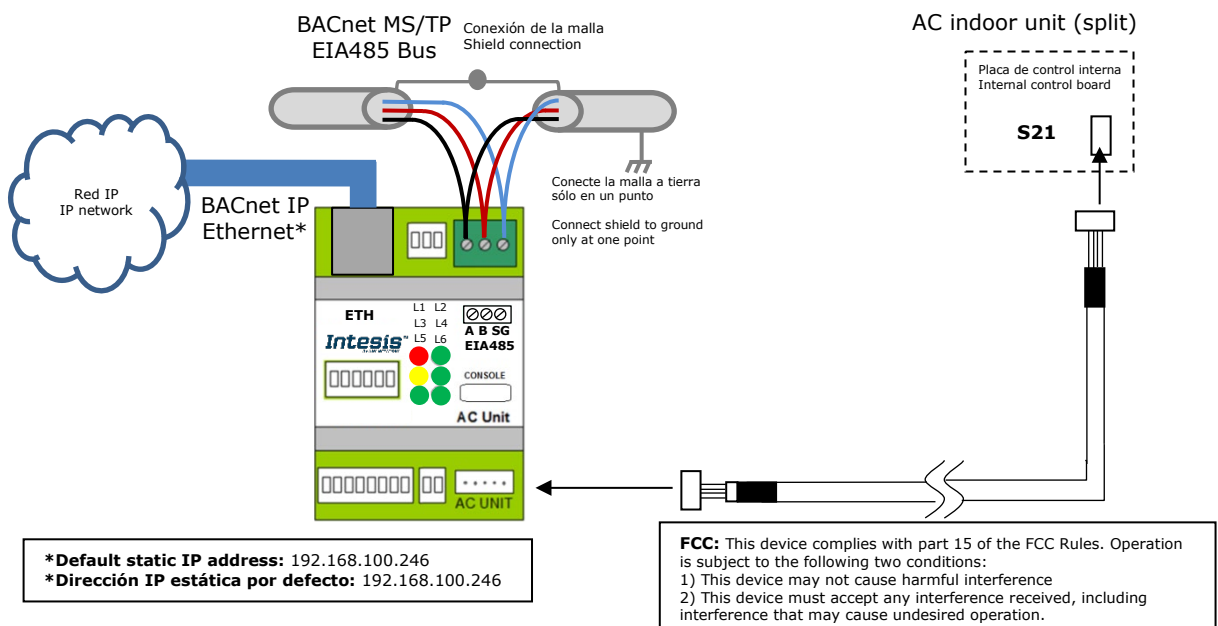

IMPORTANTE: La ampliación o acortamiento del cable de conexión que se incluye con el interfaz puede provocar un funcionamiento incorrecto. Mantenga el cable de conexión lo más alejado posible del cableado eléctrico y del cable de tierra, no los enrolle juntos.

IMPORTANT: Extending or shortening the connecting cable included with the interface may cause it to malfunction. Keep the connecting cable as far away as possible from electrical wires and ground wire. Do not bundle them together.

Configuración por Micro Interruptores

Configuration through DIP - switches

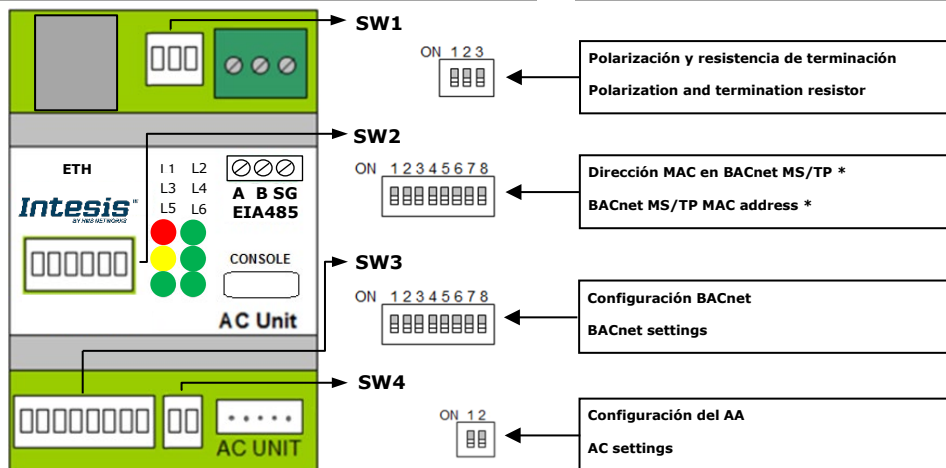

SW1 – Polarización y terminación – Polarization and termination

Valor binario Binary value b ₀ ...b ₂	Valor decimal Decimal value	Interruptores Switches 1 2 3	Descripción Description
0xx	0	↓ x x	Bus EIA485 sin resistencia de terminación. La pasarela no está en un extremo del bus EIA485 (valor por defecto) EIA485 bus without termination resistor. The gateway is not at one end of the EIA485 bus (default value)
1xx	1	↑ x x	Resistencia de terminación de 120 Ω activa. La pasarela está en un extremo del bus EIA485. 120 Ω termination resistor active. The gateway is at one end of the EIA485 bus
x00	0	x ↓ ↓	Sin polarización en el bus No bus polarization
x11	3	x ↑ ↑	Con polarización en el bus Bus polarization active

SW2 – Dirección MAC en BACnet MS/TP – BACnet MS/TP MAC address

Valor binario Binary value b ₆ ...b ₇	Valor decimal Decimal value	Interruptores Switches 1 2 3 4 5 6 7 8	Dirección MAC MAC address
0000000x	0	↓ ↓ ↓ ↓ ↓ ↓ ↓ x	0
1000000x	1	↑ ↓ ↓ ↓ ↓ ↓ ↓ x	1
0100000x	2	↓ ↑ ↓ ↓ ↓ ↓ ↓ x	2
1100000x	3	↑ ↑ ↓ ↓ ↓ ↓ ↓ x	3
.....
1011111x	125	↑ ↓ ↑ ↑ ↑ ↑ ↑ x	125
0111111x	126	↓ ↑ ↑ ↑ ↑ ↑ ↑ x	126
1111111x	127	↑ ↑ ↑ ↑ ↑ ↑ ↑ x	127

* NOTA: La dirección MAC seleccionada puede afectar el Device Instance. Consulte el manual para más información. - * NOTE: The MAC address selected may affect on the Device Instance. Check the manual for more information.

SW3 – Configuración BACnet – BACnet settings

Valor binario Binary value b ₆ ...b ₇	Valor decimal Decimal value	Interruptores Switches 1 2 3 4 5 6 7 8	Descripción Description
0xxxxxxx	0	↓ x x x x x x x	BACnet MS/TP active BACnet MS/TP activo (valor por defecto - default value)
1xxxxxxx	1	↑ x x x x x x x	BACnet IP active BACnet IP activo
x000xxxx	0	x ↓ ↓ ↓ x x x x	Autobaudrate (valor por defecto - default value)
x100xxxx	1	x ↑ ↓ ↓ x x x x	9600 bps
x010xxxx	2	x ↓ ↑ ↓ x x x x	19200 bps
x110xxxx	3	x ↑ ↑ ↓ x x x x	38400 bps
x001xxxx	4	x ↓ ↑ ↑ x x x x	57600 bps
x101xxxx	5	x ↑ ↓ ↑ x x x x	76800 bps
x011xxxx	6	x ↓ ↑ ↑ x x x x	115200 bps
x111xxxx	7	x ↑ ↑ ↑ x x x x	Reserved - Reservado
xxxx0xxx	0	x x x x ↓ x x x	Grados Celsius Celsius Degrees
xxxx1xxx	1	x x x x ↑ x x x	Grados Fahrenheit Fahrenheit Degrees

SW4 – Configuración del AA – AC settings

Valor binario Binary value b ₀ ...b ₁	Valor decimal Decimal value	Interruptores Switches 1 2	Descripción Description
0x	0	↓ x	Reserved Reservado
1x	1	↑ x	Reserved Reservado
x0	0	x ↓	Reserved Reservado
x1	1	x ↑	Reserved Reservado

LED – Información proporcionada por los LEDs – LED information

LED	Comportamiento Behaviour	Descripción Description
L1 (red)	ON steady	Error de comunicación con el AA AC communication error
	Blinking	Error en el AA AC error
	Off	Funcionamiento normal No errors present

LED	Comportamiento Behaviour	Descripción Description
L5 (green)	ON steady	Link con BACnet MS/TP BACnet MS/TP Link
	Blinking	Actividad en el bus MS/TP Activity on the MS/TP bus

LED	Comportamiento Behaviour	Descripción Description
L6 (green)	ON steady	Link con BACnet IP BACnet IP Link
	Blinking	Actividad en el bus BACnet IP Activity on the BACnet IP bus

NOTA: Para más información acerca de otros modos de operación de los leds consulte el manual - NOTE: Check the manual for more information about other LED operation modes

El manual de usuario está disponible en - The user manual is available at:
<https://intesis.com/products/ac-interfaces/daikin-gateways/daikin-bacnet-ac-dk-ac-bac-1>

This marking on the product, accessories, packaging or literature (manual) indicates that the product contains electronic parts and they must be properly disposed of by following the instructions at <https://intesis.com/weee-regulation>

Doc. r1.0

© HMS Industrial Networks S.L.U - All rights reserved
 This information is subject to change without notice

Intesis
 BY HMS NETWORKS

URL

<https://www.intesis.com>