

GPY+ Associates Engineering Inc.

MECHANICAL SHOP DRAWINGS

**PROJECT: York Region Administrative
Centre – Interior Fit-up
Package ‘D’**

17250 Yonge Street,
Newmarket, Ontario
L3R 0T5

Reviewed ☐ Reviewed as Modified ☐
Not Reviewed ☐ Revise and Resubmit ☒

This review is for conformance with the general design intent only and does not change the intent of the Contract Documents. Responsibility for errors or omissions in the shop drawings, details, co-ordination and dimensioning remains solely with the Contractor.

GPY+ Associates Engineering Inc.

Name: Sherwin Reyes

Date: December 10, 2024

PROJECT NO.: GPY-9920

Shop Drawing No.: M-2

Product: Plumbing Fixtures

Supplier: Next Plumbing & Hydronics Supply Inc.

Comments:

1. Lavatory ‘L-1’: Acceptable. **Ensure lavatory size has been site measured and shall match ground floor lavatory installation. Install lavatory from wall to wall and ensure it sits inside wall edges with no gaps. Lavatory shall be installed by Lovair trained personnel as per drawings.**
2. Lavatory ‘L-1’ faucet & soap dispenser: Acceptable. **Finish shall be as per architect’s selection. Faucet and soap dispenser shall be hardwired. Contractor to submit a sketch showing piping arrangement, wiring routing and clearances for York Region’s PM review and approval prior to installation of lavatory faucet and soap dispenser. Work shall not proceed without York Region’s PM approval.**
3. Water Closet ‘WC-1’: Acceptable. **Please provide adjustable toilet carrier as per drawings. Installation height to be confirmed with Architect.**
4. ‘WC-1’ flush valve: **Alternate model is not acceptable. Flush valve is designed for urinal. Please revise & re-submit this item only.**
5. Water Closet ‘WC-2’: Acceptable. **Please provide adjustable toilet carrier as per drawings. Installation height to be confirmed with Architect.**
6. ‘WC-2’ flush valve: **Alternate model is not acceptable. Flush valve is designed for urinal. Please revise & re-submit this item only.**
7. Urinal ‘U-1’: Acceptable. **Please provide urinal carrier as per drawings. Installation height to be confirmed with Architect.**
8. ‘U-1’ flush valve: **Alternate model is acceptable, however contractor to ensure requirement for a 1” I.P.S. connection to flush valve is available on site.**
9. Kitchen Sink ‘S-1’: Acceptable.

10. 'S-1' faucet: Acceptable.

11. We recommend the shop drawings to be reviewed by architect & electrical consultant for their comments.



SUBMITTAL

TO: GPY + Associates Engineering Inc. – ATTN: Sherwin Reyes
PROJECT: York Region, Administration Building Package D Renovations
ADDRESS: 17250 Yonge Street, Newmarket, ON
INCLUDED: Mechanical Shop Drawing – Plumbing Fixtures
SPEC DIV: 22 42 03

From: Trisect Construction Corporation
7-4020A Sladeview Crescent
Mississauga, ON L5L 6B1
Tom Butkovic / Ivan Lulic / Jay Cowie

The shop drawings included below have been:

- ☒ REVIEWED
- ☐ REVIEWED AS NOTED
- ☐ RESUBMIT
- ☐ REJECTED

Review of this submission is for compliance with the general intent of the contract. This review does not relieve the Sub-Contractor, Trade Contractor, Supplier or Manufacturer of the responsibility of meeting all requirements of the contract documents. Any deviation from the contract documents initiated by the Sub-Contractor, Trade Contractor, Supplier or Manufacturer shall be at his sole risk and responsibility. QUANTITIES AND DETAIL DIMENSIONS ARE THE SUBCONTRACTORS OR SUPPLIERS' RESPONSIBILITY. VERIFY THE DATA WITH FIELD DIMENSIONS AND CONDITIONS.

Per: Tom Butkovic	Dated: November 22/2024
Final review to be received by: G. Bruce Stratton Architects	





54 Audia Court, Unit 2
Concord, ON L4K 3N5
(905)-738-1400

Submittal 24-277-005

PROJECT NAME	PROJECT ADDRESS	DATE SUBMITTED
YORK REGION VARIOUS PROJECTS 24-277	17250 Young Street Newmarket, ON	Nov 21, 2024

TO	FROM
Tom Butkovic	PAUL LEDDY
COMPANY	COMPANY
TRISECT CONSTRUCTION	Consult Mechanical Inc.
EMAIL	EMAIL
tbutkovic@trisectionconstruction.com	paul.l@consultmechanical.com
ADDRESS	ADDRESS
4020A SLADEVIEW cRESCENT, UNIT 7 MISSISSAUGA, ON L5L 6B1 JOB: 1300 INSLINGTON SUITE 103	54 Audia Court, Unit 2 Concord, ON L4K 3N5

Title

Plumbing Fixtures

Description

Tag L-1 Manufacturer Ardec/Zurn
Tag WC-1 Manufacturer American Standard
Tag WC-2 Manufacturer American Standard
Tag U-1 Manufacturer American Standard
Tag S-1 Manufacturer Franke/American Standard/Zurn

Package Items

SPEC	SUBSECTION	ITEM	TYPE
M-101	M-101	Plumbing Fixtures Specifications	Shop Drawings

SHOP DRAWING PACKAGE

Prepared for
CONSULT MECHANICAL

**YORK REGION CENTRE -
17250 YONGE STREET**

NOV 21, 2024

SHOP DRAWING

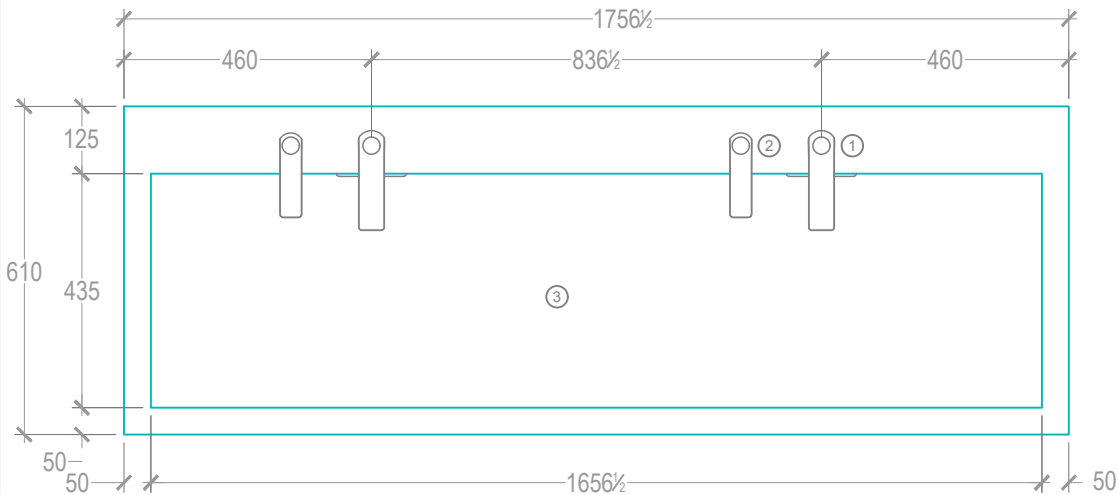

TOP VIEW

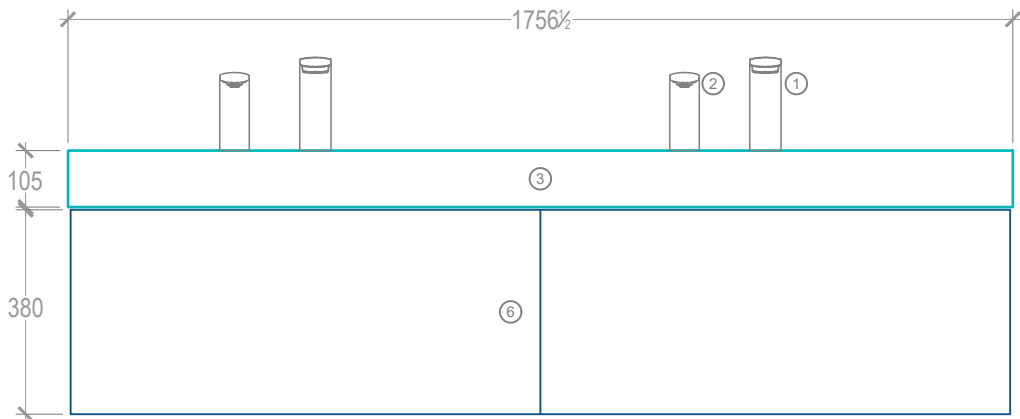

FRONT VIEW

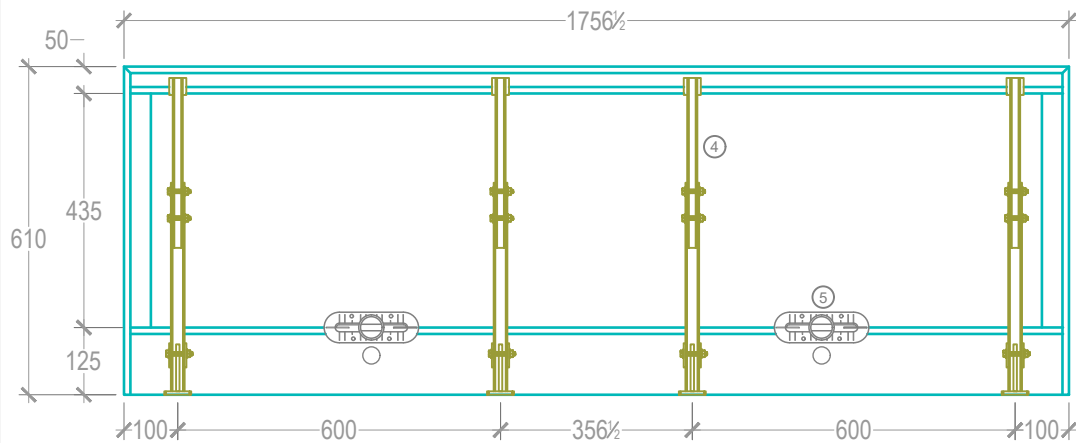

BOTTOM VIEW

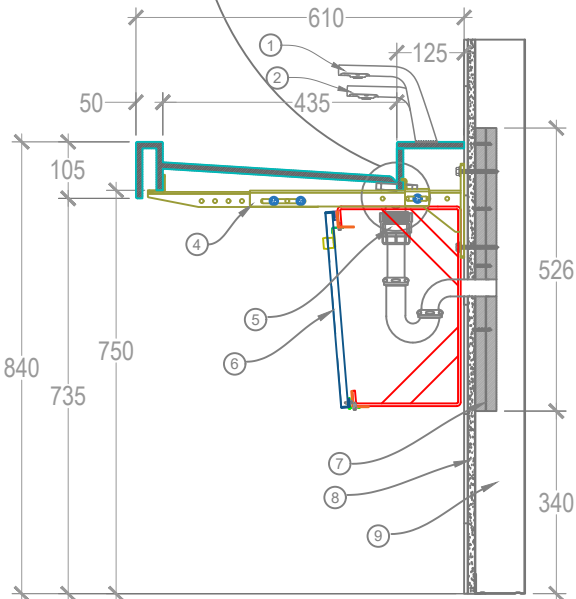
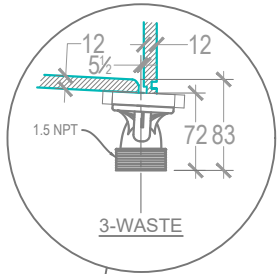

SECTION VIEW

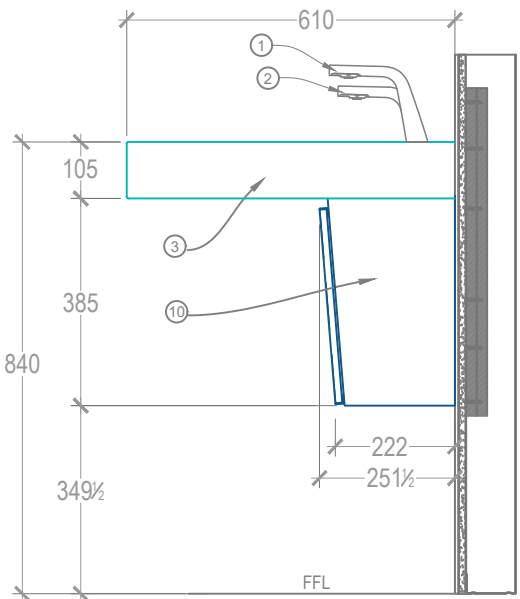

END VIEW

Product Key			
#	Description	Material / Type	QTY
1	Faucet	TSL.R.020 Satin	1 Per User
2	Soap Dispenser	TSL.R.010 Satin	1 Per User
3	Monolith Basin	Glacier White	Custom
4	Ardec Adjustable Bracket	Metal Powder Coated White	2 Per 600mm
5	Lovair Waste Funnel (1.5 NPT)	-	1 Per User
6	Pipe Skirt	Stainless Steel	-
7	Blocking In Wall	Double 3/4" Waterproof Fireproof / Plywood	Not Included
8	Wall Cladding	As Per Customer	Not Included
9	Wall Structure	As Per Customer	Not Included
10	Pipe Skirt End Panels	Stainless Steel	As Required

ARDEC
GROUP

WWW.ARDECGROUP.COM

905-648-3809

Notes :

- This Drawing is Not for Construction until Stamped, Signed and Approved
- This Drawing is not to be scaled
- The Contractors shall check and verify all dimensions and report all errors and omissions to Ardec Group, prior to commencing the work.
- The Design and Layout of all Mechanical and Structural Elements in this drawing including but not limited to ; Counters, Sinks, Panels, Table Tops,Cupboards Support Structures, Brackets, Hangers, Substrates, Fasteners & Materials must be approved and constructed in accordance with all local Engineering, Codes and Insurance Requirements.

Specifications :

Material - Glacier White
Solid Surface

Job Name: York Region

Title: Monolith A Series
1756.5x610x105 mm

Job # -
Date: -

Product # -
Model # -

Quantity
3

Dwg Ref # -
Sheet - Of -

Dwg #

Rev:

-

Date

Revisions:

Rev

TSL.R.O20

Ribbon
Faucet

Deck mounted sensor operated faucet with robust body construction for all types of projects. Available mains or battery powered. To be used in conjunction with the Ribbon dryer and soap dispenser for optimum efficiency.



CODES	POWER SUPPLY	FINISH	LIGHT REFLECTANCE VALUE
TSL.R.O20.C.ELE	Mains	Bright Polished Stainless steel	58
✓ TSL.R.O20.CS.ELE	Mains	Brushed Stainless steel	51
TSL.R.O20.CP.ELE	Mains	Brushed Copper	19
TSL.R.O20.BK.ELE	Mains	Brushed Black	3
TSL.R.O20.BR.ELE	Mains	Brushed Brass	40
TSL.R.O20.BZ.ELE	Mains	Brushed Bronze	17
TSL.R.O20.C.BAT	Battery	Bright Polished Stainless steel	58
TSL.R.O20.CS.BAT	Battery	Brushed Stainless steel	51
TSL.R.O20.CP.BAT	Battery	Brushed Copper	19
TSL.R.O20.BK.BAT	Battery	Brushed Black	3
TSL.R.O20.BR.BAT	Battery	Brushed Brass	40
TSL.R.O20.BZ.BAT	Battery	Brushed Bronze	17

TECHNICAL DATA

Minimum operating pressure	7.5 psi dynamic pressure
Flow rate	0.5 GPM
Water supply	Pre-mixed
Weight	3lb 5oz
Stainless steel grade	AISI 304 Stainless steel
Hot water temperature	Max 122°F
Sensor range	Preset 5" (adjustable). Min range 2 1/2" - Max range 16"
Comfort delay	2 seconds ±20%
Security cut-off	30 seconds ±20%
Power supply - mains	Input: 100 - 240V; 50 - 60Hz; 1.5A Output: 6v DC, 1A, 6W max. Waterproof connection to sensor lead
Power supply - battery	Battery - CRP2 lithium
Warranty	3 years parts and 1 year labour (from date of purchase)



INSTALLATION REQUIREMENTS

Counter top cut-out (dia)	Ø1 1/4"
Maximum countertop thickness	1 3/8"
Anti-rotation collar	Included
Reflective surfaces	Not to be installed above highly polished basins, or waste outlets
Access requirements	Solenoids, isolation valves and transformers must be accessible at all times for servicing
Cabling	3 amp fused spur to IP68 rated transformer; low voltage push fit connector to faucet
Power supply	For the mains power option, it is recommended that the sensors are installed on their own circuit to avoid interference from other power demands.

COMPLIANCE AND CERTIFICATIONS

ADA compliant
 ASME A112.18.1 / CSA B125.1-2018,
 NSF/ANSI 61-2017
 NSF/ANSI 372-2016,
 International Plumbing Code (IPC) 2018, 2015, 2012 and 2009
 International Residential Code (IRC) 2018, 2015, 2012 and 2009
 Uniform Plumbing Code (UPC) 2018, 2015, 2012 and 2009
 National Plumbing Code of Canada (NPC) 2015, 2010 and 2002
 LEED.v4- Compliant for assessment for Water Saving and Efficiency
 BREEAM – 5 credits



RELATED PRODUCTS

Ribbon dryer	TSL.R.030
Ribbon soap dispenser	TSL.R.010

FOR SPECIFIER / ARCHITECT APPROVAL

Project:			
Code (including finish):		Quantity:	
Signed:		Date:	

TECHNICAL DRAWING

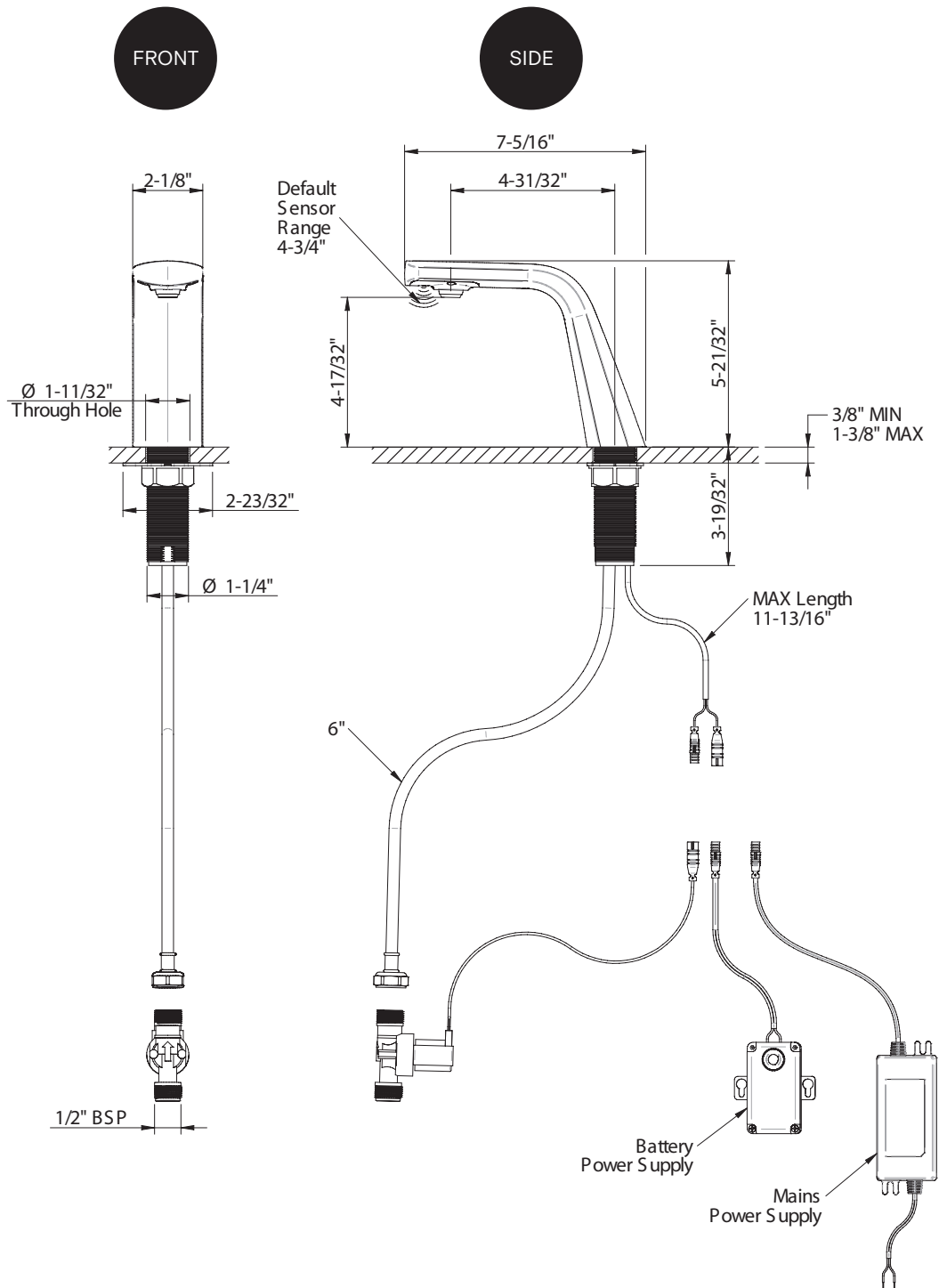

TSL.R.020

Ribbon
Faucet

Deck mounted sensor operated faucet with robust body construction for all types of projects. Available mains or battery powered. To be used in conjunction with the Ribbon dryer and soap dispenser for optimum efficiency.



CODES	POWER SUPPLY	FINISH	LIGHT REFLECTANCE VALUE
TSL.R.020.C.ELE.H	Mains	Bright Polished	58
✓ TSL.R.020.CS.ELE.H	Mains	Brushed Stainless	51
TSL.R.020.CP.ELE.H	Mains	Brushed Copper	19
TSL.R.020.BK.ELE.H	Mains	Brushed Black	3
TSL.R.020.BR.ELE.H	Mains	Brushed Brass	40

TECHNICAL DATA

Minimum operating pressure	7 - 87 psi dynamic pressure
Flow rate	0.5 GPM (Other flow rates available upon request)
Weight	2lb 3oz
Stainless steel grade	AISI 304 Stainless steel
Sensor range	Preset 5" (adjustable). Min range 3" +/-20% - Max range 5.9" +/-20%
Comfort delay	2 seconds
Security cut-off	60 seconds
	To flush 20 seconds after 24 hours of no usage
Power supply - mains	Input: 100 - 240V; 50 - 60Hz Output: 6C DC; 0.5A; 3W max.
Warranty	1 years parts and labor



INSTALLATION REQUIREMENTS

Counter-top cut-out (dia)	Ø1 1/4"
Maximum countertop thickness	1 3/8"
Anti-rotation collar	Included
Reflective surfaces	Not to be installed above highly polished basins, or waste outlets
Access requirements	Solenoids, isolation valves and transformers must be accessible at all times for servicing
Cabling	3 amp fused spur to IP68 rated transformer; low voltage push fit connector to faucet
Power supply	For the mains power option, it is recommended that the sensors are installed on their own circuit to avoid interference from other power demands.

COMPLIANCE AND CERTIFICATIONS

ADA compliant
 ASME A112.18.1 / CSA B125.1-2018,
 NSF/ANSI 61-2017
 NSF/ANSI 372-2016,
 International Plumbing Code (IPC) 2018, 2015, 2012 and 2009
 International Residential Code (IRC) 2018, 2015, 2012 and 2009
 Uniform Plumbing Code (UPC) 2018, 2015, 2012 and 2009
 National Plumbing Code of Canada (NPC) 2015, 2010 and 2002
 LEED.v4 Compliant for assessment for Water Saving and Efficiency
 BREEAM 5 credits



BREEAM®

RELATED PRODUCTS

Ribbon dryer	TSL.R.030
Ribbon soap dispenser	TSL.R.010
Ribbon two-fixture set (soap + water)	TSL.R.021
Ribbon three-fixture set (soap, water + air)	TSL.R.031

FOR SPECIFIER / ARCHITECT APPROVAL

Project:			
Code (including finish):		Quantity:	
Signed:		Date:	

TECHNICAL DRAWING

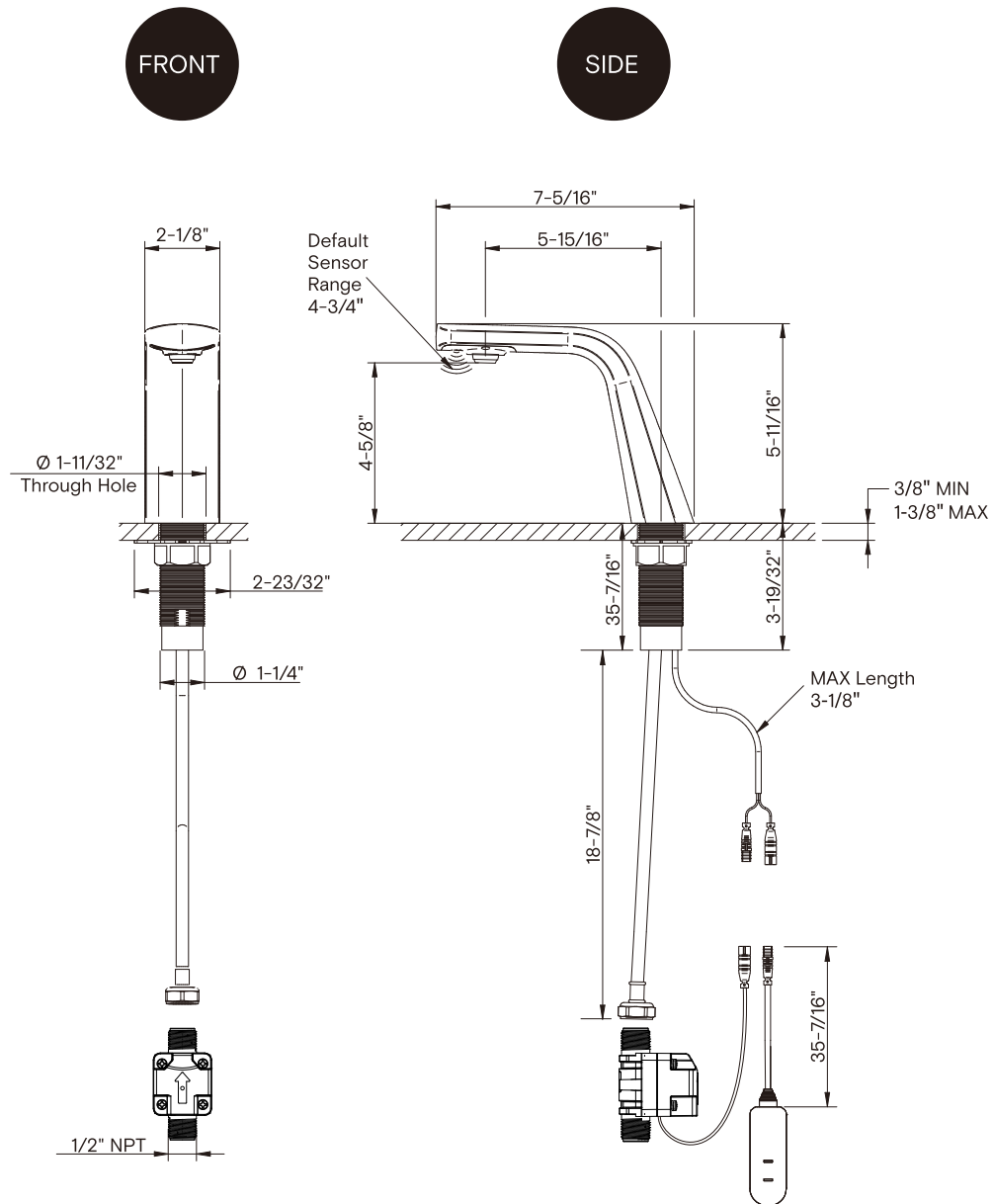



SEMI-CAST P-TRAPS WITH WALL BEND

Z8700-PC TO Z8708-PC

TAG



Engineering Specification: Zurn Z8700-PC to Z8708-PC. – Chrome-plated cast brass (copper alloy) body P-trap with cleanout, tubular brass wall bend as specified, die-cast nuts, and shallow escutcheon with compression inlet.

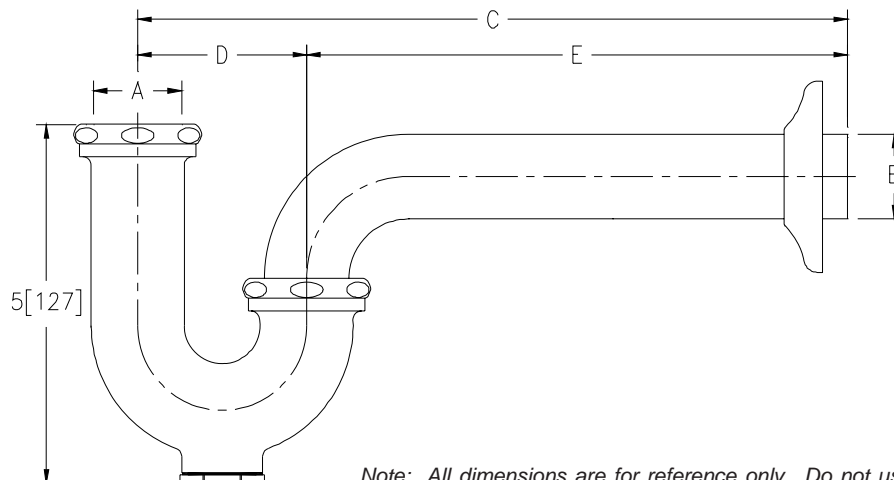

Note: All dimensions are for reference only. Do not use for pre-plumbing.

PRODUCT NUMBER	A INLET in[mm]	B OUTLET in[mm]	GAUGE	DIMENSIONS			MASTER CARTON	WEIGHT CARTON [lbs]
				C in[mm]	D in[mm]	E in[mm]		
Z8700-PC	1 1/4[32]	1 1/4[32]	17	10[254]	2 1/2[64]	7 1/2[191]	12	24
Z8700-8-PC	1 1/4[32]	1 1/4[32]	17	11[279]	2 1/2[64]	8 1/2[216]	12	24
Z8700-15-PC	1 1/4[32]	1 1/4[32]	17	15[381]	2 1/2[64]	12 1/2[318]	18	40
Z8701-PC	1 1/4[32]	1 1/2[38]	17	10 1/2[267]	3[76]	7 1/2[191]	12	24
Z8701-9-PC	1 1/4[32]	1 1/2[38]	17	12[305]	3[76]	9[229]	12	24
Z8701-15-PC	1 1/4[32]	1 1/2[38]	17	15[381]	3[76]	12[305]	18	42
Z8702-PC*	1 1/2[38]	1 1/2[38]	17	10 1/2[267]	3[76]	7 1/2[191]	12	24
Z8702-9-PC*	1 1/2[38]	1 1/2[38]	17	12[305]	3[76]	9[229]	12	24
Z8702-15-PC*	1 1/2[38]	1 1/2[38]	17	15[381]	3[76]	12[305]	18	42
Z8703B-PC**	1 1/2[38]	2[51]	17	12 1/2[318]	3 1/2[89]	9[229]	6	18
Z8704B-PC**	2[51]	2[51]	17	12 1/2[318]	3 1/2[89]	9[229]	6	18
Z8706-PC	1 1/4[32]	1 1/4[32]	20	10[254]	2 1/2[64]	7 1/2[191]	12	24
Z8707-PC	1 1/4[32]	1 1/2[38]	20	10 1/2[267]	3[76]	7 1/2[191]	12	24
Z8708-PC*	1 1/2[38]	1 1/2[38]	20	10 1/2[267]	3[76]	7 1/2[191]	12	24

OPTIONAL ACCESSORIES

Suffix	Description
-B	Brass Nuts
-BX	Box Escutcheon
-CE	Cast Brass Escutcheon with Setscrew
-D	Deep Escutcheon (Note = not available for Z8703B-PC and Z8704B-PC)
-J	Metal to Metal Ground Joint Connection
-WC	Waste Connections - Compression
-15	15[381] C Dim. 1 1/4[32] and 1 1/2[38] Only
-18	18[457] C Dim. 1 1/4[32] and 1 1/2[38] Only

* COMES WITH OPTIONAL 1-1/2" x 1-1/4" REDUCTION POLY-WASHER FOR INLET

** SHIPPED WITH BRASS NUTS UNLESS OTHERWISE SPECIFIED

ZURN INDUSTRIES, LLC ♦ COMMERCIAL BRASS OPERATION ♦ 2640 SOUTH WORK STREET ♦ FALCONER NY 14733

Phone: 1-800-997-3876 ♦ Fax: 1-919-775-3541 ♦ www.zurn.com

In Canada: ZURN INDUSTRIES LIMITED ♦ 3544 Nashua Drive ♦ Mississauga, Ontario L4V1L2 ♦ Phone: 905/405-8272 Fax: 905/405-1292



AFWALL® MILLENNIUM™ FloWise® ELONGATED FLUSHOMETER TOILET

VITREOUS CHINA with EVERCLEAN®

AFWALL® MILLENNIUM™ FloWise® ELONGATED FLUSHOMETER TOILET with EVERCLEAN®

- Wall-mounted flushometer valve toilet
- Vitreous china
- High Efficiency, Low Consumption. Operates in the range of 1.1 gpf to 1.6 gpf (4.2 Lpf to 6.0 Lpf)
- Meets definition of HET (High Efficiency Toilet) when used with a high efficiency flush valve (1.1 gpf - 1.6 gpf or 1.28/1.1 gpf dual flush)
- Maximum Performance (MaP) score of 1,000 grams at 1.1 gpf - 1.6 gpf
- Permanent EverClean® antimicrobial surface inhibits the growth of stain- and odor-causing bacteria, mold, and mildew on the surface
- Condensation channel
- Concealed trapway design
- Elongated bowl
- Powerful direct-fed siphon jet action
- 1-1/2" inlet spud
- Fully-glazed 2-1/8" trapway
- 10" x 12" water surface area
- Static weight load of 1,000 lbs.*
- 100% factory flush tested

- ✓ **3351.101** Elongated bowl only, top spud
- ☐ **3352.101** Elongated bowl only, top spud with slotted rim for bedpan holding
- ☐ **3353.101** Elongated bowl only, back spud
- ☐ **3354.101** Elongated bowl only, back spud with slotted rim for bedpan holding

System MaP* Score:

- 1,000 grams of miso @ 1.1 gpf to 1.6 gpf when used with an American Standard flush valve

* Maximum Performance (MaP) testing performed by IAPMO R&T Lab. MaP Report conducted by Veritec Consulting, Inc. and Koeller and Company.

Component Parts:

- ✓ **047007-0070A** Inlet Spud (furnished with bowl)

Nominal Dimensions:

660 x 356 x 381mm
(26" x 14" x 15")

Recommended working pressure—between 25 psi at valve when flushing and 80 psi static

✓ Fixture only, less seat, bolt caps, and flushometer valve

Compliance Certifications -

Meets or Exceeds the Following Specifications:

- ASME A112.19.2/CSA B45.1 for Vitreous China Fixtures

* This product is not recommended for bariatric use.



SEE REVERSE FOR ROUGHING-IN DIMENSIONS

To Be Specified:

- ✓ Color: ✓ White
- ☐ Seat:
 - ☐ American Standard #5901.100 Heavy duty open front less cover
 - ☐ American Standard #5905.100 Extra heavy duty open front less cover
- ☐ Flushometer Valve:
 - ☐ 1.6 gpf:
 - ☐ Sensor-Operated: American Standard Selectronic® DC Power #6065.161.002 (Top Spud)
AC Power #6067.161.002 (Top Spud)
 - ☐ Manual: American Standard #6047.161.002 (Top Spud)
 - ☐ 1.28 gpf:
 - ☐ Sensor-Operated: American Standard Selectronic® DC Power #6065.121.002 (Top Spud)
AC Power #6067.121.002 (Top Spud)
 - ☐ Manual: American Standard #6047.121.002 (Top Spud)
 - ☐ 1.6 / 1.1 gpf Dual Flush:
 - ☐ Sensor-Operated: American Standard Selectronic® DC Power #6065.761.002 (Top Spud)
AC Power #6067.761.002 (Top Spud)
 - ☐ 1.28 / 1.1 gpf Dual Flush:
 - ☐ Sensor-Operated: American Standard Selectronic® DC Power #6065.721.002 (Top Spud)
AC Power #6067.721.002 (Top Spud)



MEETS THE AMERICANS WITH DISABILITIES ACT GUIDELINES AND ANSI A117.1 REQUIREMENTS FOR ACCESSIBLE AND USABLE BUILDING FACILITIES - CHECK LOCAL CODES.

- When installed so top of seat is 432 to 483mm (17" to 19") from the finished floor.

EVERCLEAN®
Surface



**AFWALL® MILLENNIUM™ FloWise®
ELONGATED FLUSHOMETER TOILET**
VITREOUS CHINA with EVERCLEAN®

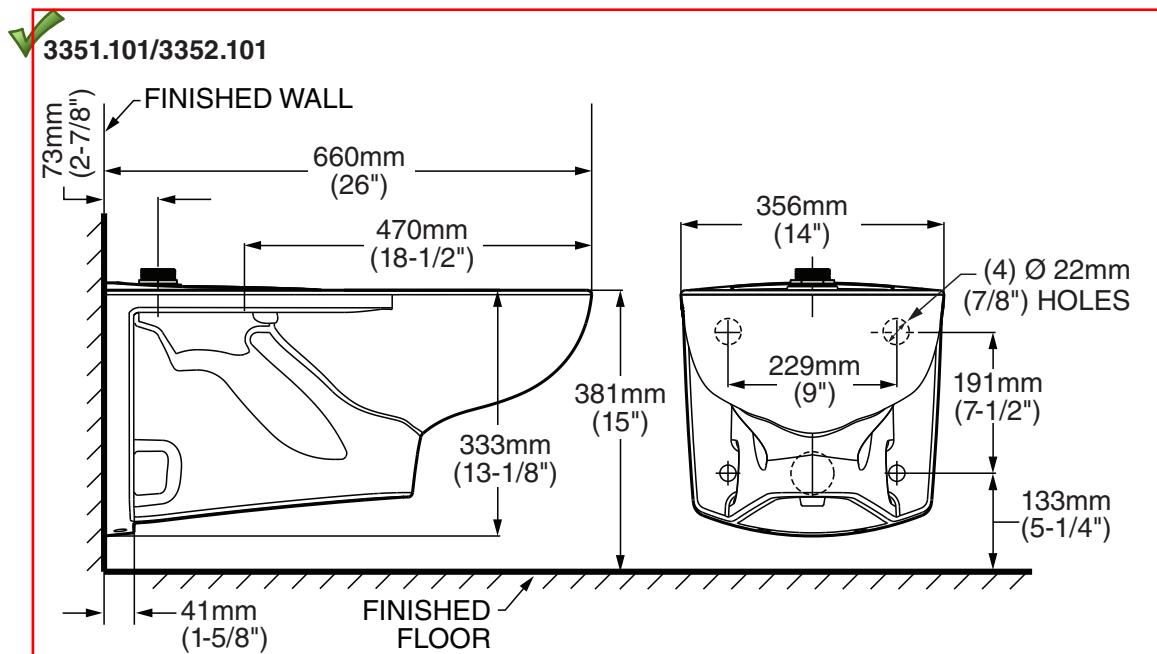

3353.101/3354.101

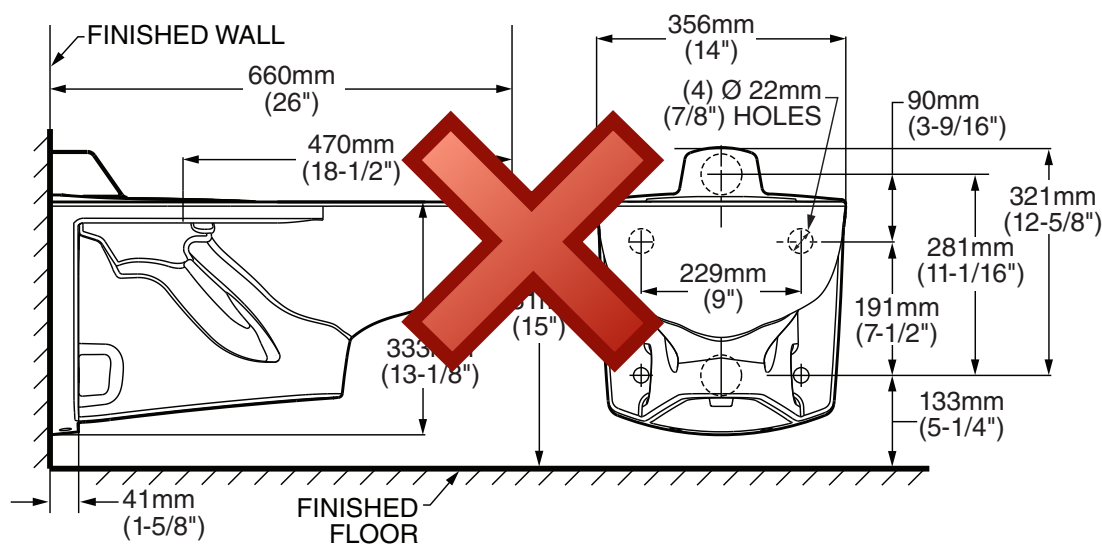

NOTES:

- Toilet designed to meet ADA accessibility standards when top of seat height set at 432 to 483mm (17" to 19") from finished floor.

PRODUCT 3351 AND 3353 SHOWN, 3352 AND 3354 SAME EXCEPT WITH SLOTTED RIM FOR BED PAN HOLDING.

PRODUCT 3331 AND 3333 SHOWN; 3332 AND 3334 SAME EXCEPT WITH SEATED RIM FOR BED PANTY HOLE.
WASTE OUTLET SEAL RING MUST BE NEOPRENE OR GRAPHITE-FELT (WAX RING NOT RECOMMENDED).

SUGGESTED 2mm (1/16) CLEARANCE BETWEEN FACE OF WALL AND BACK OF BOWL.

TO COMPLY WITH AREA CODE GOVERNING THE HEIGHT OF VACUUM BREAKER ON THE FLUSHOMETER VALVE, THE PLUMBER MUST VERIFY DIMENSIONS SHOWN FOR SUPPLY ROUGHING.

FLUSHOMETER VALVE NOT INCLUDED WITH FIXTURE AND MUST BE ORDERED SEPARATELY.

TECHNOMETER VALVE NOT INCLUDED WITH FIXTURE AND MOST CARRIER FITTING AS REQUIRED TO BE FURNISHED BY OTHERS.

PROVIDE SUITABLE REINFORCEMENT FOR ALL WALL SUPPORT.

IMPORTANT: Dimensions of fixtures are nominal and may vary within the range of tolerances established by ANSI Standard A11.19.2. These measurements are subject to change or cancellation. No responsibility is assumed for use of superseded or voided pages

*American
Standard*

SELECTRONIC® SENSOR OPERATED URINAL FLUSH VALVE

HARD-WIRED AC POWER, BASE MODEL

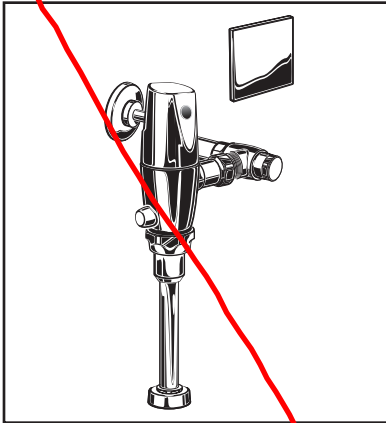

GENERAL DESCRIPTION:

Exposed, Sensor Operated Selectronic® Urinal Flush Valve for 3/4" top spud urinals.

Inlet includes 3/4" I.P.S. angle stop with back-flow protection, vandal-resistant cap, sweat solder kit, cover tube and wall flange.

Outlet includes 3/4" vacuum breaker, spud coupling and flange.

PRODUCT FEATURES:

- Exclusive Pressure Compensation feature eliminates the need for the installer to adjust the stop valves, saving time and money and ensuring water savings
- Electronic flush valve with Selectronic® proximity system for "Hands Free" operation
- Self-Cleaning Piston operation with integral wiper spring prevents clogging and reduces maintenance
- Piston operation delivers superior flush accuracy and repeatability
- Adjustable tailpiece
- Chemical resistant EPDM seals are unaffected by chloramines and ammonia
- Valve remains closed and does not need to be reset after loss of power or water pressure
- Stadium Feature: Valve automatically switches to water conservation mode during periods of heavy usage
- Fully Mechanical Manual Override Button can flush toilet during a power outage
- Vandal-resistant metal cover plate (for 2-gang electric box supplied by others) with no visible fasteners
- Sensor & electronic controls are fully enclosed and water resistant
- Range can be adjusted manually or by remote control
- Sanitary Flush - Valve automatically flushes after 24 hours of non-use to clean fixture & maintain trap seal
- No external volume adjustment
- 5 second Arming Delay prevents unintentional flushing
- 3-second Flush Delay
- Can be installed left or right-handed

BASE MODEL: (Does Not include Power Supply)

- ✓ **606B.101** Base Model, 1.0 gpf
For use with Hard-Wired AC or Multi-AC power kits. 11-1/2" rough-in



- ❑ **606B.051** Base Model, 0.5 gpf
SAME AS ABOVE



- ❑ **606B.025** Base Model, 0.25 gpf
SAME AS ABOVE



- ❑ **606B.013** Base Model, 0.125 gpf
SAME AS ABOVE

POWER KITS: (Must be Purchased Separately)

- ❑ **PK00.HAC** Hard-Wired AC transformer, 10' extension cable and capacitor module
- ❑ **PK00.MAC** Multi-AC adapter and 10" extension cable

OPERATING PRESSURE:
20 psi (flowing) - 80 psi (static)

FLOW REQUIREMENT:
10 gpm (37.9 L/min.)

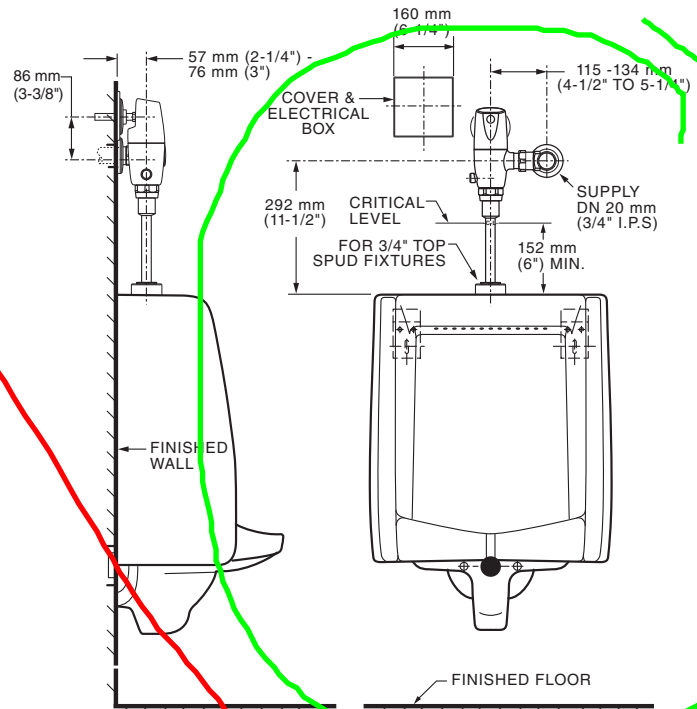

Meets the American Disabilities Act Guidelines and ANSI A17.1 Requirements for accessible and usable building facilities - check local codes

RECOMMENDED SPECIFICATION:

Electronic proximity infrared sensor activated toilet flush valve shall feature self-cleaning piston valve. Includes a fully mechanical manual over-ride that can provide a complete flush without power. Includes cast brass valve body and metal cover with chrome finish and vandal resistant stop cap. Angle stop with back-flow protection and vacuum breaker included. Flush valve shall be American Standard Model # 606B.____.002

*American
Standard*

SELETRONIC® SENSOR OPERATED URINAL FLUSH VALVE HARD-WIRED AC POWER, BASE MODEL

LISTINGS:

- ASSE 1037
- ANSI/ASME A112.19.2
- ADA Compliant

Roughing-in Dimensions

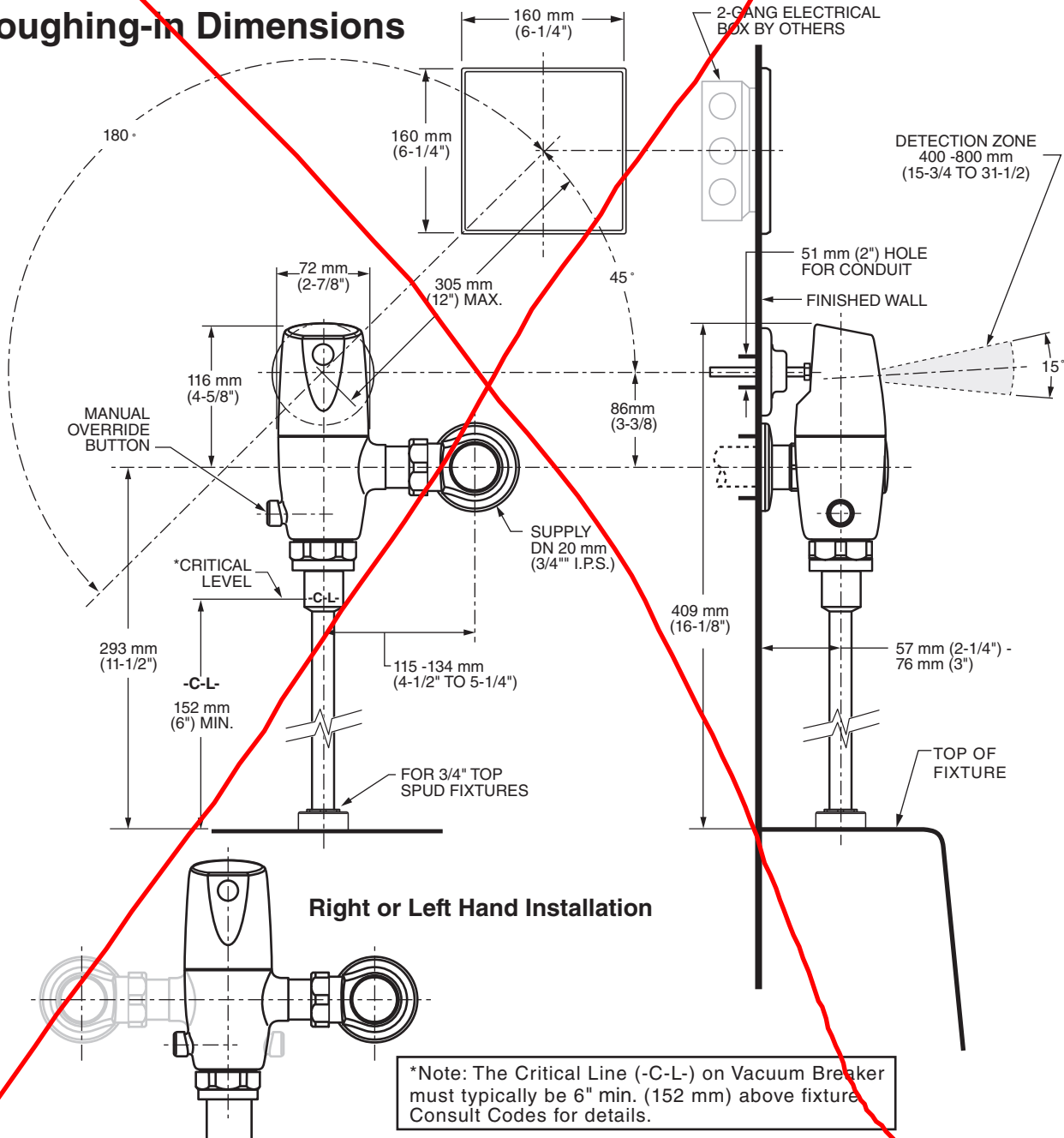

Meets the American Disabilities Act Guidelines and ANSI A117.1 Requirements for accessible and usable building facilities - check local codes

PART OF LIXIL

COMMERCIAL HEAVY DUTY

Product Specifications

Shape	Elongated
Seat Material	Polypropylene
Seat Form	Open front
Commercial Hinge	Yes
Bolt Material	Stainless steel
Hardware Material	Stainless Steel
Check Hinge	Yes
Cover	No
Custom Gasket	Yes
Color	White

Warranty	1 year limited warranty
----------	-------------------------

Available Colors

✓ White, black, crane white, bone, biscuit,

Features

Commercial Hinge

Includes commercial grade hinges. One piece solid metal hinge pin and bolt over molded with plastic.

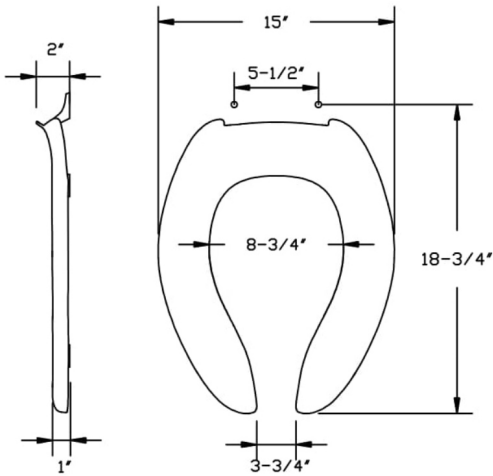
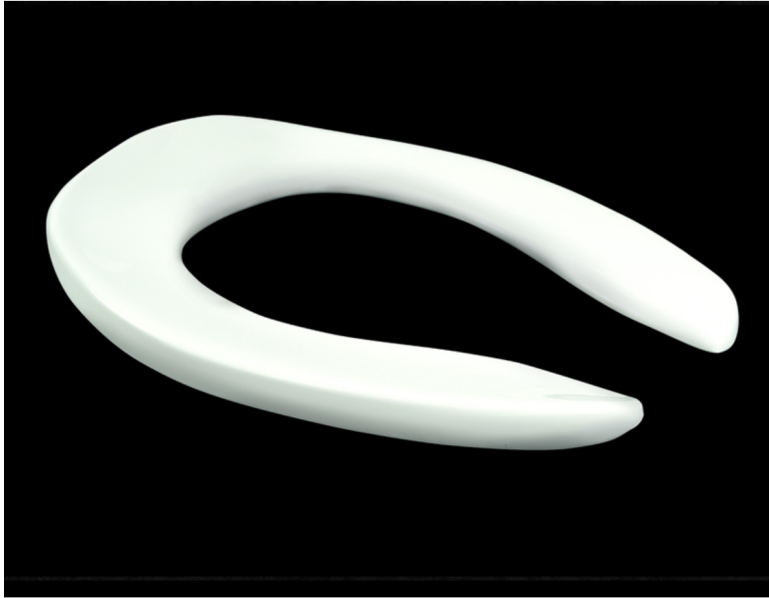

Dimensions shown are nominal and may vary within a range of tolerance. Product specifications are subject to change without notice.



AC POWER KITS FOR SELECTRONIC BASE FAUCETS & FLUSH VALVES

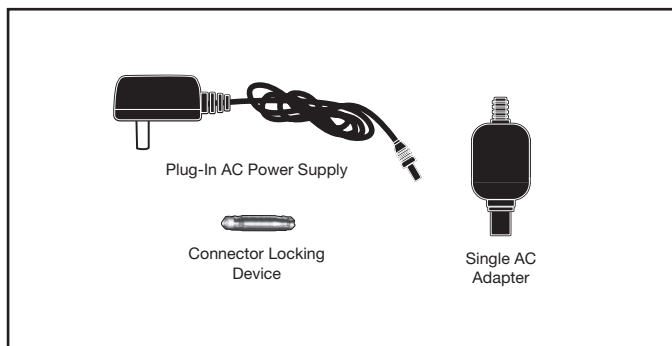

MODEL NUMBER:

❑ PK00.PAC Plug-In AC Power Kit

Includes universal Plug-In AC power supply with 6' long power cord, single AC adapter and connector locking device.

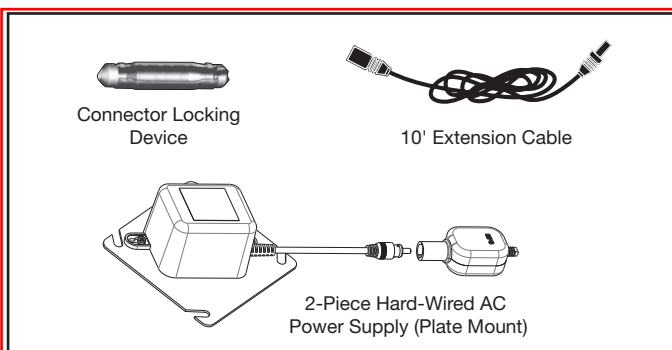

✓ PK00.HAC Hard-Wired AC Power Kit

Includes 2-Piece Hard-Wired AC power supply (plate mount), 10' extension cord, and connector locking device.

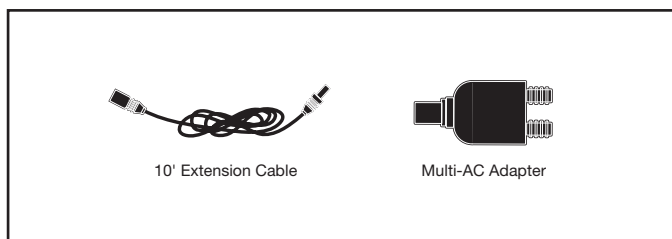

❑ PK00.MAC Multi-AC Power Kit

Includes 10' extension cord and multi-AC adapter. One AC power supply can power up to 15 Selectronic faucets and/or flush valves at one time in a daisy chain configuration.

FOR USE WITH SELECTRONIC BASE FAUCET & FLUSH VALVE MODELS

FEATURES:

Plug-In AC: Class 2 UL certified universal Plug-In AC power supply with 6' long power cord.

Input Voltage: 100 - 240 VAC, 50 / 60 Hz

Hard-Wired AC: Class 2 UL certified Hard-Wired AC transformer (electrical box by others). Includes 10' extension cable to allow for remote installation of transformer. **Input Voltage:** 120 VAC, 60 Hz

Multi-AC: One AC transformer (plug-in or hard-wire) can power up to 15 faucets and/or flush valves in a daisy chain configuration. 10' maximum distance between units. **SEPARATE AC POWER KIT REQUIRED.**

Fail-Safe: Faucet and/or flush valve automatically shuts off upon loss of AC power. Prevents costly excess water usage and potential flooding.

Connector Locking Device: Secures connection of power supply to sensor. Prevents disconnection.

ONE POWER KIT REQUIRED FOR EACH FAUCET AND FLUSH VALVE

PART OF **LIXIL**



AFWALL® MILLENNIUM™ FloWise® ELONGATED FLUSHOMETER TOILET

VITREOUS CHINA with EVERCLEAN®

AFWALL® MILLENNIUM™ FloWise® ELONGATED FLUSHOMETER TOILET with EVERCLEAN®

- Wall-mounted flushometer valve toilet
- Vitreous china
- High Efficiency, Low Consumption. Operates in the range of 1.1 gpf to 1.6 gpf (4.2 Lpf to 6.0 Lpf)
- Meets definition of HET (High Efficiency Toilet) when used with a high efficiency flush valve (1.1 gpf - 1.6 gpf or 1.28/1.1 gpf dual flush)
- Maximum Performance (MaP) score of 1,000 grams at 1.1 gpf - 1.6 gpf
- Permanent EverClean® antimicrobial surface inhibits the growth of stain- and odor-causing bacteria, mold, and mildew on the surface
- Condensation channel
- Concealed trapway design
- Elongated bowl
- Powerful direct-fed siphon jet action
- 1-1/2" inlet spud
- Fully-glazed 2-1/8" trapway
- 10" x 12" water surface area
- Static weight load of 1,000 lbs.*
- 100% factory flush tested

- ✓ **3351.101** Elongated bowl only, top spud
- ☐ **3352.101** Elongated bowl only, top spud with slotted rim for bedpan holding
- ☐ **3353.101** Elongated bowl only, back spud
- ☐ **3354.101** Elongated bowl only, back spud with slotted rim for bedpan holding

System MaP* Score:

- 1,000 grams of miso @ 1.1 gpf to 1.6 gpf when used with an American Standard flush valve

* Maximum Performance (MaP) testing performed by IAPMO R&T Lab. MaP Report conducted by Veritec Consulting, Inc. and Koeller and Company.

Component Parts:

- ✓ **047007-0070A** Inlet Spud (furnished with bowl)

Nominal Dimensions:

660 x 356 x 381mm
(26" x 14" x 15")

Recommended working pressure—between 25 psi at valve when flushing and 80 psi static

✓ Fixture only, less seat, bolt caps, and flushometer valve

Compliance Certifications -

Meets or Exceeds the Following Specifications:

- ASME A112.19.2/CSA B45.1 for Vitreous China Fixtures

* This product is not recommended for bariatric use.



SEE REVERSE FOR ROUGHING-IN DIMENSIONS

To Be Specified:

- ✓ Color: ✓ White
- ☐ Seat:
 - ☐ American Standard #5901.100 Heavy duty open front less cover
 - ☐ American Standard #5905.100 Extra heavy duty open front less cover
- ☐ Flushometer Valve:
 - ☐ 1.6 gpf:
 - ☐ Sensor-Operated: American Standard Selectronic® DC Power #6065.161.002 (Top Spud)
AC Power #6067.161.002 (Top Spud)
 - ☐ Manual: American Standard #6047.161.002 (Top Spud)
 - ☐ 1.28 gpf:
 - ☐ Sensor-Operated: American Standard Selectronic® DC Power #6065.121.002 (Top Spud)
AC Power #6067.121.002 (Top Spud)
 - ☐ Manual: American Standard #6047.121.002 (Top Spud)
 - ☐ 1.6 / 1.1 gpf Dual Flush:
 - ☐ Sensor-Operated: American Standard Selectronic® DC Power #6065.761.002 (Top Spud)
AC Power #6067.761.002 (Top Spud)
 - ☐ 1.28 / 1.1 gpf Dual Flush:
 - ☐ Sensor-Operated: American Standard Selectronic® DC Power #6065.721.002 (Top Spud)
AC Power #6067.721.002 (Top Spud)



MEETS THE AMERICANS WITH DISABILITIES ACT GUIDELINES AND ANSI A117.1 REQUIREMENTS FOR ACCESSIBLE AND USABLE BUILDING FACILITIES - CHECK LOCAL CODES.

- When installed so top of seat is 432 to 483mm (17" to 19") from the finished floor.

EVERCLEAN®
Surface



*American
Standard*

BARrier FREE

AFWALL® MILLENNIUM™ FloWise® ELONGATED FLUSHOMETER TOILET

VITREOUS CHINA with EVERCLEAN®

3351.101/3352.101

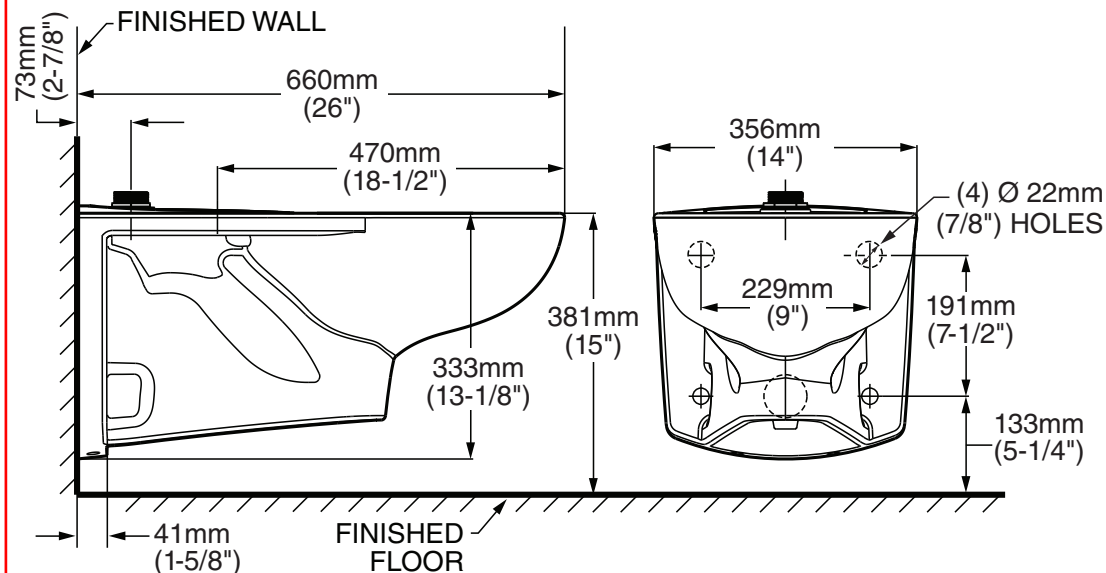

3353.101/3354.101

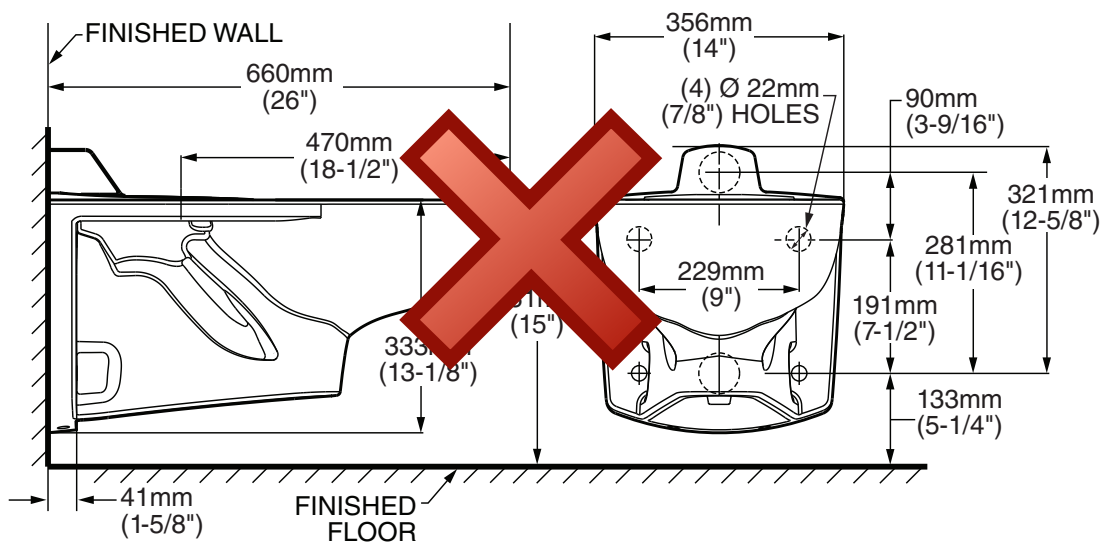

NOTES:

● Toilet designed to meet ADA accessibility standards when top of seat height set at 432 to 483mm (17" to 19") from finished floor.

PRODUCT 3351 AND 3353 SHOWN, 3352 AND 3354 SAME EXCEPT WITH SLOTTED RIM FOR BED PAN HOLDING.

WASTE OUTLET SEAL RING MUST BE NEOPRENE OR GRAPHITE-FELT (WAX RING NOT RECOMMENDED).

SUGGESTED 2mm (1/16") CLEARANCE BETWEEN FACE OF WALL AND BACK OF BOWL.

TO COMPLY WITH AREA CODE GOVERNING THE HEIGHT OF VACUUM BREAKER ON THE FLUSHOMETER VALVE, THE PLUMBER MUST VERIFY DIMENSIONS SHOWN FOR SUPPLY ROUGHING.

FLUSHOMETER VALVE NOT INCLUDED WITH FIXTURE AND MUST BE ORDERED SEPARATELY.

CARRIER FITTING AS REQUIRED TO BE FURNISHED BY OTHERS.

PROVIDE SUITABLE REINFORCEMENT FOR ALL WALL SUPPORT.

IMPORTANT: Dimensions of fixtures are nominal and may vary within the range of tolerances established by ANSI Standard A112.19.2.

These measurements are subject to change or cancellation. No responsibility is assumed for use of superseded or voided pages

*American
Standard*

SELECTRONIC® SENSOR OPERATED URINAL FLUSH VALVE

HARD-WIRED AC POWER, BASE MODEL

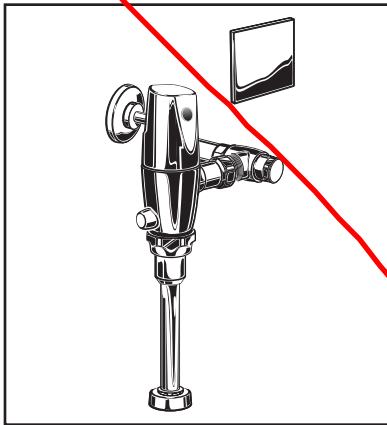

GENERAL DESCRIPTION:

Exposed, Sensor Operated Selectronic® Urinal Flush Valve for 3/4" top spud urinals.

Inlet includes 3/4" I.P.S. angle stop with back-flow protection, vandal-resistant cap, sweat solder kit, cover tube and wall flange.

Outlet includes 3/4" vacuum breaker, spud coupling and flange.

PRODUCT FEATURES:

- Exclusive Pressure Compensation feature eliminates the need for the installer to adjust the stop valves, saving time and money and ensuring water savings
- Electronic flush valve with Selectronic® proximity system for "Hands Free" operation
- Self-Cleaning Piston operation with integral wiper spring prevents clogging and reduces maintenance
- Piston operation delivers superior flush accuracy and repeatability
- Adjustable tailpiece
- Chemical resistant EPDM seals are unaffected by chloramines and ammonia
- Valve remains closed and does not need to be reset after loss of power or water pressure
- Stadium Feature: Valve automatically switches to water conservation mode during periods of heavy usage
- Fully Mechanical Manual Override Button can flush toilet during a power outage
- Vandal-resistant metal cover plate (for 2-gang electric box supplied by others) with no visible fasteners
- Sensor & electronic controls are fully enclosed and water resistant
- Range can be adjusted manually or by remote control
- Sanitary Flush - Valve automatically flushes after 24 hours of non-use to clean fixture & maintain trap seal
- No external volume adjustment
- 5 second Arming Delay prevents unintentional flushing
- 3-second Flush Delay
- Can be installed left or right-handed

BASE MODEL: (Does Not include Power Supply)

- ✓ **606B.101** Base Model, 1.0 gpf
For use with Hard-Wired AC or Multi-AC power kits. 11-1/2" rough-in



- ❑ **606B.051** Base Model, 0.5 gpf
SAME AS ABOVE



- ❑ **606B.025** Base Model, 0.25 gpf
SAME AS ABOVE



- ❑ **606B.013** Base Model, 0.125 gpf
SAME AS ABOVE

POWER KITS: (Must be Purchased Separately)

- ❑ **PK00.HAC** Hard-Wired AC transformer, 10' extension cable and capacitor module
- ❑ **PK00.MAC** Multi-AC adapter and 10" extension cable

OPERATING PRESSURE:

20 psi (flowing) - 80 psi (static)

FLOW REQUIREMENT:

10 gpm (37.9 L/min.)

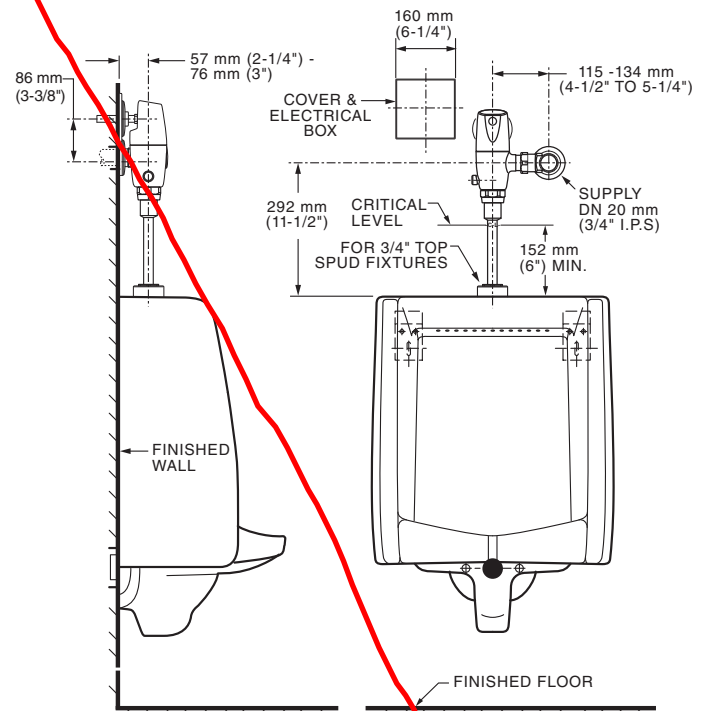

Meets the American Disabilities Act Guidelines and **ANSI A117.1** Requirements for accessible and usable building facilities - check local codes

RECOMMENDED SPECIFICATION:

Electronic proximity infrared sensor activated toilet flush valve shall feature self-cleaning piston valve. Includes a fully mechanical manual override that can provide a complete flush without power. Includes cast brass valve body and metal cover with chrome finish and vandal resistant stop cap. Angle stop with back-flow protection and vacuum breaker included. Flush valve shall be American Standard Model # 606B____.002

*American
Standard*

SELETRONIC® SENSOR OPERATED URINAL FLUSH VALVE HARD-WIRED AC POWER, BASE MODEL

LISTINGS:

- ASSE 1037
- ANSI/ASME A112.19.2
- ADA Compliant

Roughing-in Dimensions

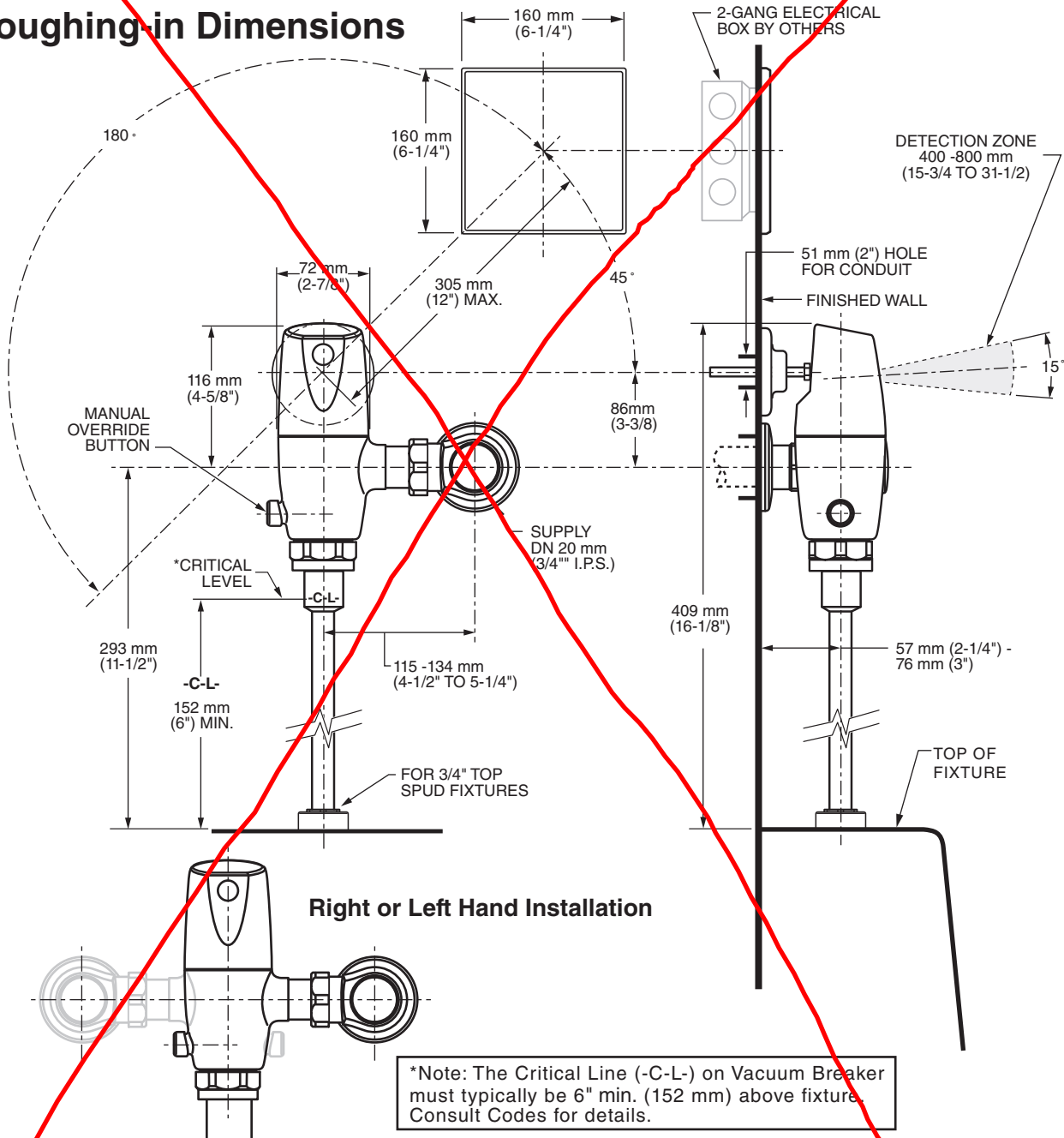

Meets the American Disabilities Act Guidelines and **ANSI A117.1** Requirements for accessible and usable building facilities - check local codes

PART OF **LIXIL**

COMMERCIAL HEAVY DUTY

Product Specifications

Shape	Elongated
Seat Material	Polypropylene
Seat Form	Open front
Commercial Hinge	Yes
Bolt Material	Stainless steel
Hardware Material	Stainless Steel
Check Hinge	Yes
Cover	No
Custom Gasket	Yes
Color	White

Warranty	1 year limited warranty
----------	-------------------------

Available Colors

✓ White, black, crane white, bone, biscuit,

Features

Commercial Hinge

Includes commercial grade hinges. One piece solid metal hinge pin and bolt over molded with plastic.

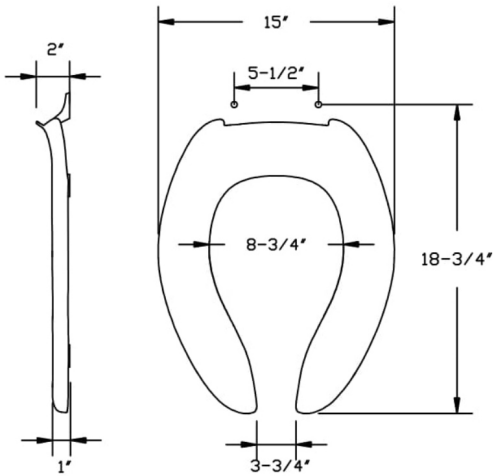
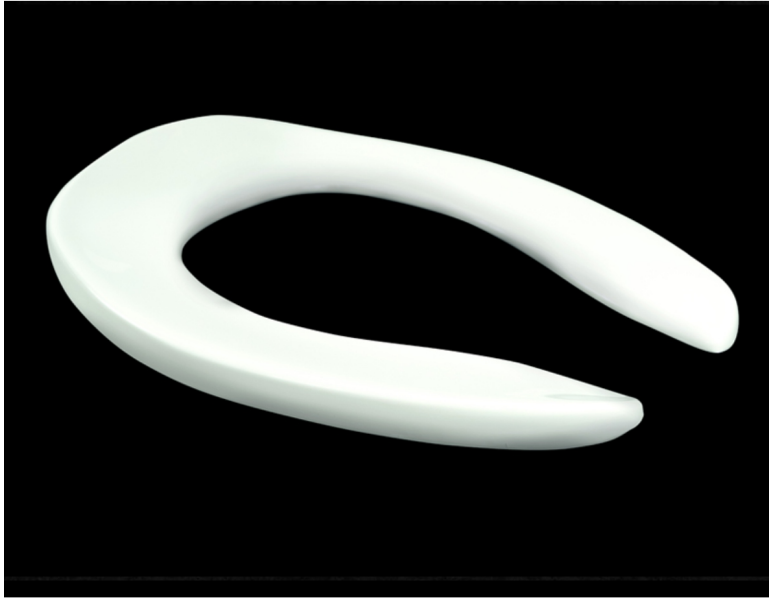

Dimensions shown are nominal and may vary within a range of tolerance. Product specifications are subject to change without notice.



AC POWER KITS FOR SELECTRONIC BASE FAUCETS & FLUSH VALVES

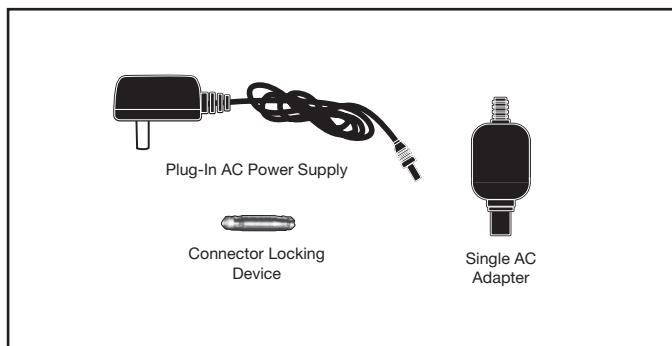

MODEL NUMBER:

❑ PK00.PAC Plug-In AC Power Kit

Includes universal Plug-In AC power supply with 6' long power cord, single AC adapter and connector locking device.

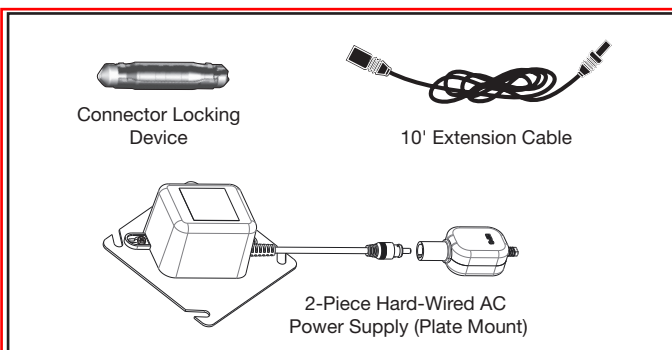

✓ PK00.HAC Hard-Wired AC Power Kit

Includes 2-Piece Hard-Wired AC power supply (plate mount), 10' extension cord, and connector locking device.

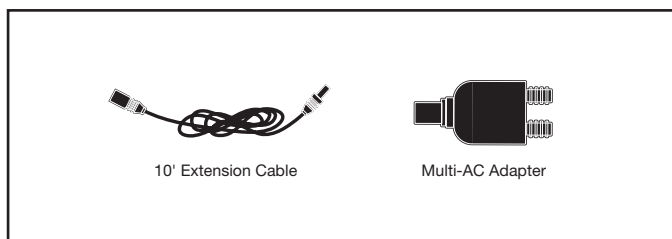

❑ PK00.MAC Multi-AC Power Kit

Includes 10' extension cord and multi-AC adapter. One AC power supply can power up to 15 Selectronic faucets and/or flush valves at one time in a daisy chain configuration.

FOR USE WITH SELECTRONIC BASE FAUCET & FLUSH VALVE MODELS

FEATURES:

Plug-In AC: Class 2 UL certified universal Plug-In AC power supply with 6' long power cord.

Input Voltage: 100 - 240 VAC, 50 / 60 Hz

Hard-Wired AC: Class 2 UL certified Hard-Wired AC transformer (electrical box by others). Includes 10' extension cable to allow for remote installation of transformer. **Input Voltage:** 120 VAC, 60 Hz

Multi-AC: One AC transformer (plug-in or hard-wire) can power up to 15 faucets and/or flush valves in a daisy chain configuration. 10' maximum distance between units. **SEPARATE AC POWER KIT REQUIRED.**

Fail-Safe: Faucet and/or flush valve automatically shuts off upon loss of AC power. Prevents costly excess water usage and potential flooding.

Connector Locking Device: Secures connection of power supply to sensor. Prevents disconnection.

ONE POWER KIT REQUIRED FOR EACH FAUCET AND FLUSH VALVE

PART OF **LIXIL**



Washbrook® FloWise® Universal Urinal VITREOUS CHINA



Washbrook® FloWise® Universal Urinal

- Vitreous china
- Ultra High Efficiency, Low Consumption. Operates in the range of 0.125gpf to 1.0gpf (0.5 Lpf to 3.8 Lpf)
- Flushing rim
- Elongated 14" rim from finished wall
- Washout flush action
- Extended sides for privacy
- 3/4" inlet spud
- Outlet connection threaded 2" inside (NPTF)
- 2 wall hangers
- Fixture only
- Strainer included
- Meets ASME flush requirements at 0.125 to 1.0 gpf



6590.001 Universal Top spud

☐ **6515.001** Universal Back spud

Nominal Dimensions:

360 x 480 x 664mm

(14-1/8" x 18-7/8" x 26-1/8")

Recommended working pressure – between
20 psi at valve when flushing and 80 psi static

Compliance Certifications -

Meets or Exceeds the Following Specifications:

- ASME A112.19.2-2008/CSA B45.1-08 for Vitreous China Fixtures



SEE REVERSE FOR ROUGHING-IN DIMENSIONS

To Be Specified:

☒ Color: ☒ White

☐ Flush Valve:

1.0 gpf Flush Valve: Sensor-Operated:

☐ American Standard Selectronic® #6063.101.002
DC Power (Top Spud)

☐ American Standard Selectronic® #6062.101.002
AC Power (Back Spud)

1.0 gpf Flush Valve: Manual-Operated:

☐ American Standard # 6045.101.002

0.5 gpf Flush Valve: Sensor-Operated:

☐ American Standard Selectronic® #6063.051.002
DC Power (Top Spud)

☐ American Standard Selectronic® #6062.051.002
AC Power (Back Spud)

0.5 gpf Flush Valve: Manual-Operated:

☐ American Standard #6045.051.002

0.125 gpf Flush Valve: Sensor-Operated:

☐ American Standard Selectronic® #6063.013.002
DC Power (Top Spud)

☐ American Standard Selectronic® #6062.013.002
AC Power (Back Spud)

0.125 gpf Flush Valve: Manual-Operated:

☐ American Standard #6045.013.002



MEETS THE AMERICANS WITH DISABILITIES ACT GUIDELINES
AND ANSI A117.1 ACCESSIBLE AND USABLE BUILDINGS AND
FACILITIES - CHECK LOCAL CODES.

- When installed so top of rim is 432mm (17") MAXIMUM from finished floor.



When used with
0.125 gpf
urinal flush valve



When used with
0.125 or 0.5 gpf
urinal flush valve



ADA
COMPLIANT

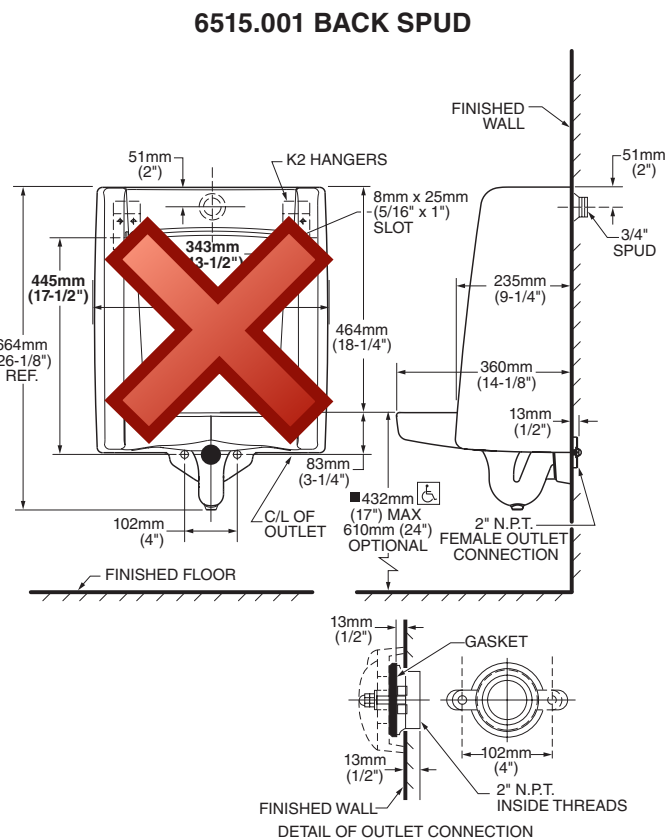
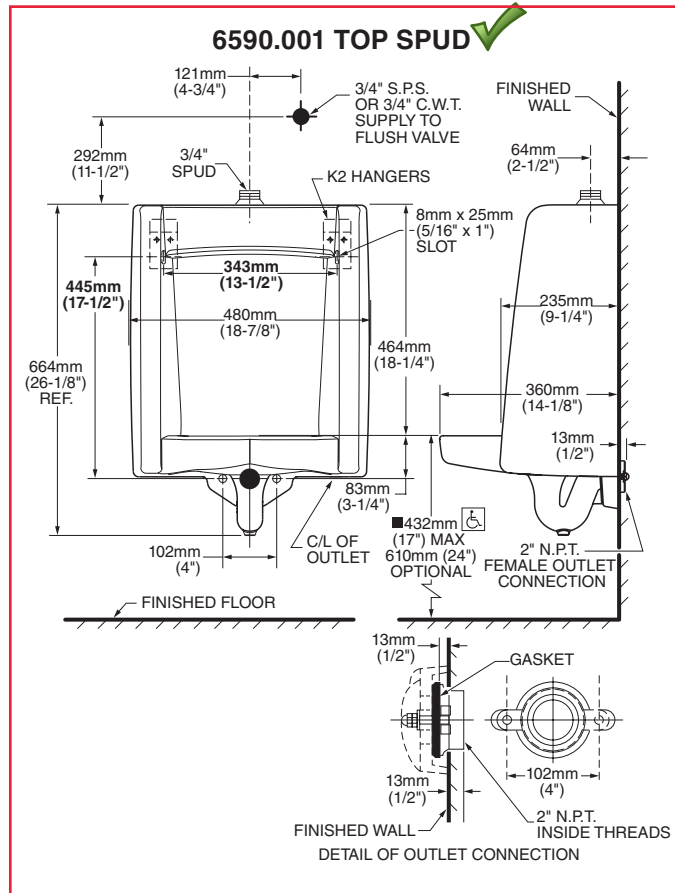

**MEETS THE AMERICANS WITH DISABILITIES ACT GUIDELINES
AND ANSI A117.1 ACCESSIBLE AND USABLE BUILDINGS AND
FACILITIES - CHECK LOCAL CODES.**

- When installed so top of rim is 432mm (17") MAXIMUM from finished floor.

NOTES:

NOTES:
FLUSH VALVE NOT INCLUDED AND MUST BE ORDERED SEPARATELY.
PROVIDE SUITABLE REINFORCEMENT FOR ALL WALL SUPPORTS.

IMPORTANT: Dimensions of fixtures are nominal and may vary within the range of tolerances established by ANSI Standard A112.19.2. These measurements are subject to change or cancellation. No responsibility is assumed for use of superseded or voided pages.

CODE NUMBER

3782695

DESCRIPTION

0.125 gpf, Polished Chrome Finish, Single Flush, Hardwired, Sloan® Exposed Sensor Flushometer.

DETAILS

- Flush Volume: 0.125 gpf (0.5 Lpf) (0.125)
- Finish: Polished Chrome (CP)
- Power Type: Hardwired (HW)
- Valve: Diaphragm
- Valve Body Material: Semi-red Brass
- Fixture Type: Urinal
- Fixture Connection: Top
- Rough-In Dimension: 11 ½" (292mm)
- Spud Coupling: ¾" (19mm)
- Supply Pipe: ¾" (19mm)

FEATURES

- PERMEX® High-Efficiency Synthetic Rubber Diaphragm with Linear Filtered Bypass with Vortex Cleansing Action™
- Handle Packing, Main Seat, Stop Seat and Vacuum Breaker Molded from PERMEX® Rubber Compound for Chloramine resistance
- "User in View" Flashing LED
- No External Volume Adjustment to Ensure Water Conservation
- True Mechanical Override Flush Button
- 72-Hour Sentinel Flush
- Sweat Solder Adapter w/Cover Tube and Cast Wall Flange with Set Screw
- 3/4" IPS screwdriver Bak-Chek® angle stop with vandal resistant stop cap

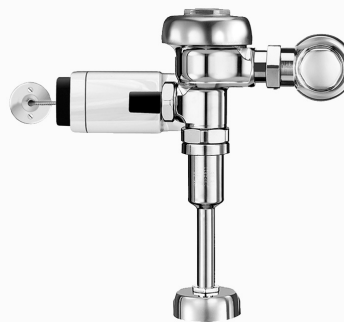
**COMPLIANCES & CERTIFICATIONS**

(ADA Compliant, cUPC Certified, WaterSense Listed, BAA Compliant, UL Certified, Satisfies LEED Credits)

RECOMMENDED SPECIFICATION

Valve Body, Cover, Tailpiece and Control Stop shall be in conformance with ASTM Alloy Classification for Semi- Red Brass. Valve shall be in compliance with the applicable sections of ASSE 1037 and ANSI/ASME 112.19.2.

VALVE OPERATING PRESSURE (FLOWING)

15–80 PSI (103–552 kPa). Specific fixtures may require greater minimum flowing pressure - consult manufacturer requirements.

DOWNLOADS

- [Sloan Exposed Installation Instructions](#)
- [Sloan Exposed \(Spanish\) Installation Instructions](#)
- [EBV-500/550-A Installation Instructions](#)
- [Control Stop Repair and Maintenance Guide](#)
- [Flush Connections Flanges Repair and Maintenance Guide](#)
- [Tail Piece Repair and Maintenance Guide](#)
- [Sloan Flushometer Repair and Maintenance Guide](#)
- [Additional Downloads](#)

NOTES

All information contained within this document subject to change without notice.

Looking for other variations of the SLOAN 186 SFSM product?
[View the general spec sheet with all options.](#)

[Find a compatible urinal](#) for this flushometer.

[Find a compatible water closet](#) for this flushometer.

ROUGH-IN

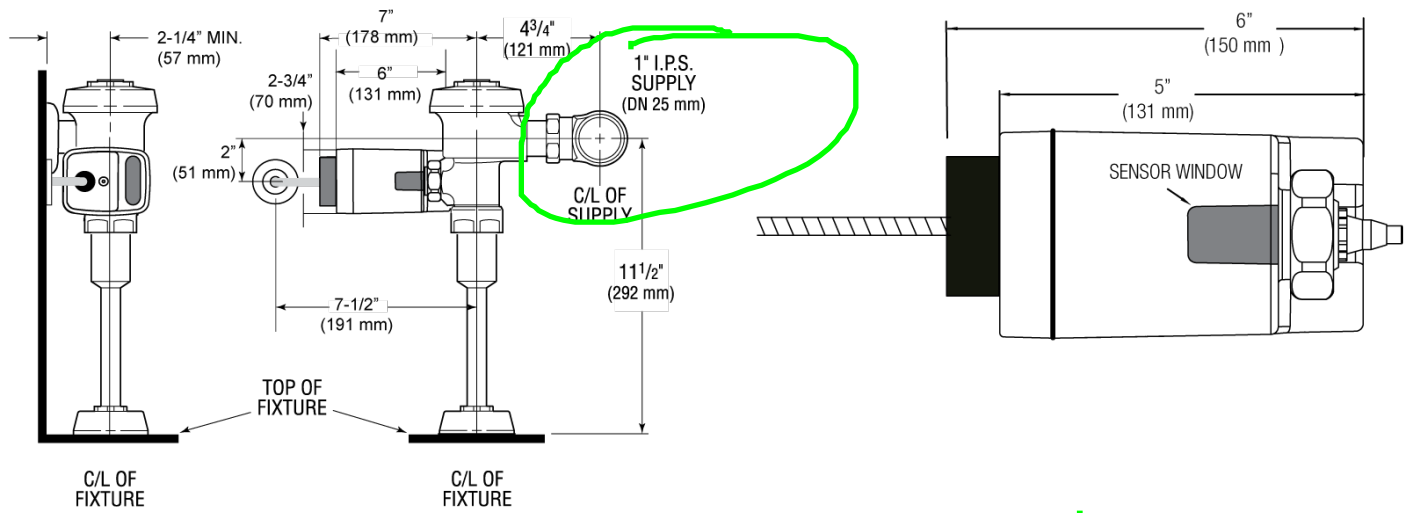

CODE NUMBER

0345154PK

DESCRIPTION

EL-154 (Box Mount) 120 VAC Input/24 VAC Output, 50/60 Hz, 50 VA.
One EL-154 transformer will power up to ten (10) OPTIMA "ES-S"
water closet or urinal (any combination) flushometers..

FEATURES

When using Sloan Optima® "ES-S" flushometers, the transformer must be specified and ordered separately. The following transformers are recommended:

- ✓ EL-154 (Box Mount) 120 V AC Input/24 V AC Output, 50/60 Hz, 50 VA (0345154PK)
- EL-342 (Box Mount) 240 V AC Input/24 V AC Output, 50/60 Hz, 50 VA (0345999PK)
- EL-208 (Foot Mount) 120 V AC Input/24 V AC Output, 50/60 Hz, 100 VA (0345095)

When using Sloan Optima® ETF or ESF Series faucets, the transformer must be specified and ordered separately. Sloan Optima® ETF Series faucets are typically supplied with a transformer. Transformers supplied with ETF Series faucets:

- ETF-416 (Plug-in - for Canada) 120 V AC Input/24 V AC Output, 50/60 Hz, 35 VA (0365879)
- ETF-233 (Plug-in) 120 V AC Input/24 V AC Output, 50/60 Hz, 35 V A (0365534PK) (not shown)
- Some Optima® faucet installations can be powered by a single transformer, provided the transformer is properly sized. Allow a minimum of 15 VA of current rating for each faucet or solenoid valve being used. Specify and order the transformer separately. To order an "ETF" Series faucet less the transformer, specify the "LT" Variation.

NOTES

All information contained within this document subject to change without notice.



UCS6805P-1 Single bowl

MODEL RANGE: COMMERCIAL SINKS | UCS6805P-1

Commercial sinks | Topmount sinks

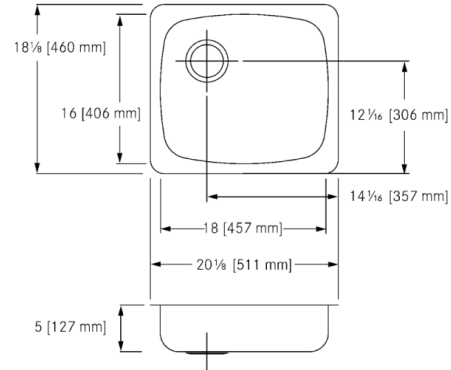

Single compartment undermount sink. 18 gauge (1.2 mm), type 304 (CNS 18/10) stainless steel. Exposed surfaces are #4 satin finished. Undercoated to reduce condensation and resonance. Includes waste fitting, cutout template, and installation hardware. Certified to ASME A112.19.3-2008 / CSA B45.4-08.

Wheelchair accessible: meets ADA (Americans with disabilities act guidelines) and ANSI A117.1 (Accessible and usable buildings and facilities). Check local codes to ensure compliance.

Left rear waste location, 3 1/2" (89 mm) crumb cup strainer with 1 1/2" (DN38) brass tailpiece.

18 1/8 x 20 1/8" Overall. 16 x 18 x 5" Bowl. (FB x LR x D).

460 x 511 mm Overall. 406 x 457 x 127 mm Bowl. (FB x LR x D).

Technical data

Bowl height	5 inch
Bowl depth	16 "
Bowl width	18 "
Overall depth	18 1/8 "
Overall width	20 1/8 "
Material	Stainless steel
Material code	1.4301 Chrome Nickel steel V2A
Tailor made	No
Tap ledge	No
Waste hole position	Left back corner
Bowl finish	Satin finish
Number of bowls	1.00000
Overflow	No
Number of tap holes	0.00000
Type of waste kit	3 1/2" crumb cup strainer
Type of basin	Single compartment

PROJECT INFORMATION

Item Location	
Project Number	
Quote Number	
Notes	

ENGINEER'S APPROVAL

*American
Standard*

COLONY® PRO
SINGLE CONTROL KITCHEN FAUCET
WITH PULL-OUT SPRAY

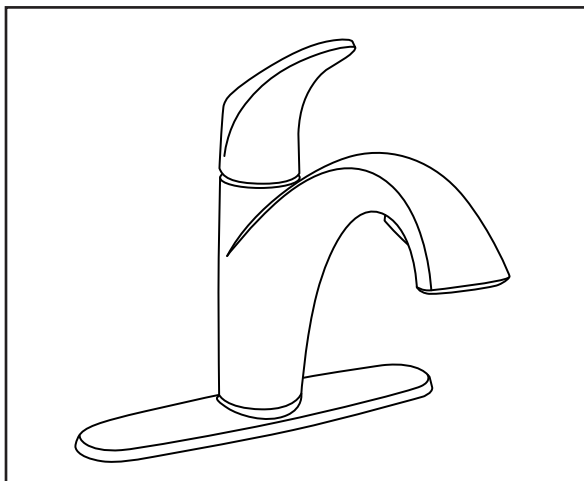

MODEL NUMBER:

✓ **7074.100 Kitchen Faucet with Pull-Out Spray**

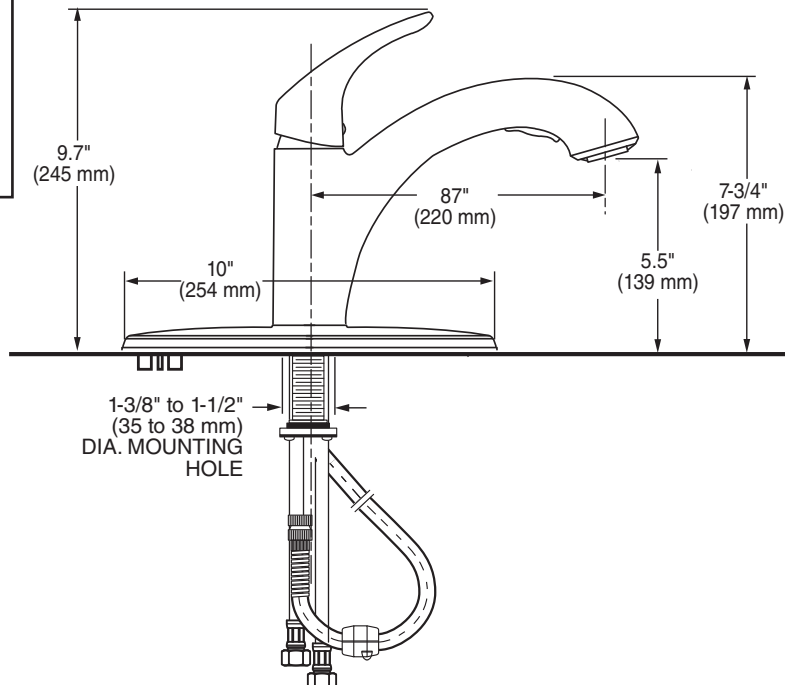

GENERAL DESCRIPTION:

Metal swivel body, handle and deck plate. Pull-out sprayer features 2 spray functions. Nylon pull-out spray hose with 2 integral check valves. Washerless 40 mm ceramic disc valve cartridge with integral hot limit safety stop. 24" Braided flexible stainless steel supply hoses with 3/8" compression connections. Metal mounting shank with brass fixation ring. 1.5 gpm/5.7 L/min. maximum flow rate. Fitting can be mounted with or without supplied metal escutcheon plate.

PRODUCT FEATURES:

Ceramic Disc Valve Cartridge: Assures smooth, precise valve control and a lifetime of drip-free, maintenance-free performance.

Memory Position Valving: Allows user to turn valve on and off at preferred temperature setting without readjusting handle position each time.

Adjustable Hot Limit Safety Stop: Limits the amount of hot water allowed to mix with cold. Reduces the risk of accidental scalding.

Lead Free: Faucet contains $\leq 0.25\%$ total lead content by weighted average.

Integral Check Valves: Prevents back flow.

Pull-out Spray Spout: Switches water flow from a stream to a spray.

SUGGESTED SPECIFICATION

Single control kitchen pull-out faucet shall feature a swivel pull-out sprayer with two check valves, metal escutcheon plate and handle. Shall also feature washerless ceramic disc valve cartridge with integral hot limit safety stop and flexible stainless steel supply hoses. Faucet shall be American Standard Model # 7074.100._____.



COLONY® PRO

SINGLE CONTROL KITCHEN FAUCET WITH PULL-OUT SPRAY

CODES AND STANDARDS

These products meet or exceed the following codes and standards:

ANSI A117.1
ASME A112.18.1
CSA B125.1
NSF 61/Section 9
NSF 372

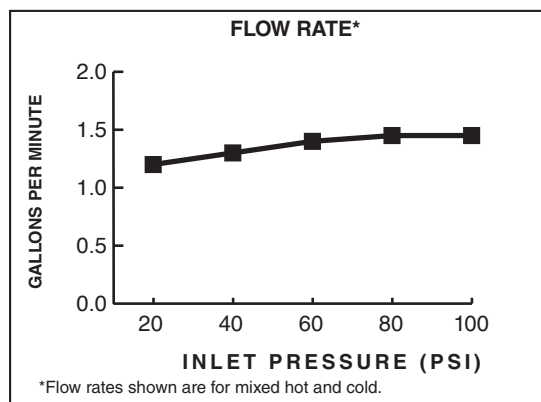

1.5 gpm/5.7 L/min. FLOW RATE

Product Number	Description	Finish Options	
		Polished Chrome	PVD Stainless Steel
		002	075
7074.100	Pull-Out Kitchen Faucet		



Meets the American Disabilities Act Guidelines and **ANSI A117.1** Requirements for the physically challenged.

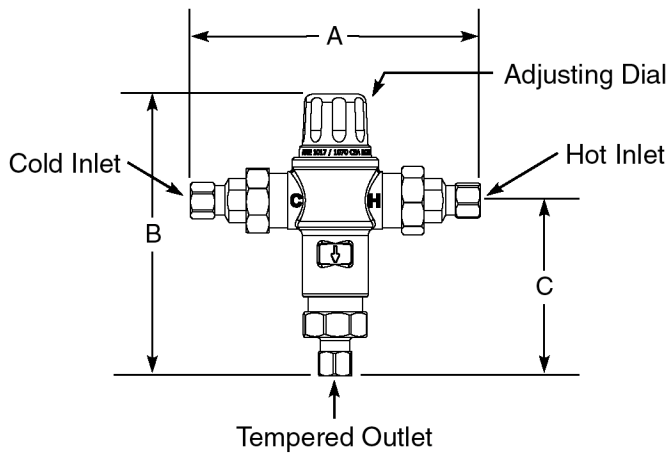

Thermostatic Mixing Valve for Point of Use and Master Controlled Fixtures

Model 570

Unit No. 86820

Inlets & Outlet are $\frac{3}{8}$ " Compression Fit

ASSE 1017 & 1070 Approved

Certified to
CSA B125.3

The mixing valve for point of use master controlled fixtures shall be a nickel plated thermostatic mixing valve. The mixing valve shall be $\frac{3}{8}$ " Compression Fit. The mixing valve shall have a spindle to adjust outlet temperature. The mixing valve shall have internal checks. The mixing valve shall be Lawler model 570.

Specifications

- Outlet temperature range: 95-115°F.
- Temperature, hot supply: 180°F max.
- Temperature, cold supply: 40-80°F.
- Temperature stability (nominal): $\pm 5^\circ\text{F}$.
- Temperature differential (between hot supply and outlet temperature): 10°F.
- Hydrostatic pressure: 125 psi max.
- Permitted supply pressure variation: $\pm 20\%$.
- Flow rate @ 45psi pressure loss: 7 gpm.
- Flow rate, minimum: .5 gpm.
- Flow rate, maximum: 8 gpm.

Benefits

- Protects against scalding and chilling.
- Offers choice of temperature settings from 95° through 115°F.
- Easy installation.
- Backed by Lawler's One Year Warranty.
- ASSE 1017 & 1070 approved.

Engineer Approval ☐**MANUFACTURING CO., INC.**

5330 East 25th Street
Indianapolis, Indiana 46218
Phone (317) 261-1212
Fax (317) 261-1208

DIMENSIONS:

Valve Number	A	B	C
M 570	5.6"	5.4"	3.4"

FLOW CAPACITIES - MODEL 570

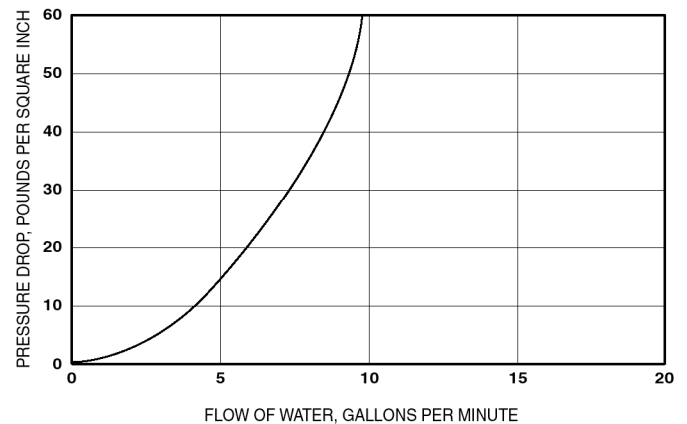

CAPACITIES - MODEL 570

Pressure Drop PSI	5	10	20	40
Valve Number	Capacity			
570-GPM	3	4	5	6.5
570-LPM	11	15	19	25

Temperature Adjustment

To adjust the mixed outlet temperature of the valve, remove the cap to gain access to the adjusting spindle. The spindle should be rotated-clockwise to reduce the temperature, counter-clockwise to increase the temperature until the desired set point is reached.

Note: For ASSE 1017 & 1070 applications.

Design and specification subject to change without notice.



SEMI-CAST P-TRAPS WITH WALL BEND

Z8700-PC TO Z8708-PC

TAG



Engineering Specification: Zurn Z8700-PC to Z8708-PC. – Chrome-plated cast brass (copper alloy) body P-trap with cleanout, tubular brass wall bend as specified, die-cast nuts, and shallow escutcheon with compression inlet.

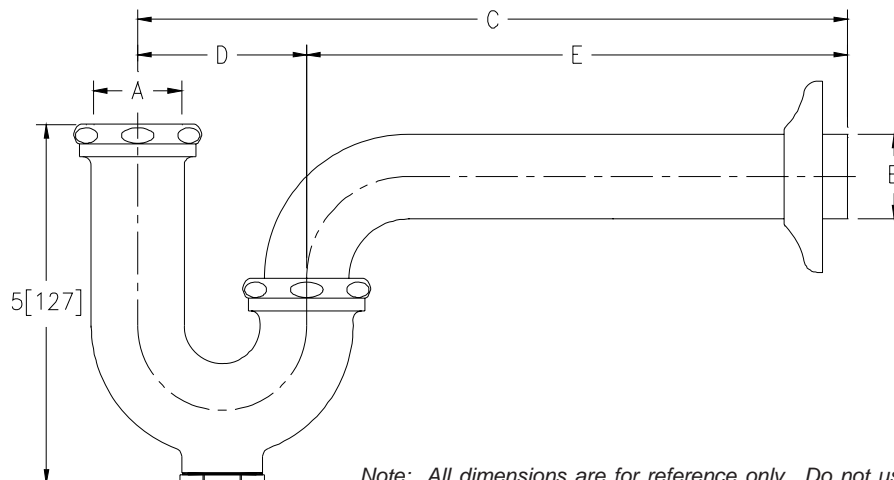

Note: All dimensions are for reference only. Do not use for pre-plumbing.

PRODUCT NUMBER	A INLET in[mm]	B OUTLET in[mm]	GAUGE	DIMENSIONS			MASTER CARTON	WEIGHT CARTON [lbs]
				C in[mm]	D in[mm]	E in[mm]		
Z8700-PC	1 1/4[32]	1 1/4[32]	17	10[254]	2 1/2[64]	7 1/2[191]	12	24
Z8700-8-PC	1 1/4[32]	1 1/4[32]	17	11[279]	2 1/2[64]	8 1/2[216]	12	24
Z8700-15-PC	1 1/4[32]	1 1/4[32]	17	15[381]	2 1/2[64]	12 1/2[318]	18	40
Z8701-PC	1 1/4[32]	1 1/2[38]	17	10 1/2[267]	3[76]	7 1/2[191]	12	24
Z8701-9-PC	1 1/4[32]	1 1/2[38]	17	12[305]	3[76]	9[229]	12	24
Z8701-15-PC	1 1/4[32]	1 1/2[38]	17	15[381]	3[76]	12[305]	18	42
Z8702-PC*	1 1/2[38]	1 1/2[38]	17	10 1/2[267]	3[76]	7 1/2[191]	12	24
✓ Z8702-9-PC*	1 1/2[38]	1 1/2[38]	17	12[305]	3[76]	9[229]	12	24
Z8702-15-PC*	1 1/2[38]	1 1/2[38]	17	15[381]	3[76]	12[305]	18	42
Z8703B-PC**	1 1/2[38]	2[51]	17	12 1/2[318]	3 1/2[89]	9[229]	6	18
Z8704B-PC**	2[51]	2[51]	17	12 1/2[318]	3 1/2[89]	9[229]	6	18
Z8706-PC	1 1/4[32]	1 1/4[32]	20	10[254]	2 1/2[64]	7 1/2[191]	12	24
Z8707-PC	1 1/4[32]	1 1/2[38]	20	10 1/2[267]	3[76]	7 1/2[191]	12	24
Z8708-PC*	1 1/2[38]	1 1/2[38]	20	10 1/2[267]	3[76]	7 1/2[191]	12	24

OPTIONAL ACCESSORIES

Suffix	Description
✓ -B	Brass Nuts
-BX	Box Escutcheon
-CE	Cast Brass Escutcheon with Setscrew
✓ -D	Deep Escutcheon (Note = not available for Z8703B-PC and Z8704B-PC)
-J	Metal to Metal Ground Joint Connection
-WC	Waste Connections - Compression
-15	15[381] C Dim. 1 1/4[32] and 1 1/2[38] Only
-18	18[457] C Dim. 1 1/4[32] and 1 1/2[38] Only

* COMES WITH OPTIONAL 1-1/2" x 1-1/4" REDUCTION POLY-WASHER FOR INLET

** SHIPPED WITH BRASS NUTS UNLESS OTHERWISE SPECIFIED

ZURN INDUSTRIES, LLC ♦ COMMERCIAL BRASS OPERATION ♦ 2640 SOUTH WORK STREET ♦ FALCONER NY 14733

Phone: 1-800-997-3876 ♦ Fax: 1-919-775-3541 ♦ www.zurn.com

In Canada: ZURN INDUSTRIES LIMITED ♦ 3544 Nashua Drive ♦ Mississauga, Ontario L4V1L2 ♦ Phone: 905/405-8272 Fax: 905/405-1292

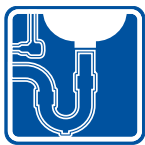

LAV GUARD²
FAST FIT UNDERSINK PIPING COVERS

All New
E-Z Series

ADA-compliant undersink protection



Submittal Sheet

General Description:

LAV GUARD[®] 2 E-Z Series waste and supply piping covers satisfy ADA compliance requirements. Built-in *E-Z Grip* internal fasteners and internal, *E-Z Tear-To-Fit* trimming feature allow for fast installation without tools. *Series #100 E-Z* kits are designed to fit on all tubular and cast brass P-trap assemblies. *Series #400* kits are the "original" LAV GUARD design and fit schedule 40 ABS and PVC P-trap assemblies — regardless of their geometry or rotational offset. Valve cover completely encloses angle valve and supply tube for both handled and keyed type water stops.

Material	Molded vinyl
Nominal Wall	1/8" constant
Durometer	70 - 80 - Shore A
UV Protection	Will not fade or discolor
Durability	Virtually indestructible
Trimming (E-Z Series)	Internal, <i>E-Z Tear-To-Fit</i> trim feature
Fasteners (E-Z Series)	Internal <i>E-Z Grip</i> fasteners (reusable)
Color	China white
Paintability	Apply Latex paint
Burning Characteristics ASTM D-635	Self extinguished 0 sec (ATB) 0 mm (AEB)
Bacteria/Fungus Resistance	ASTM G21 and G22/ Result: 0 growth
Maintenance	Use common detergents

Manufactured under one or more of the following U.S. or Canadian patents.
Other patents pending.
5,303,730 5,360,031 5,524,669 5,564,463 5,678,598 5,699,828 5,915,412
5,915,413 5,901,739 5,960,820 2,075,324 2,119,427 2,136,027 2,158,083



IPS Corporation, 202 Industrial Park Lane, Collierville, TN 38017
(901) 853-5001 (800) 340-5969 FAX: (901) 853-5008
e-mail: info@truebro.com Internet: http://www.truebro.com

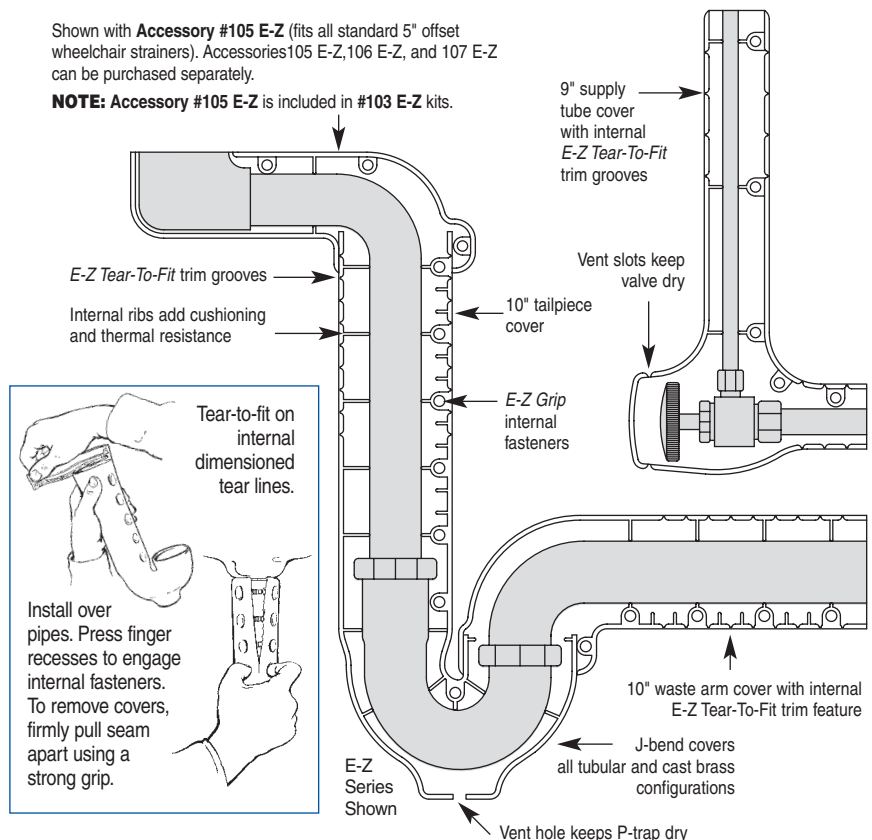

#100 E-Z Series (shown above right) for tubular and cast brass P-trap assemblies.
#400W* Series (original design) for schedule 40 P-trap assemblies.

- ☐ **Model #99 E-Z**
One angle valve and supply cover
- ☐ **Model #100 E-Z**
One P-trap cover
- ☐ **Model #400W***
One P-trap cover
- ☐ **Model #101 E-Z**
One P-trap cover, one angle valve cover
- ☐ **Model #401W***
One P-trap cover, one angle valve cover

- ☒ **Model #102 E-Z**
One P-trap cover, two angle valves and covers
- ☐ **Model #402W***
One P-trap cover, two angle valves and covers
- ☐ **Model #103 E-Z**
One P-trap cover, two angle valves and supply covers, one 5" offset tailpiece wheelchair strainer cover
- ☐ **Accessory #105 E-Z**
One 5" offset tailpiece wheelchair strainer assembly

- ☐ **Accessory #105-K**
Kohler 6" offset
- ☐ **Accessory #106 E-Z**
One basket strainer cover and offset waste cover (adjustable to 18")
- ☐ **Accessory #107 E-Z**
Two basket strainer covers and center or end outlet waste cover (adjustable)
- ☐ **Accessory #Ex99 E-Z**
One 16" extension for water supply
- ☐ **Accessory #Ex100 E-Z**
One 16" extension for drain waste arm or tailpiece

*All #400W series items are the "original" LAV GUARD[®] design and construction. Specifications may change without notice.

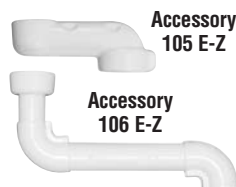

Job/Location _____
Designer _____

TRUEBRO reserves the right to make product and material changes at any time without notice.

2 / 07